

Soils Map

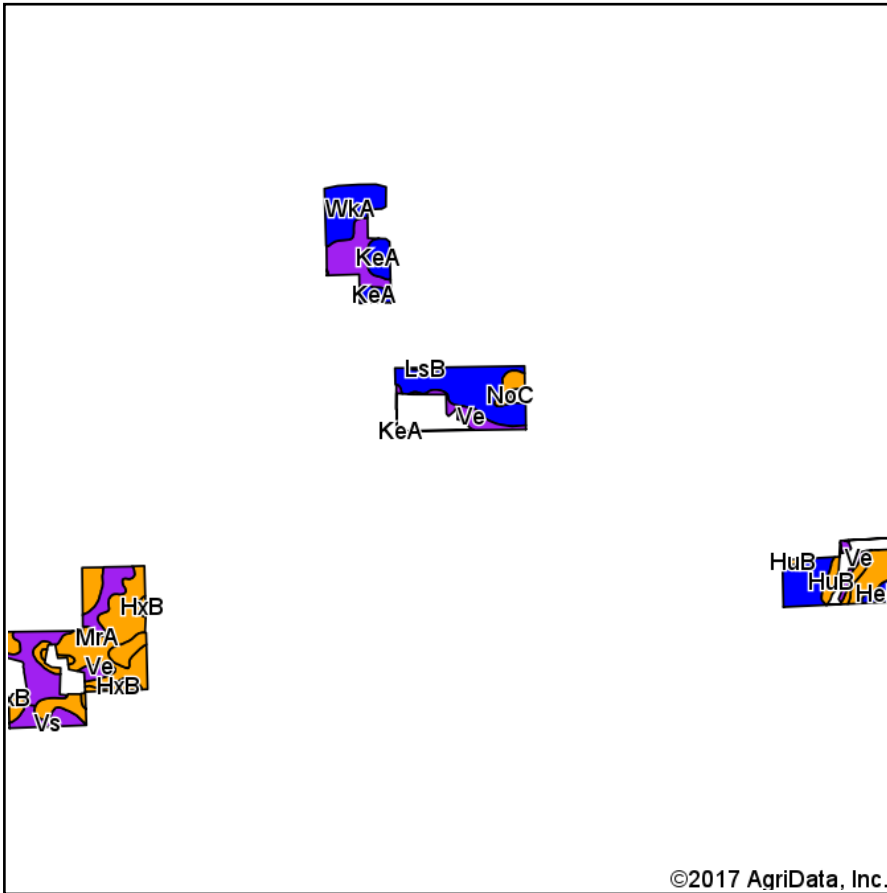

Soils data provided by USDA and NRCS.

©2017 AgriData, Inc.

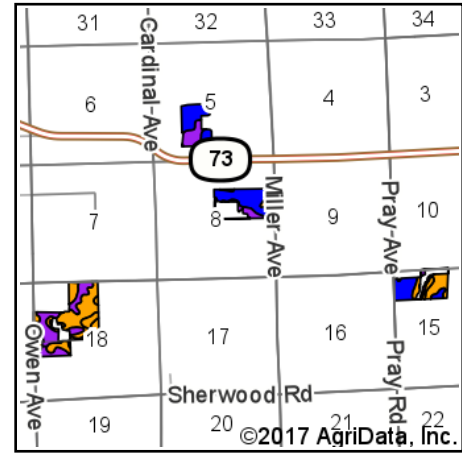

State: **Wisconsin**
 County: **Clark**
 Location: **8-23N-1W**
 Township: **Washburn**
 Acres: **304.1**
 Date: **7/10/2017**



© AgriData, Inc. 2017 www.AgriDataInc.com



Area Symbol: WI019, Soil Area Version: 14

Code	Soil Description	Acres	Percent of field	Non-Irr Class Legend	Water Table	Soil Drainage	Non-Irr Class *c	Alfalfa hay	Corn	Corn silage	Oats	Soybeans	Winter wheat
KeA	Kert silt loam, 0 to 3 percent slopes	75.66	24.9%		1.5ft.	Somewhat poorly drained	IIw	3.5	75	12	65	25	29
MrA	Merrillan-Veedum complex, 0 to 3 percent slopes	73.47	24.2%		2ft.	Somewhat poorly drained	IIIw	3	65	10	60	21	27
Ve	Veedum muck, 0 to 2 percent slopes	70.03	23.0%		0ft.	Very poorly drained	VIw						
WkA	Withee-Kert silt loams, 0 to 3 percent slopes	24.75	8.1%		2.5ft.	Somewhat poorly drained	IIw	3.5	75	12	65	25	29
MpA	Merrillan fine sandy loam, 0 to 3 percent slopes	16.44	5.4%		1ft.	Somewhat poorly drained	IIIw	3	65	10	60	21	27
HuB	Humbird fine sandy loam, 1 to 6 percent slopes	15.56	5.1%		2ft.	Moderately well drained	IIIe	2.1	55	9	45	18	29
HxB	Humbird-Merrillan fine sandy loams, 0 to 6 percent slopes	12.17	4.0%		2ft.	Somewhat poorly drained	IIIe	2.5	55	9	65	18	29
Vs	Veedum-Elm Lake mucks, 0 to 2 percent slopes	9.89	3.3%		0ft.	Very poorly drained	VIw						
HeB	Hiles silt loam, 1 to 6 percent slopes	3.72	1.2%		2ft.	Moderately well drained	Ile	4	85	14	70	28	32
Da	Dawsil mucky peat, frequently ponded, 0 to 1 percent slopes	1.57	0.5%		0ft.	Very poorly drained	VIIw						
LsB	Loyal-Hiles silt loams, 1 to 6 percent slopes	0.84	0.3%		2.5ft.	Moderately well drained	Ile	4	85	14	70	28	32
Weighted Average								2.3	50.3	7.9	45.2	16.5	20.7

*c: Using Capabilities Class Dominant Condition Aggregation Method

Soils data provided by USDA and NRCS.