

# Soils Map

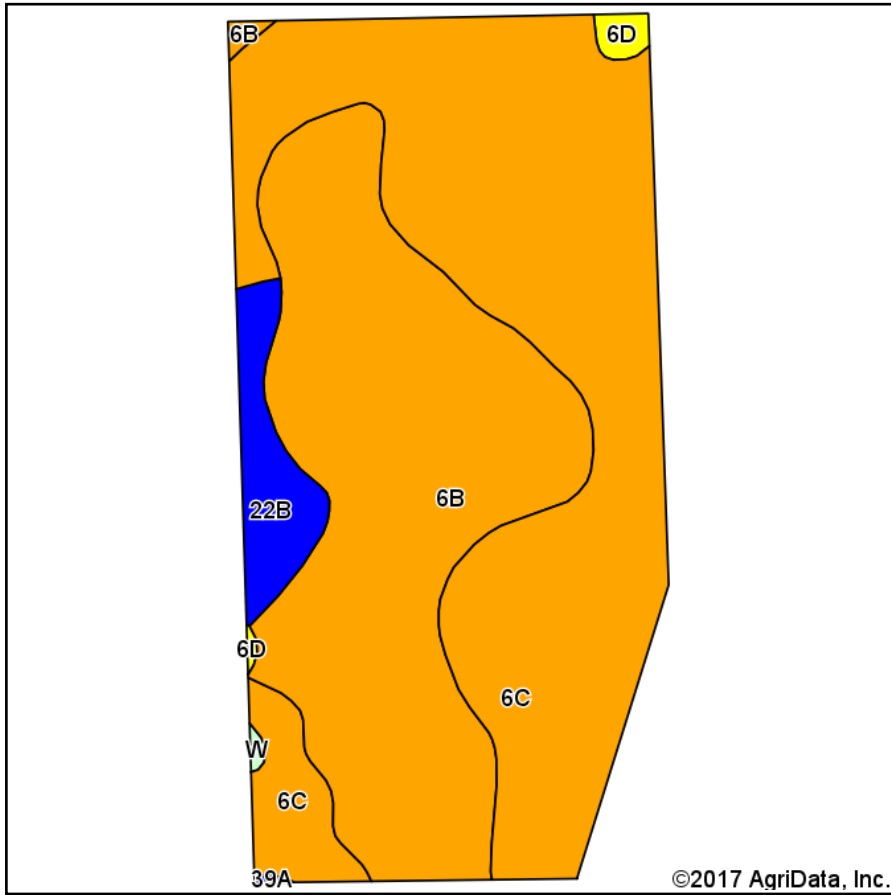

Soils data provided by USDA and NRCS.

©2017 AgriData, Inc.

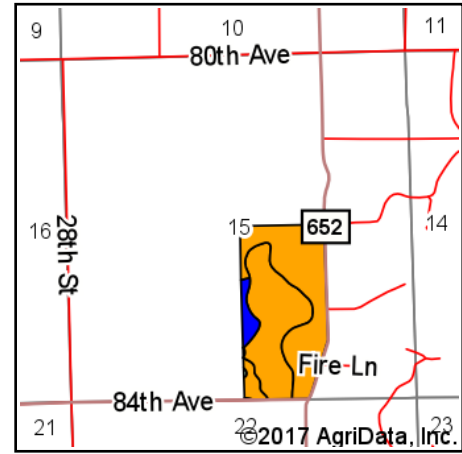

State: **Michigan**  
 County: **Van Buren**  
 Location: **15-4S-13W**  
 Township: **Porter**  
 Acres: **76.82**  
 Date: **2/5/2017**



Maps Provided By:



© AgriData, Inc. 2017

www.AgriDataInc.com



## Archived Soils Ending 1/21/2012

Code	Soil Description	Acres	Percent of field	Non-Irr Class Legend	Water Table	Restrictive Layer	Soil Drainage	Non-Irr Class *c	Irr Class *c	Corn	Corn Irrigated	Soybeans	Soybeans Irrigated	Winter wheat
6C	Oshtemo sandy loam, 6 to 12 percent slopes	40.35	52.5%		> 6.5ft.	> 6.5ft.	Well drained	IIIe	IIIe	90	165	26	50	40
6B	Oshtemo sandy loam, 0 to 6 percent slopes	32.28	42.0%		> 6.5ft.	> 6.5ft.	Well drained	IIIs	IIIe	95	175	30	57	45
22B	Kalamazoo loam, 2 to 6 percent slopes	3.51	4.6%		> 6.5ft.	> 6.5ft.	Well drained	Ile	Ile	95	175	30	55	40
6D	Oshtemo-Coloma loamy sands, 12 to 18 percent slopes	0.57	0.7%		> 6.5ft.	> 6.5ft.	Well drained	IVe		80		21		35
W	Water	0.11	0.1%		> 6.5ft.	> 6.5ft.								
<b>Weighted Average</b>										<b>92.1</b>	<b>168.2</b>	<b>27.8</b>	<b>52.7</b>	<b>42</b>

\*c: Using Capabilities Class Dominant Condition Aggregation Method

Soils data provided by USDA and NRCS.