

# Soils Map

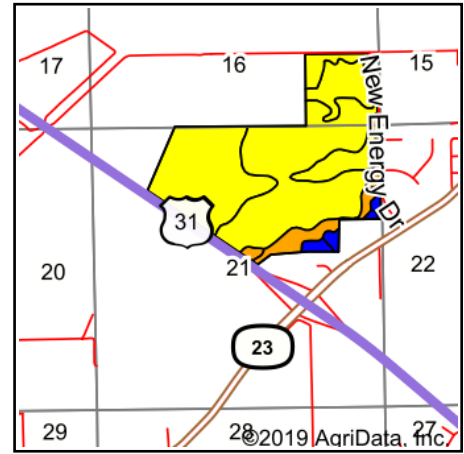

State: **Indiana**  
 County: **St Joseph**  
 Location: **21-37N-2E**  
 Township: **Portage**  
 Acres: **230.97**  
 Date: **4/30/2020**

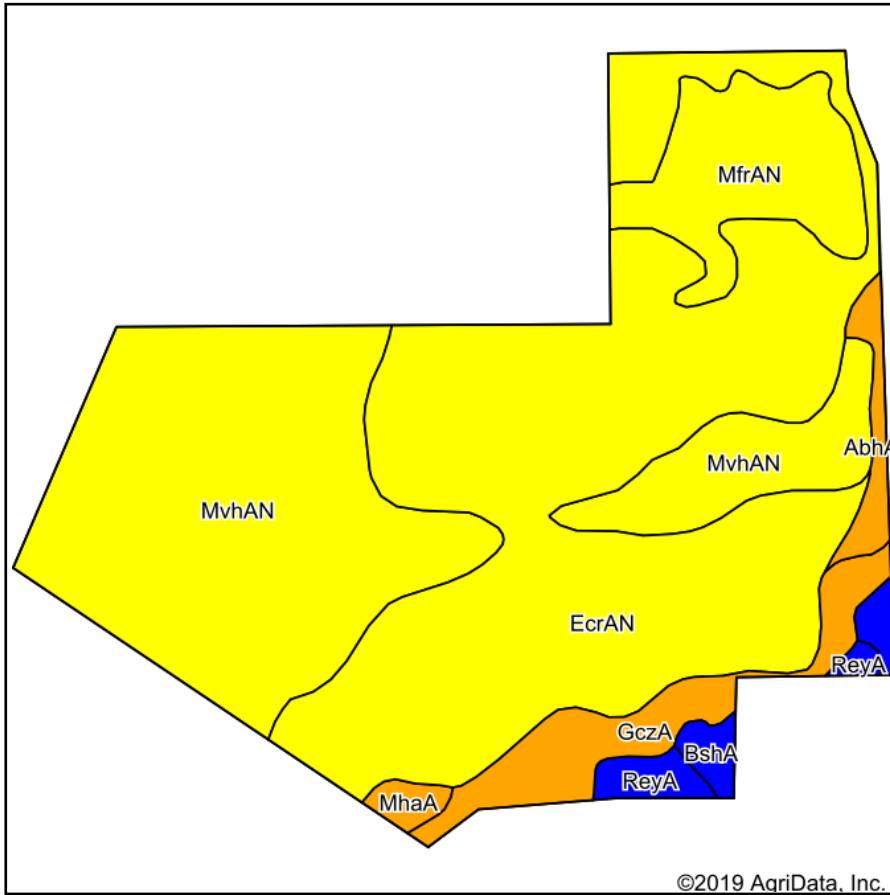

Soils data provided by USDA and NRCS.

Area Symbol: IN141, Soil Area Version: 23											
Code	Soil Description	Acres	Percent of field	Non-Irr Class Legend	Water Table	Non-Irr Class *c	Corn	Soybeans	Winter wheat	*n NCCPI Overall	*n NCCPI Soybeans
EcrAN	Edselton muck, drained, 0 to 1 percent slopes	109.91	47.6%		0ft.	IVw	136	35	54	84	84
MvhAN	Moston muck, drained, 0 to 1 percent slopes	78.51	34.0%		0ft.	IVw	136	35	54	90	90
MfrAN	Madaus muck, drained, 0 to 1 percent slopes	18.60	8.1%		0.7ft.	IVw	139	33	56	50	50
GczA	Gilford sandy loam, 0 to 2 percent slopes, gravelly subsoil	12.49	5.4%		0ft.	IIIw	147	41	59	71	51
AbhAN	Adrian muck, drained, 0 to 1 percent slopes	3.50	1.5%		0.7ft.	IIIw	144	40	58	89	89
ReyA	Rensselaer loam, 0 to 1 percent slopes	3.16	1.4%		0ft.	IIw	172	48	69	80	79
BshA	Brady sandy loam, 0 to 1 percent slopes	3.14	1.4%		1ft.	IIw	124	35	55	67	48
MhaA	Maumee loamy fine sand, 0 to 1 percent slopes	1.66	0.7%		0.2ft.	IIIw	134	47	54	54	34
<b>Weighted Average</b>							<b>137.3</b>	<b>35.5</b>	<b>54.7</b>	<b>*n 82.2</b>	<b>*n 80.7</b>

\*n: The aggregation method is "Weighted Average using major components"

\*c: Using Capabilities Class Dominant Condition Aggregation Method

Soils data provided by USDA and NRCS.

# Soils Map

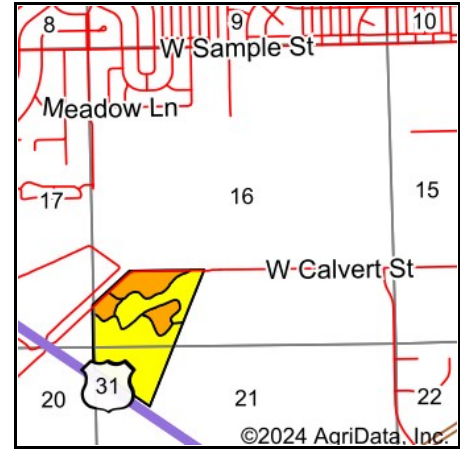
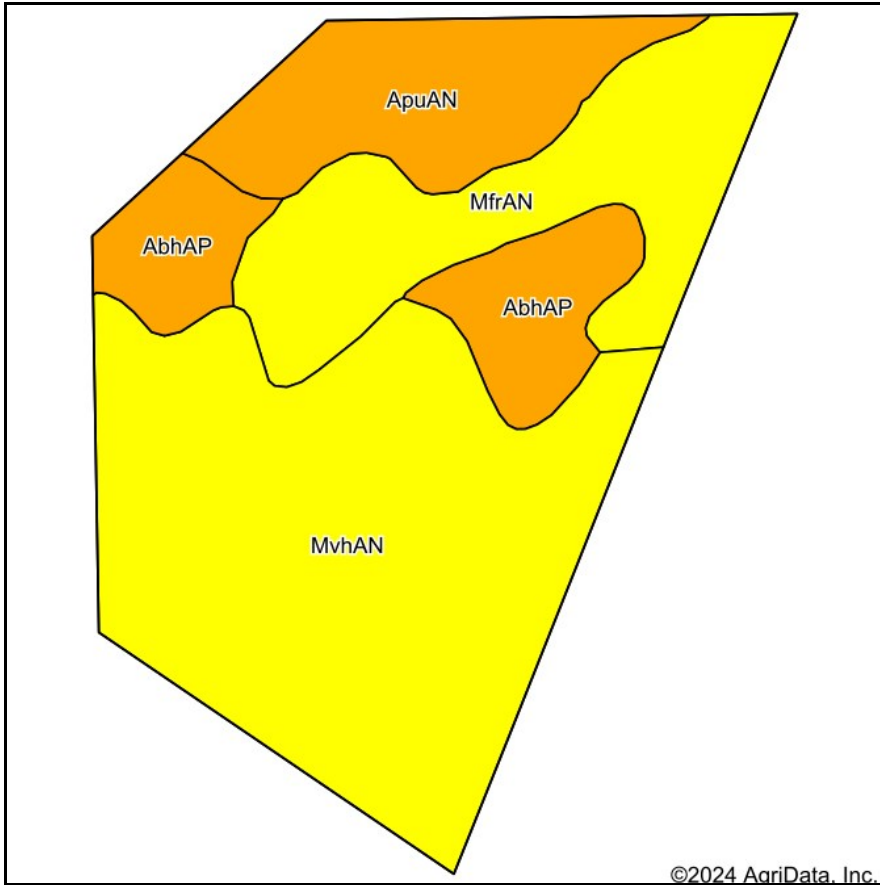

State: **Indiana**  
 County: **St. Joseph**  
 Location: **16-37N-2E**  
 Township: **Portage**  
 Acres: **70.19**  
 Date: **2/29/2024**



Maps Provided By:



Soils data provided by USDA and NRCS.

©2024 AgriData, Inc.

© AgriData, Inc. 2023

www.AgriDataInc.com

Area Symbol: IN141, Soil Area Version: 27

Code	Soil Description	Acres	Percent of field	Non-Irr Class Legend	Water Table	Non-Irr Class *c	Corn Bu	Soybeans Bu	Winter wheat Bu	*n NCCPI Corn	*n NCCPI Soybeans
MvhAN	Moston muck, drained, 0 to 1 percent slopes	36.47	52.0%		0ft.	IVw	136	35	54	86	91
MfrAN	Madaus muck, drained, 0 to 1 percent slopes	14.92	21.3%		0ft.	IVw	139	33	56	60	70
ApuAN	Antung muck, drained, 0 to 1 percent slopes	10.12	14.4%		0.2ft.	IIIw	144	35	58	67	65
AbhAP	Adrian muck, drained, prairie peninsula, 0 to 1 percent slopes	8.68	12.4%		0ft.	IIIw	144	40	58	81	86
<b>Weighted Average</b>						<b>3.73</b>	<b>138.8</b>	<b>35.2</b>	<b>55.5</b>	<b>*n 77.1</b>	<b>*n 82.2</b>

Soils data provided by USDA and NRCS. The aggregation method is "Weighted Average using all components"

\*c: Using Capabilities Class Dominant Condition Aggregation Method