

# Soils Map

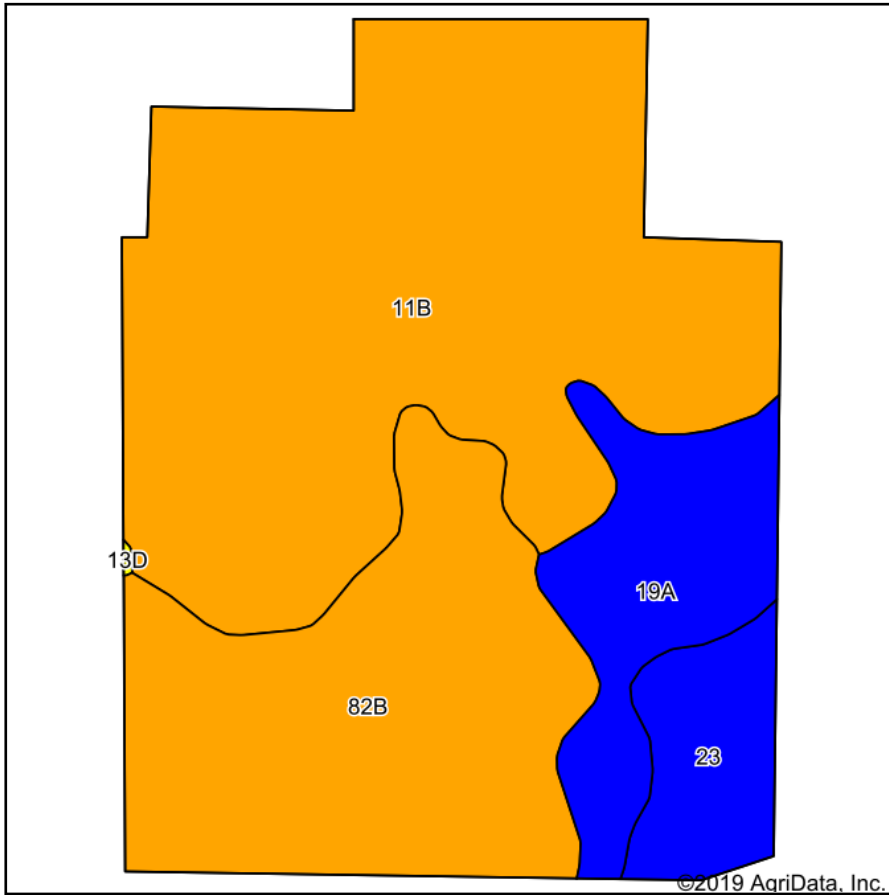

Soils data provided by USDA and NRCS.

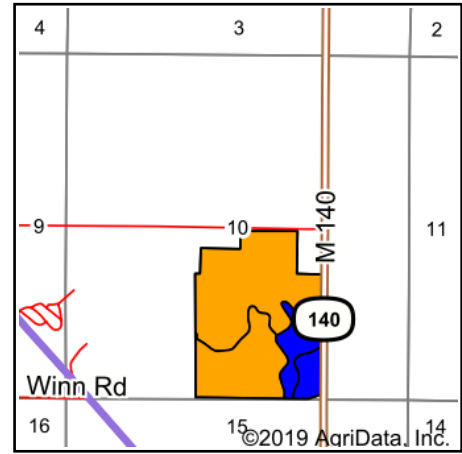

State: **Michigan**  
 County: **Berrien**  
 Location: **10-7S-17W**  
 Township: **Niles**  
 Acres: **104.74**  
 Date: **2/19/2020**



## Archived Soils Ending 1/21/2012

Code	Soil Description	Acres	Percent of field	Non-Irr Class Legend	Non-Irr Class *c	Irr Class *c	Alfalfa hay	Alfalfa hay Irrigated	Corn	Corn Irrigated	Corn silage	Corn silage Irrigated	Oats	Soybeans	Soybeans Irrigated	Winter wheat
11B	Oshtemo sandy loam, 0 to 6 percent slopes	56.26	53.7%		III s	III e	3.5	8	95	175	10	27	80	30	57	45
82B	Oshtemo-Ockley complex, 0 to 4 percent slopes	29.64	28.3%		III s	III e	3.5	8	95	175	10	27	80	30	57	45
19A	Brady sandy loam, 0 to 2 percent slopes	12.24	11.7%		II w		4.5		115		19		95	33		50
23	Sebewa loam	6.60	6.3%		II w		4.8		115		19		95	36		55
<b>Weighted Average</b>							<b>3.7</b>	<b>6.6</b>	<b>98.6</b>	<b>143.5</b>	<b>11.6</b>	<b>22.1</b>	<b>82.7</b>	<b>30.7</b>	<b>46.7</b>	<b>46.2</b>

\*c: Using Capabilities Class Dominant Condition Aggregation Method  
 Soils data provided by USDA and NRCS.

# Soils Map

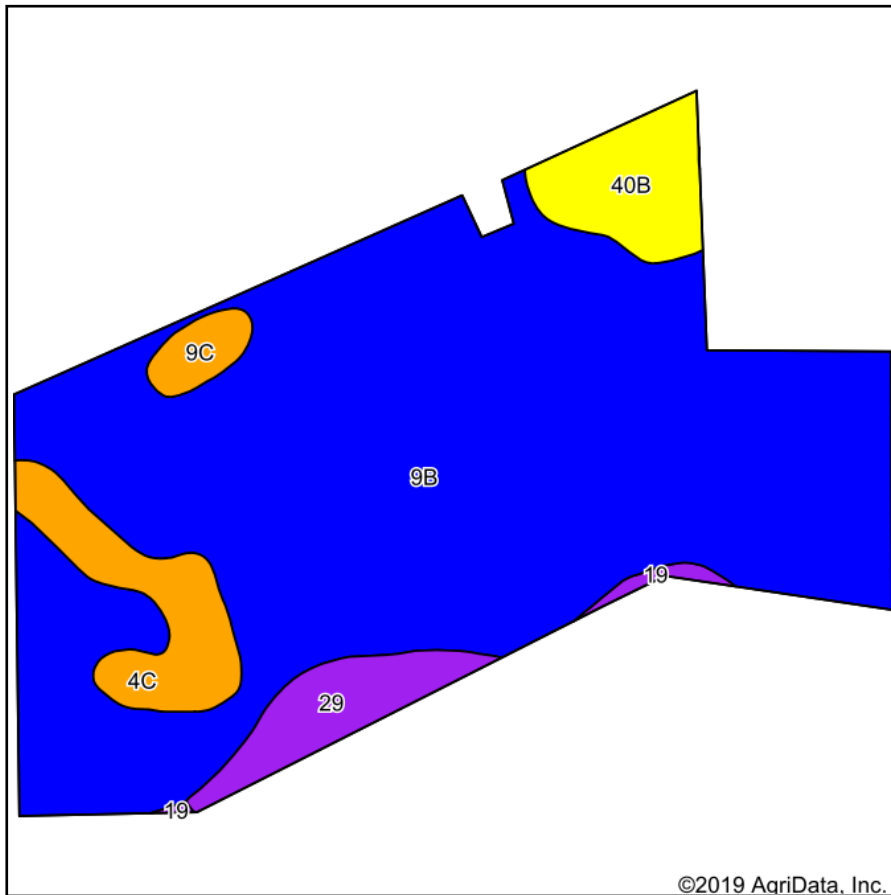

Soils data provided by USDA and NRCS.

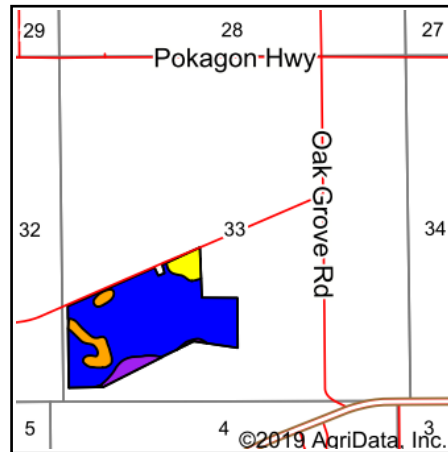

State: **Michigan**  
 County: **Cass**  
 Location: **33-6S-15W**  
 Township: **La Grange**  
 Acres: **74.4**  
 Date: **2/19/2020**

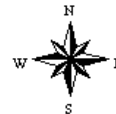

## Archived Soils Ending 1/21/2012

Code	Soil Description	Acres	Percent of field	Non-Irr Class Legend	Non-Irr Class *c	Irr Class *c	Alfalfa hay	Alfalfa hay Irrigated	Corn	Corn Irrigated	Corn silage	Corn silage Irrigated	Oats	Soybeans	Soybeans Irrigated	Winter wheat
9B	Kalamazoo loam, 2 to 6 percent slopes	61.30	82.4%		Ile	Ile	4		100	175	17	27	80	30	55	40
4C	Oshtemo sandy loam, 6 to 12 percent slopes	4.43	6.0%		IIIe	IIIe	3.5	7	90	165	15	25	75	26	50	40
40B	Coloma loamy sand, 0 to 6 percent slopes	3.85	5.2%		IVs	IIIe			45	170	7		45	18	55	
29	Palms muck	3.25	4.4%		Vw											
9C	Kalamazoo loam, 6 to 12 percent slopes	1.15	1.5%		IIIe		3.8		85		16		75	27		38
19	Houghton muck	0.42	0.6%		Vw											
<b>Weighted Average</b>							<b>3.6</b>	<b>0.4</b>	<b>91.4</b>	<b>162.8</b>	<b>15.5</b>	<b>23.7</b>	<b>73.9</b>	<b>27.6</b>	<b>51.1</b>	<b>35.9</b>

\*c: Using Capabilities Class Dominant Condition Aggregation Method  
 Soils data provided by USDA and NRCS.