

Soils Map

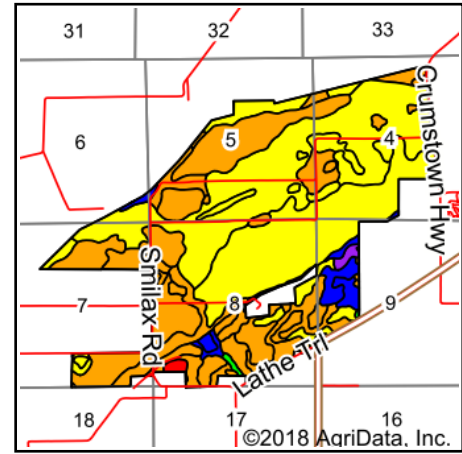

State: **Indiana**
 County: **St Joseph**
 Location: **8-36N-1E**
 Township: **Greene**
 Acres: **1578.09**
 Date: **7/26/2018**

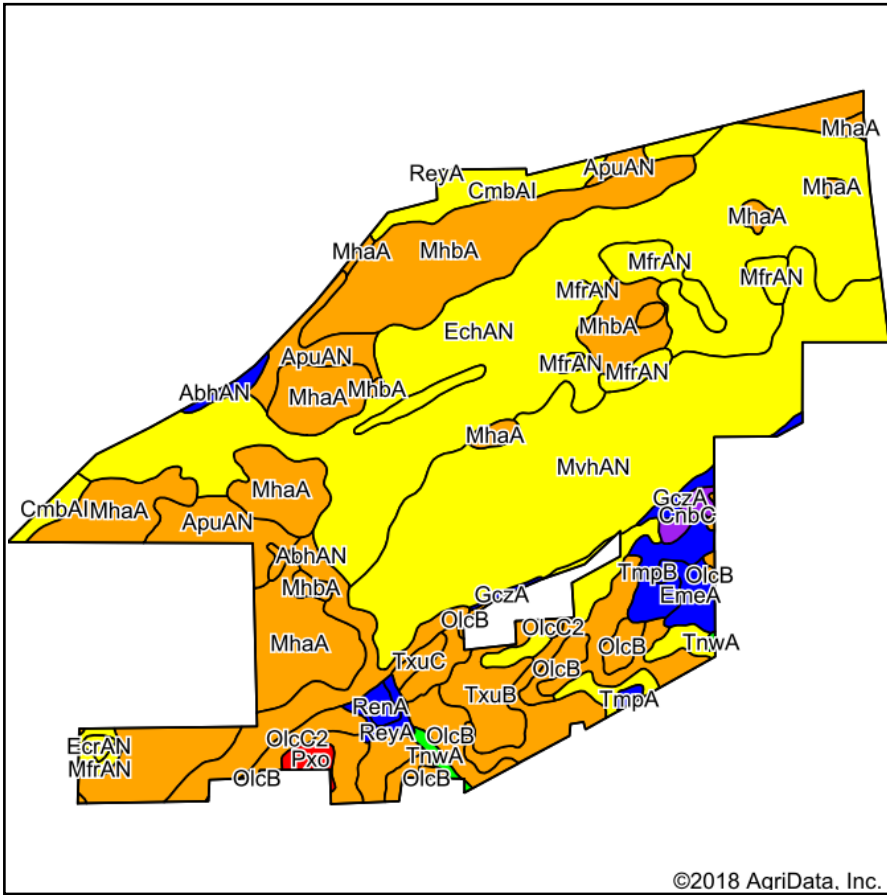

Soils data provided by USDA and NRCS.

©2018 AgriData, Inc.

Archived Soils Ending 1/21/2012

Code	Soil Description	Acres	Percent of field	Non-Irr Class Legend	Water Table	Restrictive Layer	Soil Drainage	Non-Irr Class *c	Corn	Soybeans	Winter wheat
EchAN	Edwards muck, drained, 0 to 1 percent slopes	433.78	27.5%		0.7ft.	> 6.5ft.	Very poorly drained	IVw	138	36	55
MvhAN	Moston muck, drained, 0 to 1 percent slopes	310.04	19.6%		0ft.	> 6.5ft.	Very poorly drained	IVw	136	35	54
MhaA	Maumee loamy fine sand, 0 to 1 percent slopes	193.07	12.2%		0.2ft.	> 6.5ft.	Poorly drained	IIIw	133	28	54
MhbA	Maumee mucky loamy fine sand, 0 to 1 percent slopes	139.78	8.9%		0.2ft.	> 6.5ft.	Very poorly drained	IIIw	136	28	54
OicA	Oshtemo sandy loam, 0 to 1 percent slopes	72.89	4.6%		> 6.5ft.	4.9ft. (Strongly contrasting textural stratification)	Well drained	IIIs	109	38	53.9
ApuAN	Antung muck, drained, 0 to 1 percent slopes	66.92	4.2%		0.2ft.	> 6.5ft.	Very poorly drained	IIIw	145	37	59
AbhAN	Adrian muck, drained, 0 to 1 percent slopes	50.80	3.2%		0.7ft.	> 6.5ft.	Very poorly drained	IIIw	146	40	59
OicB	Oshtemo sandy loam, 1 to 5 percent slopes	46.23	2.9%		> 6.5ft.	4.9ft. (Strongly contrasting textural stratification)	Well drained	IIIs	106	37	52.4
CmbAl	Cohoctah loam, 0 to 1 percent slopes, frequently flooded, brief duration	42.18	2.7%		0.2ft.	> 6.5ft.	Poorly drained	IVw	118	25	4
MfrAN	Madaus muck, drained, 0 to 1 percent slopes	40.55	2.6%		0.7ft.	> 6.5ft.	Very poorly drained	IVw	140	34	57
TxuB	Tyner loamy sand, 1 to 5 percent slopes	28.70	1.8%		> 6.5ft.	> 6.5ft.	Excessively drained	IIIs	80	28	36.2
OicC2	Oshtemo sandy loam, 5 to 10 percent slopes, eroded	23.99	1.5%		> 6.5ft.	4.9ft. (Strongly contrasting textural stratification)	Well drained	IIIe	96	34	47.5
CnbB	Coloma sand, 2 to 5 percent slopes	20.76	1.3%		> 6.5ft.	> 6.5ft.	Somewhat excessively drained	IVs	84	30	37.8

TmpB	Tracy sandy loam, 1 to 5 percent slopes	20.41	1.3%		> 6.5ft.	> 6.5ft.	Well drained	Ile	105	37	53
EmeA	Elston sandy loam, 0 to 1 percent slopes	13.24	0.8%		> 6.5ft.	5.9ft. (Strongly contrasting textural stratification)	Well drained	Ils	120	39	59.8
OlcD	Oshtemo sandy loam, 10 to 18 percent slopes	13.21	0.8%		> 6.5ft.	4.9ft. (Strongly contrasting textural stratification)	Well drained	IVe	81	29	40.4
GczA	Gilford sandy loam, 0 to 1 percent slopes	12.30	0.8%		0.2ft.	> 6.5ft.	Poorly drained	Ilw	150	33	60
AatAN	Ackerman muck, drained, 0 to 1 percent slopes	8.07	0.5%		0.2ft.	> 6.5ft.	Very poorly drained	IVw	144	35	58
CnbC	Coloma sand, 5 to 10 percent slopes	7.20	0.5%		> 6.5ft.	> 6.5ft.	Somewhat excessively drained	VIIs	74	26	33.5
ReyA	Rensselaer loam, 0 to 1 percent slopes	6.33	0.4%		0ft.	> 6.5ft.	Poorly drained	Ilw	172	48	69
Pxo	Psamments	6.19	0.4%		> 6.5ft.	> 6.5ft.	Excessively drained	VIII			
RenA	Rensselaer mucky loam, 0 to 1 percent slopes	5.24	0.3%		0ft.	> 6.5ft.	Poorly drained	Ilw	172	48	68.8
TxuC	Tyner loamy sand, 5 to 10 percent slopes	5.10	0.3%		> 6.5ft.	> 6.5ft.	Excessively drained	IIIe	71	25	32.4
TnwA	Troxel silt loam, 0 to 1 percent slopes	4.33	0.3%		> 6.5ft.	> 6.5ft.	Well drained	Is	150	48	75.1
EcrAN	Edselton muck, drained, 0 to 1 percent slopes	2.56	0.2%		0ft.	> 6.5ft.	Very poorly drained	IVw	138	36	56
MvkA	Morocco loamy sand, 0 to 1 percent slopes	2.20	0.1%		1ft.	> 6.5ft.	Somewhat poorly drained	IIIs	100	28	45
TmpA	Tracy sandy loam, 0 to 1 percent slopes	2.02	0.1%		> 6.5ft.	> 6.5ft.	Well drained	Ils	105	37	53
Weighted Average									130.4	33.6	52.5

*c: Using Capabilities Class Dominant Condition Aggregation Method

Soils data provided by USDA and NRCS.

Soils Map

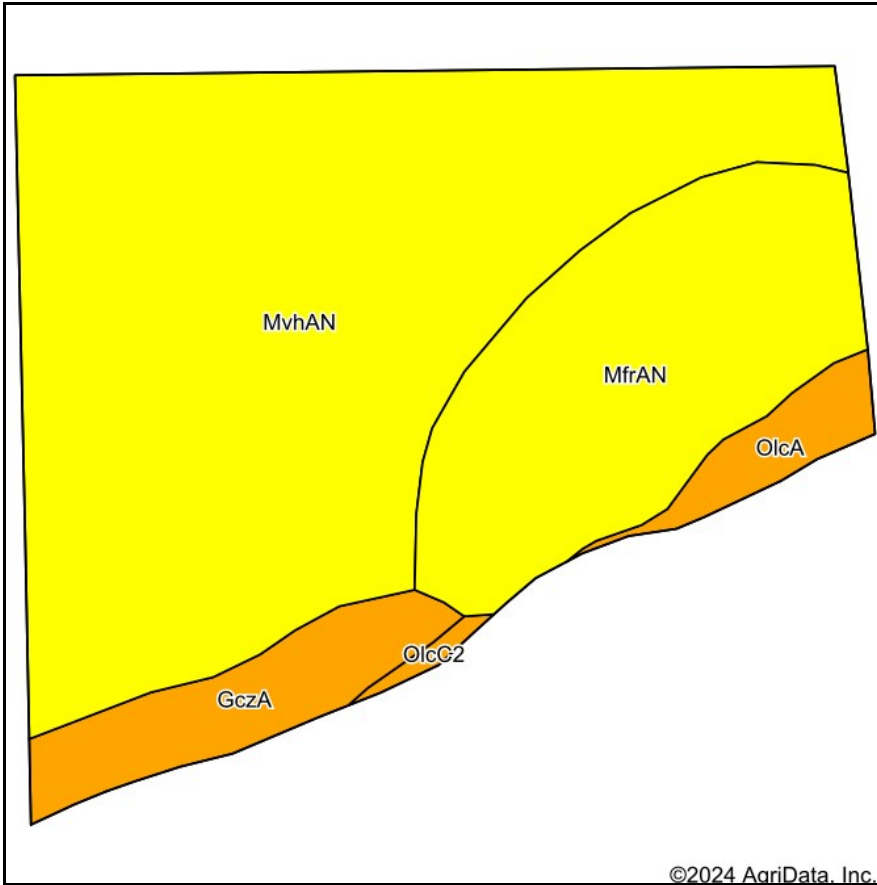

Soils data provided by USDA and NRCS.

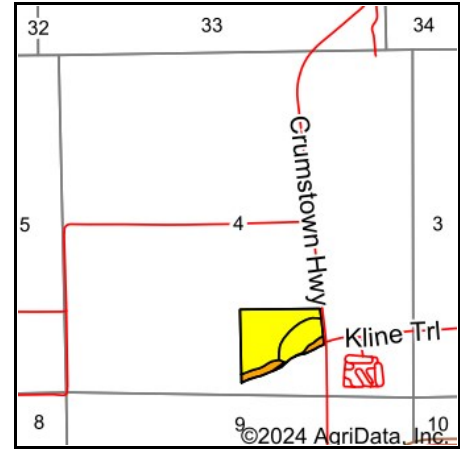

State: **Indiana**
 County: **St. Joseph**
 Location: **4-36N-1E**
 Township: **Greene**
 Acres: **24.29**
 Date: **2/29/2024**



Maps Provided By:



Area Symbol: IN141, Soil Area Version: 27

Code	Soil Description	Acres	Percent of field	Non-Irr Class Legend	Water Table	Non-Irr Class *c	Irr Class *c	Corn Bu	Soybeans Bu	Winter wheat Bu	*n NCCPI Corn	*n NCCPI Soybeans
MvhAN	Moston muck, drained, 0 to 1 percent slopes	15.71	64.7%		0ft.	IVw		136	35	54	86	91
MfrAN	Madaus muck, drained, 0 to 1 percent slopes	5.89	24.2%		0ft.	IVw		139	33	56	60	70
Gcza	Gilford sandy loam, 0 to 2 percent slopes, gravelly subsoil	1.78	7.3%		0ft.	IIIw		147	41	59	71	51
OlcA	Oshtemo sandy loam, 0 to 2 percent slopes	0.78	3.2%		> 6.5ft.	III s	III s				66	43
OlcC2	Oshtemo sandy loam, 5 to 10 percent slopes, eroded	0.13	0.5%		> 6.5ft.	III e		96	34	47	60	39
Weighted Average						3.89	*-	133	33.8	53.1	*n 77.8	*n 81.2

Soils data provided by USDA and NRCS. The aggregation method is "Weighted Average using all components"

*c: Using Capabilities Class Dominant Condition Aggregation Method

*- Irr Class weighted average cannot be calculated on the current soils data due to missing data.