

Soils Map

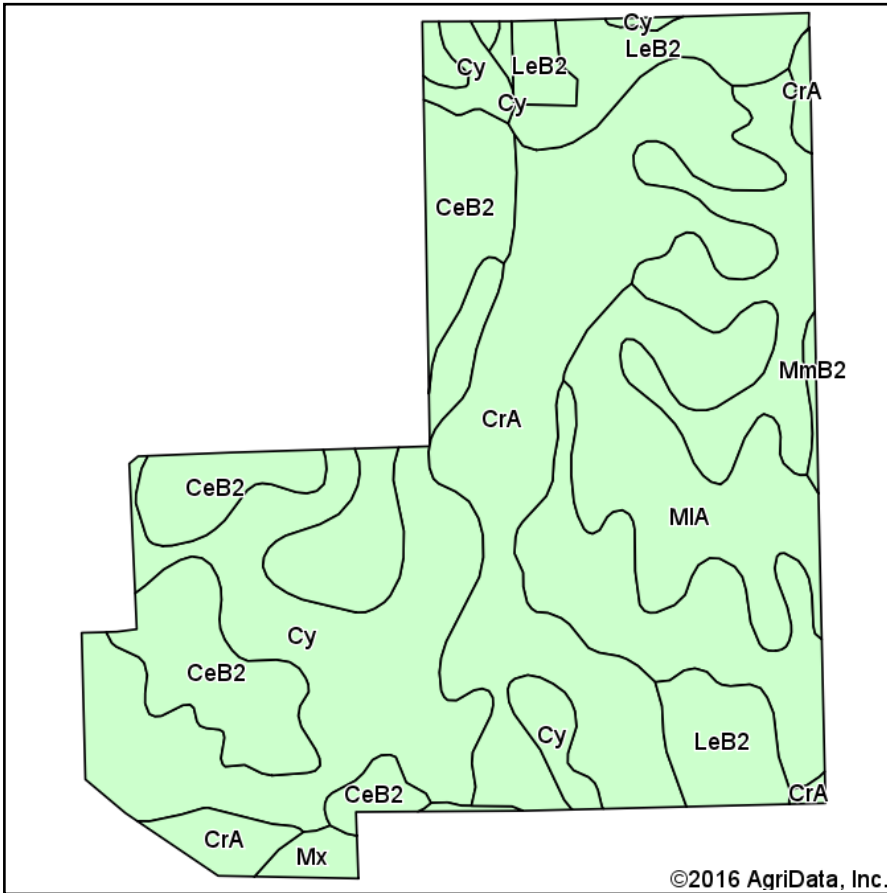

Soils data provided by USDA and NRCS.

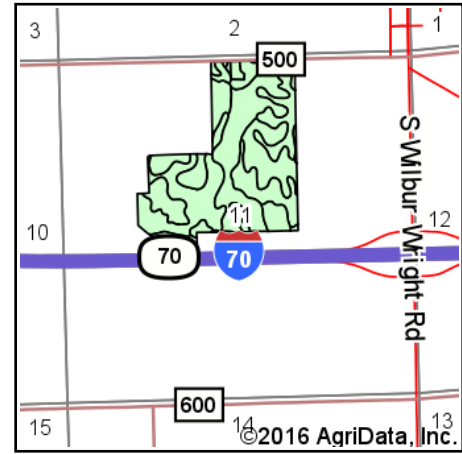

State: **Indiana**
 County: **Henry**
 Location: **11-16N-11E**
 Township: **Dudley**
 Acres: **110.53**
 Date: **4/18/2016**

Maps Provided By:

 CUSTOMIZED ONLINE MAPPING
 © AgriData, Inc. 2016 www.AgriDataInc.com



Area Symbol: IN065, Soil Area Version: 17

Code	Soil Description	Acres	Percent of field	Water Table	Restrictive Layer	Soil Drainage	Non-Irr Class *c	Corn	Soybeans	Winter wheat
Cy	Cyclone silty clay loam, 0 to 2 percent slopes	42.46	38.4%	0.2ft.	> 6.5ft.	Poorly drained	llw	184	54	75
CrA	Crosby silt loam, 0 to 2 percent slopes	26.79	24.2%	0.5ft.	3ft. (Densic material)	Somewhat poorly drained	llw	138	46	62
CeB2	Celina silt loam, 1 to 6 percent slopes, eroded	17.61	15.9%	2ft.	2.6ft. (Densic material)	Moderately well drained	lle	121	43	54
MIA	Miami silt loam, gravelly substratum, 0 to 2 percent slopes	12.81	11.6%	> 6.5ft.	4.9ft. (Strongly contrasting textural stratification)	Well drained	lls	131	46	66
LeB2	Losantville silt loam, 2 to 6 percent slopes, eroded	9.39	8.5%	1.8ft.	1.3ft. (Densic material)	Moderately well drained	lle	121	43	54
Mx	Millgrove loam	1.11	1.0%	0.5ft.	> 6.5ft.	Poorly drained	llw	175	49	70
MmB2	Miamian silt loam, New Castle Till Plain, 2 to 6 percent slopes, eroded	0.36	0.3%	2.5ft.	2.7ft. (Densic material)	Well drained	lle	127	45	57
Weighted Average								151	48.4	65.6

Area Symbol: IN065, Soil Area Version: 17

*c: Using Capabilities Class Dominant Condition Aggregation Method

Soils data provided by USDA and NRCS.

Soils Map

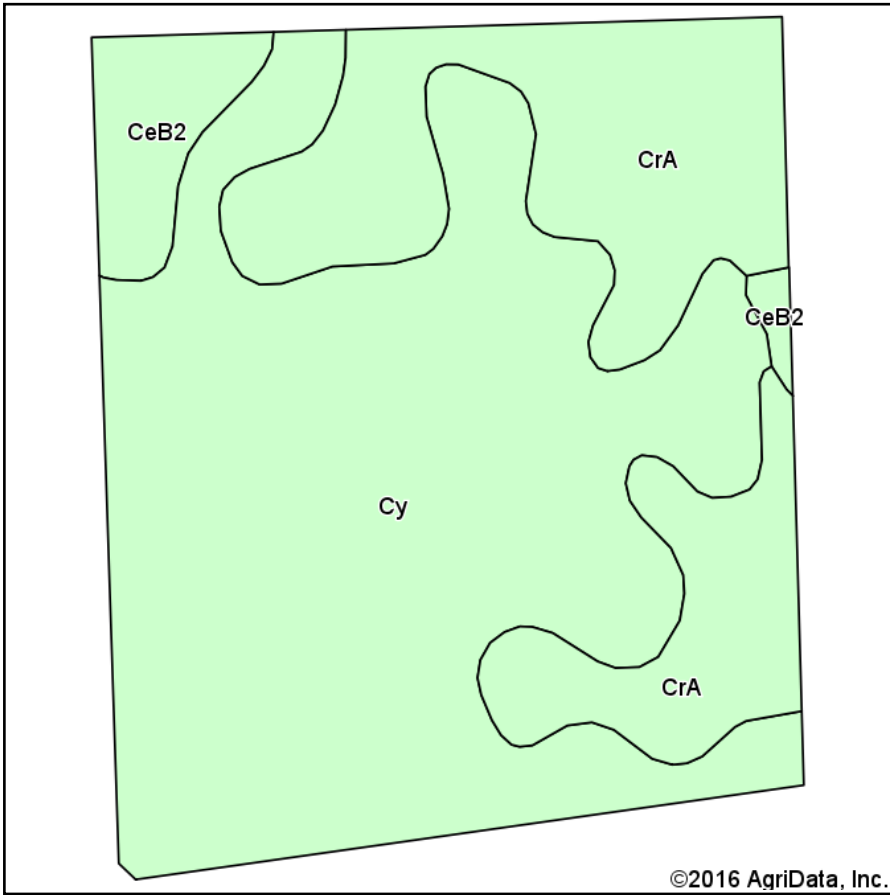

Soils data provided by USDA and NRCS.

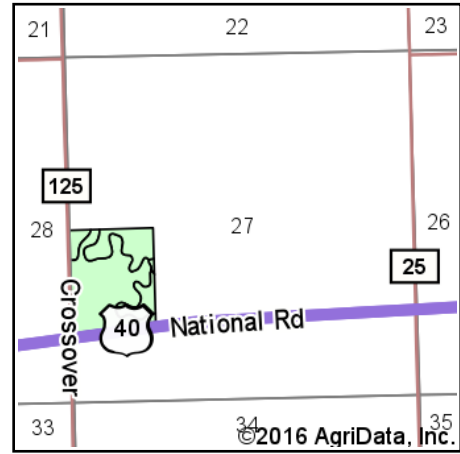

State: **Indiana**
 County: **Henry**
 Location: **27-16N-10E**
 Township: **Franklin**
 Acres: **46.1**
 Date: **4/18/2016**

Maps Provided By:



© AgriData, Inc. 2016

www.AgriDataInc.com



Area Symbol: IN065, Soil Area Version: 17

Code	Soil Description	Acres	Percent of field	Water Table	Restrictive Layer	Soil Drainage	Non-Irr Class *c	Corn	Soybeans	Winter wheat
Cy	Cyclone silty clay loam, 0 to 2 percent slopes	30.02	65.1%	0.2ft.	> 6.5ft.	Poorly drained	Ilw	184	54	75
CrA	Crosby silt loam, 0 to 2 percent slopes	13.58	29.5%	0.5ft.	3ft. (Densic material)	Somewhat poorly drained	Ilw	138	46	62
CeB2	Celina silt loam, 1 to 6 percent slopes, eroded	2.50	5.4%	2ft.	2.6ft. (Densic material)	Moderately well drained	Ile	121	43	54
Weighted Average								167	51	70

Area Symbol: IN065, Soil Area Version: 17

*c: Using Capabilities Class Dominant Condition Aggregation Method

Soils data provided by USDA and NRCS.