

Soils Map

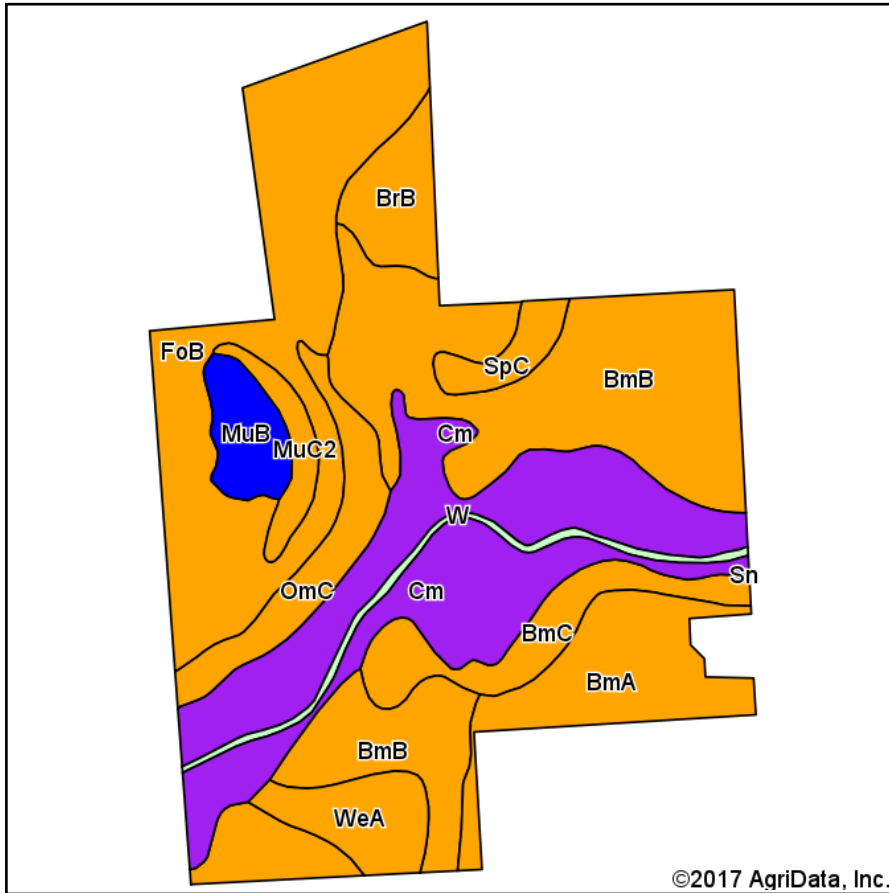

Soils data provided by USDA and NRCS.

©2017 AgriData, Inc.

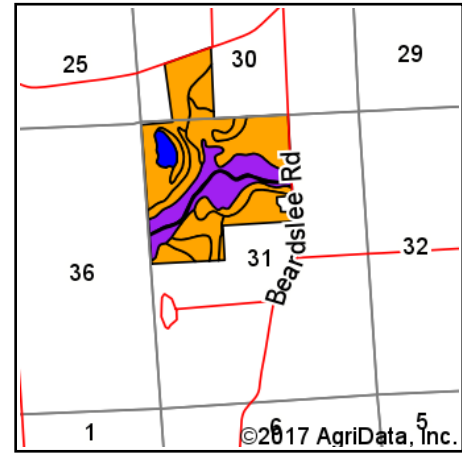

State: **Michigan**
 County: **Shiawassee**
 Location: **31-6N-2E**
 Township: **Bennington**
 Acres: **164.3**
 Date: **6/8/2017**



Maps Provided By:



© AgriData, Inc. 2017

www.AgrIDataInc.com



Archived Soils Ending 1/21/2012

Code	Soil Description	Acres	Percent of field	Non-Irr Class Legend	Water Table	Restrictive Layer	Soil Drainage	Non-Irr Class *c	Irr Class *c	Corn	Soybeans	Winter wheat
BmB	Boyer loamy sand, 2 to 6 percent slopes	45.36	27.6%		> 6.5ft.	> 6.5ft.	Well drained	IIIe		88	30	38
Cm	Ceresco loam	34.87	21.2%		0.5ft.	> 6.5ft.	Somewhat poorly drained	Vw		126	33	55
FoB	Fox sandy loam, 2 to 6 percent slopes	32.06	19.5%		> 6.5ft.	> 6.5ft.	Well drained	IIIs		115	30	45
BmA	Boyer loamy sand, 0 to 2 percent slopes	12.59	7.7%		> 6.5ft.	> 6.5ft.	Well drained	IIIs		88	30	38
BmC	Boyer loamy sand, 6 to 12 percent slopes	7.83	4.8%		> 6.5ft.	> 6.5ft.	Well drained	IIIe		82	26	35
OmC	Owosso-Miami sandy loams, 6 to 12 percent slopes	7.44	4.5%		> 6.5ft.	> 6.5ft.	Well drained	IIIe		131	35.8	64
WeA	Wasepi sandy loam, 0 to 2 percent slopes	5.84	3.6%		0.5ft.	> 6.5ft.	Somewhat poorly drained	IIIw		126	35	60
BrB	Boyer sandy loam, 2 to 6 percent slopes	5.67	3.5%		> 6.5ft.	> 6.5ft.	Well drained	IIIs		88	30	38
MuB	Miami loam, 2 to 6 percent slopes	4.55	2.8%		> 6.5ft.	> 6.5ft.	Well drained	Ile		131	35	66
MuC2	Miami loam, 6 to 12 percent slopes, moderately eroded	2.94	1.8%		> 6.5ft.	> 6.5ft.	Well drained	IIIe		125	33	63
SpC	Spinks loamy sand, 6 to 12 percent slopes	2.82	1.7%		> 6.5ft.	> 6.5ft.	Well drained	IIIe	IIIe	88	25	33
W	Water	2.33	1.4%		> 6.5ft.	> 6.5ft.						
Weighted Average										105	30.6	45.4

*c: Using Capabilities Class Dominant Condition Aggregation Method

Soils data provided by USDA and NRCS.