

# Soils Map

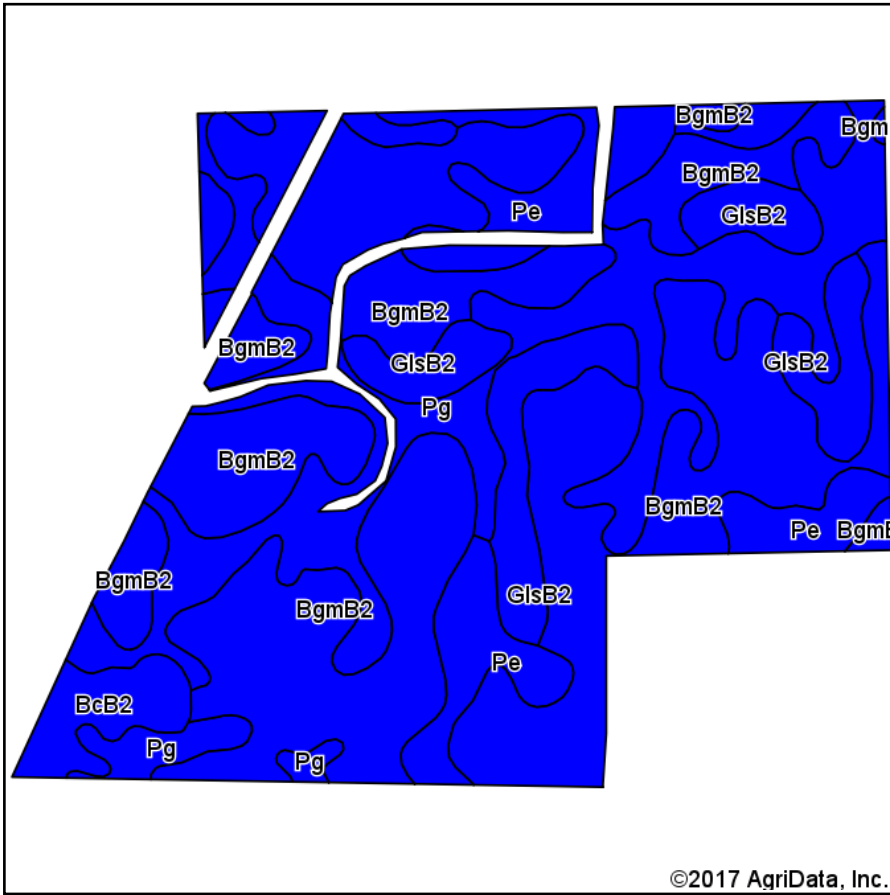

Soils data provided by USDA and NRCS.

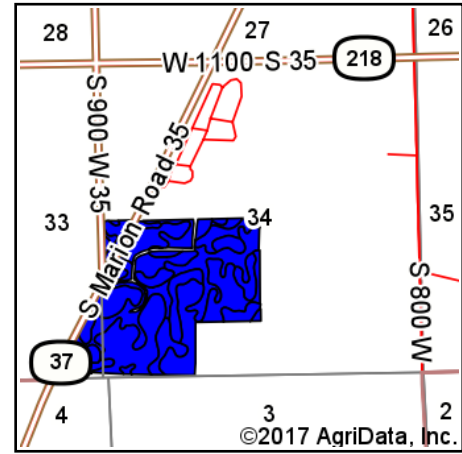

State: **Indiana**  
 County: **Huntington**  
 Location: **34-26N-8E**  
 Township: **Wayne**  
 Acres: **141.97**  
 Date: **8/18/2017**



Maps Provided By:



© AgriData, Inc. 2017

www.AgriDataInc.com



## Area Symbol: IN069, Soil Area Version: 19

Code	Soil Description	Acres	Percent of field	Non-Irr Class Legend	Water Table	Soil Drainage	Non-Irr Class *c	Corn	Winter wheat	Soybeans
BgmB2	Blount silt loam, ground moraine, 1 to 4 percent slopes, eroded	76.53	53.9%		0.7ft.	Somewhat poorly drained	Ile	137	61	44
Pg	Pewamo silty clay loam, 0 to 1 percent slopes	33.38	23.5%		0.5ft.	Very poorly drained	Ilw	157	64	47
GlsB2	Glynwood silt loam, ground moraine, 2 to 6 percent slopes, eroded	14.13	10.0%		1.5ft.	Moderately well drained	Ile	128	57	44
Pe	Patton silty clay loam, sandy substratum	13.73	9.7%		0.5ft.	Poorly drained	Ilw	175	70	49
BcB2	Blount silt loam, 1 to 4 percent slopes, eroded	4.20	3.0%		0.7ft.	Somewhat poorly drained	Ile	136	61	44
<b>Weighted Average</b>								<b>144.5</b>	<b>62.2</b>	<b>45.2</b>

\*c: Using Capabilities Class Dominant Condition Aggregation Method

Soils data provided by USDA and NRCS.