

Soils Map

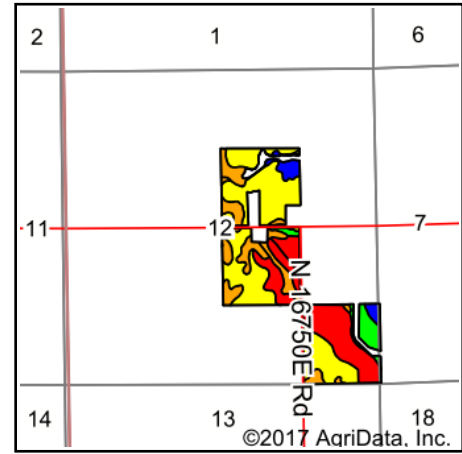

State: **Illinois**
 County: **Kankakee**
 Location: **12-32N-14E**
 Township: **Yellowhead**
 Acres: **108.67**
 Date: **11/27/2017**

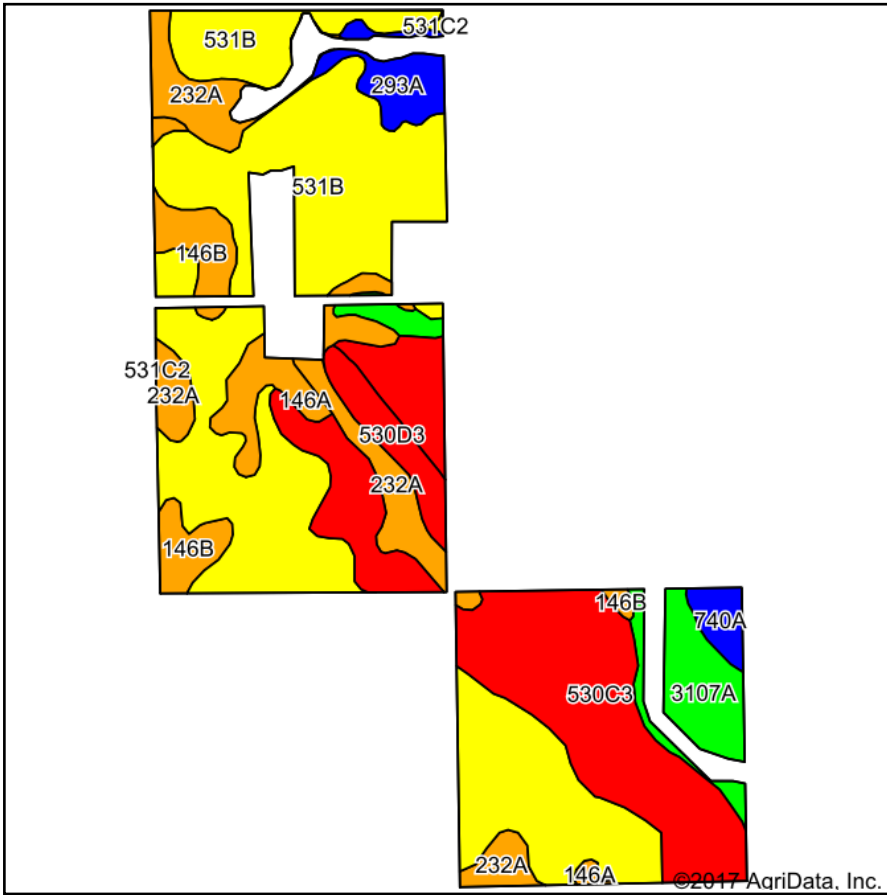

Soils data provided by USDA and NRCS.

Area Symbol: IL091, Soil Area Version: 12

Code	Soil Description	Acres	Percent of field	Il. State Productivity Index Legend	Subsoil rooting a	Corn Bu/A	Soybeans Bu/A	Wheat Bu/A	Oats Bu/A	Sorghum c Bu/A	Alfalfa d hay, T/A	Grass-le gume e hay, T/A	Crop productivity index for optimum management
**531B	Markham silt loam, 2 to 4 percent slopes	49.44	45.5%	Yellow	FAV	**153	**50	**60	**78	0	**4.10	0.00	**113
**530C3	Ozaukee silty clay loam, 4 to 6 percent slopes, severely eroded	26.06	24.0%	Red	FAV	**132	**41	**53	**70	0	**3.31	0.00	**96
232A	Ashkum silty clay loam, 0 to 2 percent slopes	9.33	8.6%	Orange	FAV	170	56	65	85	0	0.00	5.14	127
3107A	Sawmill silty clay loam, heavy till plain, 0 to 2 percent slopes, frequently flooded	6.64	6.1%	Green	FAV	189	60	71	98	0	0.00	5.77	139
**146B	Elliott silt loam, 2 to 4 percent slopes	5.08	4.7%	Orange	FAV	**166	**54	**67	**86	0	0.00	**4.97	**124
146A	Elliott silt loam, 0 to 2 percent slopes	4.47	4.1%	Orange	FAV	168	55	68	87	0	0.00	5.02	125
293A	Andres silt loam, 0 to 2 percent slopes	3.03	2.8%	Blue	FAV	184	59	71	97	0	0.00	5.39	135
**530D3	Ozaukee silty clay loam, 6 to 12 percent slopes, severely eroded	3.02	2.8%	Red	FAV	**129	**40	**52	**69	0	**3.23	0.00	**94
740A	Darroch silt loam, 0 to 2 percent slopes	1.50	1.4%	Blue	FAV	177	57	70	92	0	0.00	5.14	129
**531C2	Markham silt loam, 4 to 6 percent slopes, eroded	0.10	0.1%	Yellow	FAV	**147	**48	**58	**75	0	**3.93	0.00	**108
Weighted Average						153.4	49.4	60.3	79.1	*	2.75	1.45	113

Table: Optimum Crop Productivity Ratings for Illinois Soil by K.R. Olson and J.M. Lang, Office of Research, ACES, University of Illinois at Champaign-Urbana. Version: 1/2/2012 Amended Table S2 B811

Crop yields and productivity indices for optimum management (B811) are maintained at the following NRES web site:

<https://www.ideals.illinois.edu/handle/2142/1027/>

** Indexes adjusted for slope and erosion according to Bulletin 811 Table S3

a UNF = unfavorable; FAV = favorable

b Soils in the southern region were not rated for oats and are shown with a zero "0".

c Soils in the northern region or in both regions were not rated for grain sorghum and are shown with a zero "0".

d Soils in the poorly drained group were not rated for alfalfa and are shown with a zero "0".

e Soils in the well drained group were not rated for grass-legume and are shown with a zero "0".

*c: Using Capabilities Class Dominant Condition Aggregation Method

Soils data provided by USDA and NRCS. Soils data provided by University of Illinois at Champaign-Urbana.

Soils Map

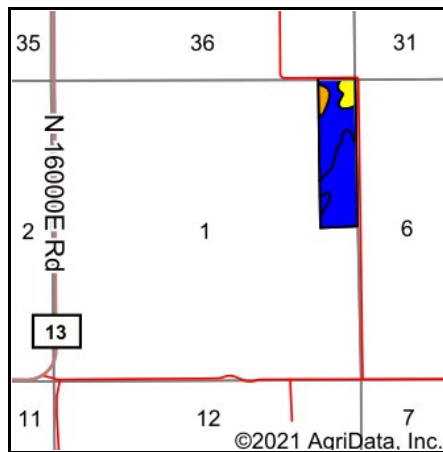
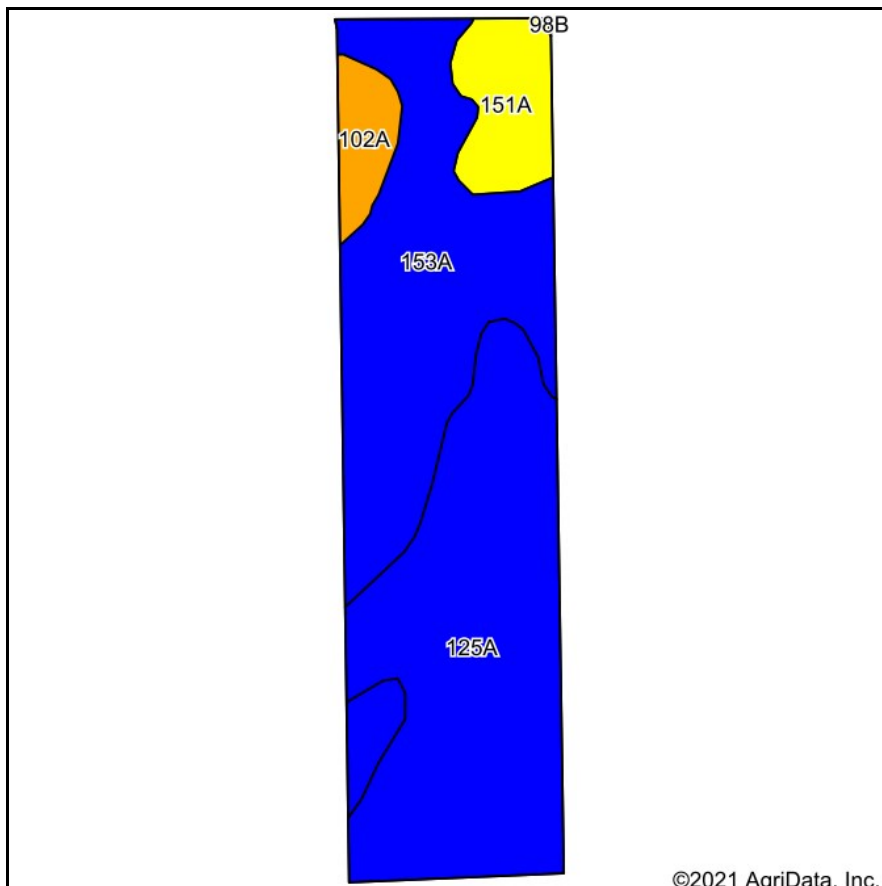

State: **Illinois**
 County: **Kankakee**
 Location: **1-31N-14E**
 Township: **Momence**
 Acres: **39.75**
 Date: **8/12/2021**



Soils data provided by USDA and NRCS.

©2021 AgriData, Inc.

© AgriData, Inc. 2021

www.AgriDataInc.com

Area Symbol: IL091, Soil Area Version: 17

Code	Soil Description	Acres	Percent of field	Il. State Productivity Index Legend	Water Table	Restrictive Layer	Soil Drainage	Subsoil rooting ^a	Corn Bu/A	Soybeans Bu/A	Wheat Bu/A	Grass-legume hay, T/A	Crop productivity index for optimum management
125A	Selma loam, 0 to 2 percent slopes	18.82	47.3%		0.5ft.	> 6.5ft.	Poorly drained	FAV	176	57	70	6.38	129
153A	Pella silty clay loam, 0 to 2 percent slopes	15.79	39.7%		0.5ft.	> 6.5ft.	Poorly drained	FAV	183	60	70	5.27	136
151A	Ridgeville fine sandy loam, 0 to 2 percent slopes	3.33	8.4%		1.5ft.	> 6.5ft.	Somewhat poorly drained	FAV	151	51	63	5.02	114
102A	La Hogue loam, 0 to 2 percent slopes	1.81	4.6%		1.5ft.	> 6.5ft.	Somewhat poorly drained	FAV	162	52	71	5.27	121
Weighted Average									176	57.5	69.5	5.77	130.2

Table: Optimum Crop Productivity Ratings for Illinois Soil by K.R. Olson and J.M. Lang, Office of Research, ACES, University of Illinois at Champaign-Urbana. Version: 1/2/2012 Amended Table S2 B811

Crop yields and productivity indices for optimum management (B811) are maintained at the following NRES web site:

<http://soilproductivity.nres.illinois.edu/>

** Indexes adjusted for slope and erosion according to Bulletin 811 Table S3

^a UNF = unfavorable; FAV = favorable

^e Soils in the well drained group were not rated for grass-legume and are shown with a zero "0".