

# Soils Map

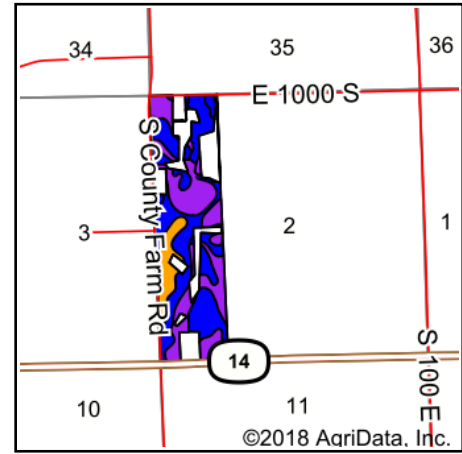

State: **Indiana**  
 County: **Kosciusko**  
 Location: **2-30N-6E**  
 Township: **Lake**  
 Acres: **125.95**  
 Date: **11/21/2018**

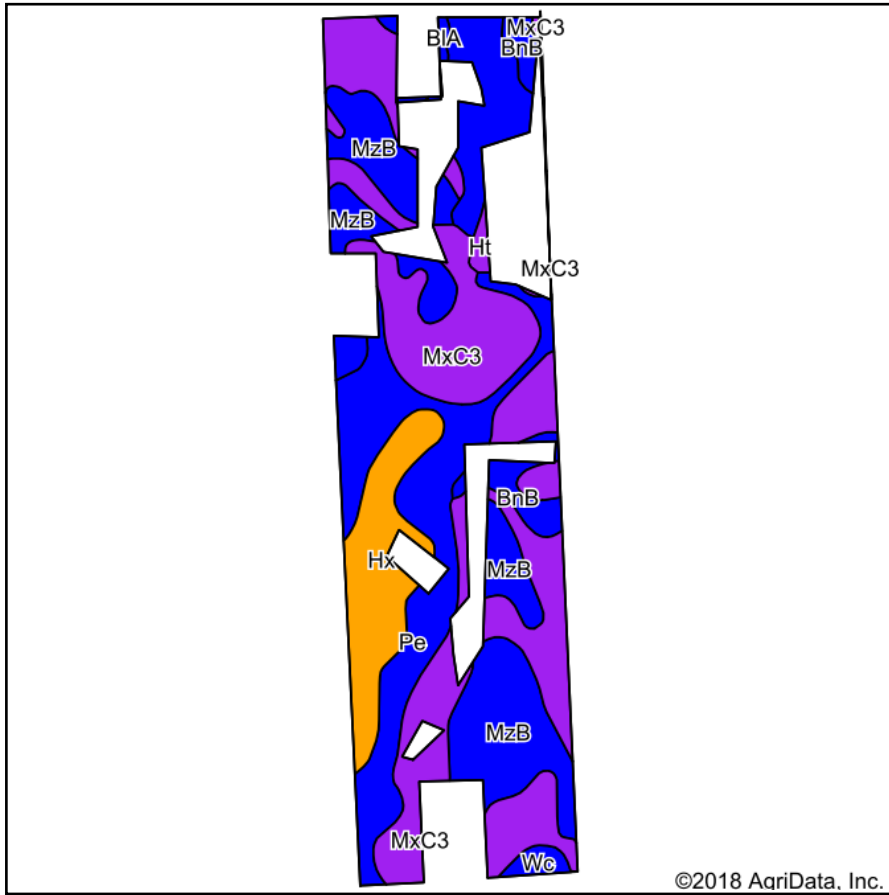

**Area Symbol: IN085, Soil Area Version: 21**

Code	Soil Description	Acres	Percent of field	Non-Irr Class Legend	Water Table	Restrictive Layer	Soil Drainage	Non-Irr Class *c	Soybeans	Corn	Winter wheat	*n NCCPI Soybeans
MxC3	Morley silty clay loam, 5 to 15 percent slopes, severely eroded	46.63	37.0%		2.7ft.	2.3ft. (Densic material)	Moderately well drained	Vle	37	105	47	20
Pe	Pewamo silty clay loam, 0 to 1 percent slopes	32.30	25.6%		0.5ft.	> 6.5ft.	Very poorly drained	Ilw	47	157	64	67
MzB	Morley-Glynwood complex, 1 to 4 percent slopes	26.83	21.3%		2.7ft.	3.5ft. (Densic material)	Moderately well drained	Ile	46	130	59	50
Hx	Houghton muck, drained	13.17	10.5%		0.7ft.	> 6.5ft.	Very poorly drained	Illw	42	159	64	89
BnB	Blount-Glynwood complex, 1 to 3 percent slopes	4.30	3.4%		2ft.	2.5ft. (Densic material)	Somewhat poorly drained	Ile	41	123	55	44
Wc	Washtenaw silt loam	1.25	1.0%		0.2ft.	> 6.5ft.	Poorly drained	Ilw	49	165	66	79
Ht	Houghton muck, undrained, 0 to 1 percent slopes	0.81	0.6%		0ft.	> 6.5ft.	Very poorly drained	Vw				22
BIA	Blount silt loam, 0 to 2 percent slopes	0.66	0.5%		0.7ft.	3.2ft. (Densic material)	Somewhat poorly drained	Ilw	46	141	63	51
<b>Weighted Average</b>									<b>42.1</b>	<b>130</b>	<b>55.9</b>	<b>*n 47.2</b>

\*n: The aggregation method is "Weighted Average using major components"

\*c: Using Capabilities Class Dominant Condition Aggregation Method

Soils data provided by USDA and NRCS.