

Soils Map

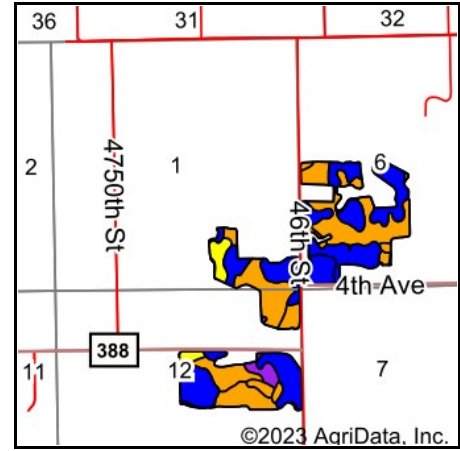

State: **Michigan**
 County: **Van Buren**
 Location: **1-1S-15W**
 Township: **Columbia**
 Acres: **205.34**
 Date: **4/4/2023**

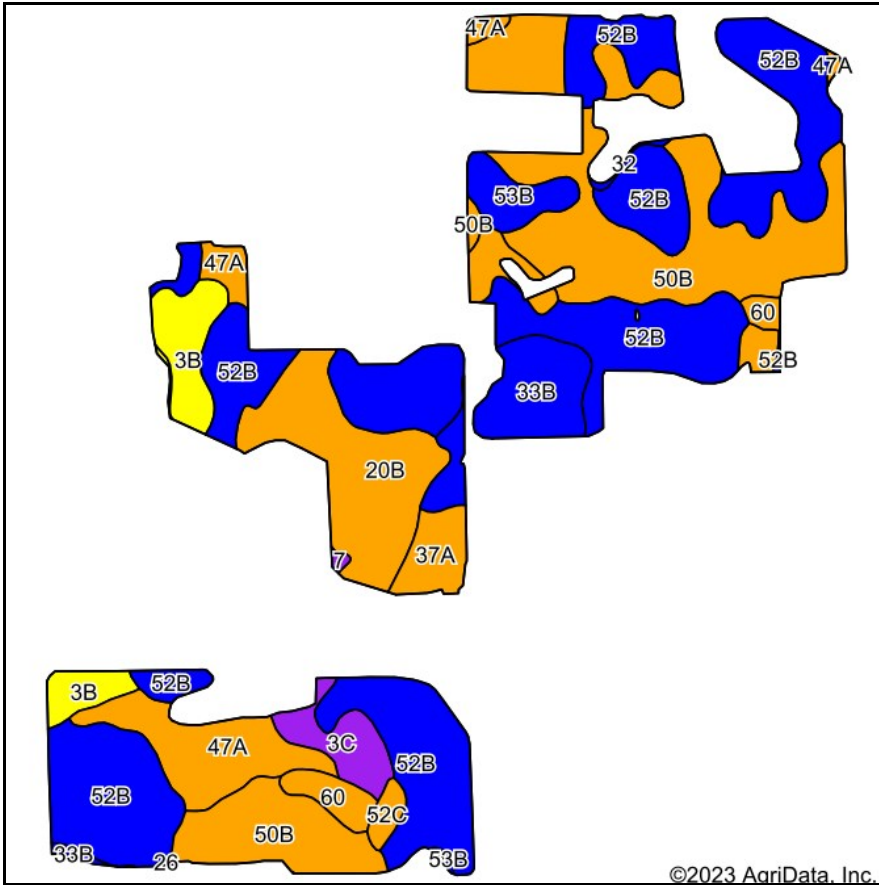

Maps Provided By:



© AgriData, Inc. 2023

www.AgriDataInc.com



Soils data provided by USDA and NRCS.

Archived Soils Ending 1/21/2012

Code	Soil Description	Acres	Percent of field	Non-Irr Class Legend	Water Table	Restrictive Layer	Soil Drainage	Non-Irr Class *c	Irr Class *c	Corn Bu	Corn Irrigated Bu	Soybeans Bu	Soybeans Irrigated Bu	Winter wheat Bu
52B	Riddles sandy loam, 1 to 6 percent slopes	81.54	39.7%		> 6.5ft.	> 6.5ft.	Well drained	Ile		110		38		50
50B	Metae loamy fine sand, 1 to 6 percent slopes	47.03	22.9%		> 6.5ft.	> 6.5ft.	Well drained	IIle		85		30		42
20B	Spinks loamy sand, 0 to 6 percent slopes	18.48	9.0%		0ft.	> 6.5ft.	Well drained	IIIs	IIIs	75	165	27	50	30
47A	Selfridge loamy sand, 0 to 3 percent slopes	17.86	8.7%		0.5ft.	> 6.5ft.	Somewhat poorly drained	IIIW		110		35		42
33B	Tuscola silt loam, 0 to 4 percent slopes	10.79	5.3%		1.5ft.	> 6.5ft.	Moderately well drained	Ile		100		32		47
3B	Coloma loamy sand, 0 to 6 percent slopes	8.87	4.3%		> 6.5ft.	> 6.5ft.	Excessively drained	IVs	IIle	45	170	18	55	

Soils data provided by USDA and NRCS.

Code	Soil Description	Acres	Percent of field	Non-Irr Class Legend	Water Table	Restrictive Layer	Soil Drainage	Non-Irr Class *c	Irr Class *c	Corn Bu	Corn Irrigated Bu	Soybeans Bu	Soybeans Irrigated Bu	Winter wheat Bu
53B	Capac loam, 1 to 5 percent slopes	5.57	2.7%		0.5ft.	> 6.5ft.	Somewhat poorly drained	Ile		110	155	36		62
3C	Coloma loamy sand, 6 to 12 percent slopes	5.09	2.5%		> 6.5ft.	> 6.5ft.	Excessively drained	VI s						
37A	Thetford loamy sand, 0 to 2 percent slopes	4.27	2.1%		0.5ft.	> 6.5ft.	Somewhat poorly drained	III w		85	148	32		35
60	Belleville loamy sand	3.70	1.8%		0ft.	> 6.5ft.	Poorly drained	III w		115		35		50
52C	Riddles sandy loam, 6 to 12 percent slopes	1.39	0.7%		> 6.5ft.	> 6.5ft.	Well drained	Ile		105		37		47
32	Colwood silt loam	0.28	0.1%		0ft.	> 6.5ft.	Poorly drained	II w		140		45		65
7	Glendora sandy loam	0.25	0.1%		0ft.	> 6.5ft.	Very poorly drained	VI w						
27	Adrian muck	0.15	0.1%		0ft.	> 6.5ft.	Very poorly drained	IV w		100		32		
26	Gilford sandy loam	0.07	0.0%		0ft.	> 6.5ft.	Very poorly drained	V w						
Weighted Average								2.64	*-	94.5	29.5	32.5	6.9	42

*c: Using Capabilities Class Dominant Condition Aggregation Method

*- Irr Class weighted average cannot be calculated on the current soils data due to missing data.