

# Soils Map

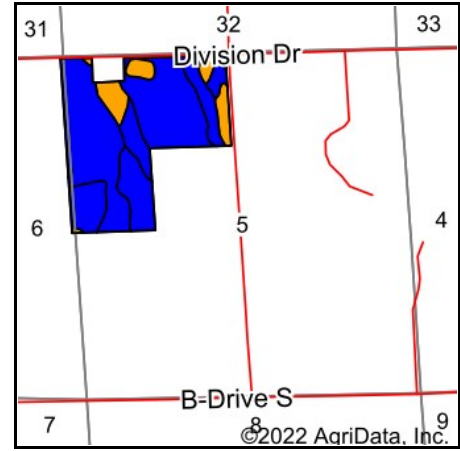

State: **Michigan**  
 County: **Calhoun**  
 Location: **5-3S-4W**  
 Township: **Albion**  
 Acres: **121.56**  
 Date: **1/7/2022**

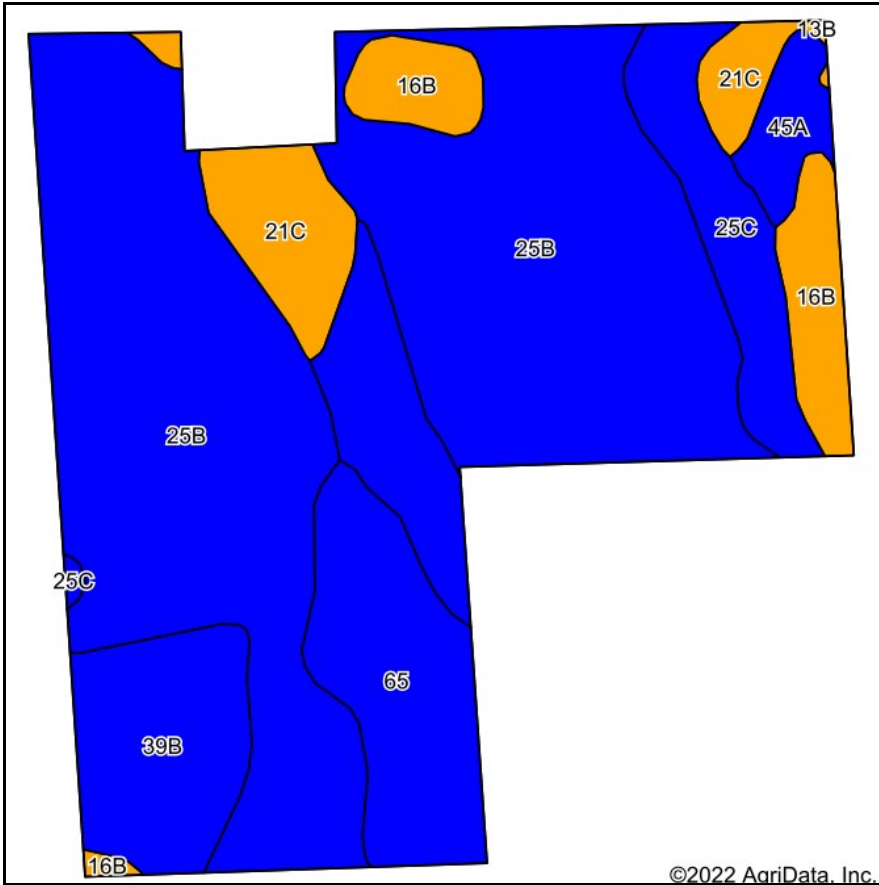

Maps Provided By:



Soils data provided by USDA and NRCS.

©2022 AgriData, Inc.

© AgriData, Inc. 2021

www.AgriDataInc.com

Area Symbol: MI025, Soil Area Version: 19

Code	Soil Description	Acres	Percent of field	Non-Irr Class Legend	Water Table	Restrictive Layer	Soil Drainage	Non-Irr Class *c	Irr Class *c	Corn Bu	Corn Irrigated Bu	Soybeans Bu	Soybeans Irrigated Bu	Winter wheat Bu	*n NCCPI Soybeans
25B	Kalamazoo loam, 2 to 6 percent slopes	70.21	57.8%		> 6.5ft.	> 6.5ft.	Well drained	lle	lle	1					48
25C	Kalamazoo loam, 6 to 12 percent slopes	13.64	11.2%		> 6.5ft.	> 6.5ft.	Well drained	lle	lle	1					46
65	Sebewa loam, 0 to 2 percent slopes	11.55	9.5%		0ft.	> 6.5ft.	Poorly drained	llw							77
39B	Morley loam, 2 to 6 percent slopes	9.28	7.6%		> 6.5ft.	> 6.5ft.	Well drained	lle		104	8	38	3	55	58
21C	Leoni gravelly loam, 6 to 12 percent slopes	7.30	6.0%		> 6.5ft.	> 6.5ft.	Well drained	llle		99	146	31	50	36	39
16B	Oshtemo sandy loam, 0 to 6 percent slopes	6.75	5.6%		> 6.5ft.	> 6.5ft.	Well drained	llls	llls						43

Soils data provided by USDA and NRCS.



Code	Soil Description	Acres	Percent of field	Non-Irr Class Legend	Water Table	Restrictive Layer	Soil Drainage	Non-Irr Class *c	Irr Class *c	Com Bu	Corn Irrigated Bu	Soybeans Bu	Soybeans Irrigated Bu	Winter wheat Bu	*n NCCPI Soybeans
45A	Sleeth loam, 0 to 2 percent slopes	2.70	2.2%		2ft.	> 6.5ft.	Somewhat poorly drained	llw		121		42		64	63
13B	Spinks loamy sand, 0 to 6 percent slopes	0.13	0.1%		> 6.5ft.	> 6.5ft.	Well drained	lls	lls						32
<b>Weighted Average</b>								<b>2.12</b>	<b>1.55</b>	<b>17.3</b>	<b>9.4</b>	<b>5.7</b>	<b>3.2</b>	<b>7.8</b>	<b>*n 50.8</b>

\*n: The aggregation method is "Weighted Average using all components"

\*c: Using Capabilities Class Dominant Condition Aggregation Method