

Soils Map

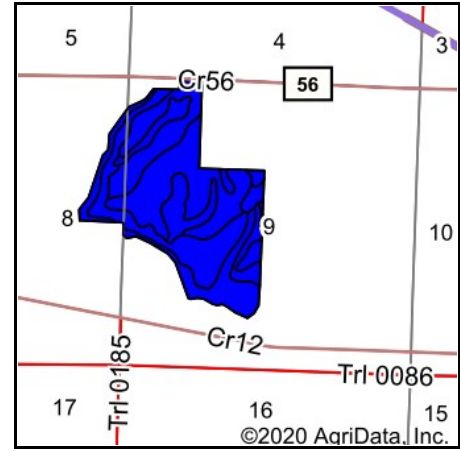

State: **Ohio**
 County: **Seneca**
 Location: **9-1N-17E**
 Township: **Venice**
 Acres: **187.47**
 Date: **12/17/2020**

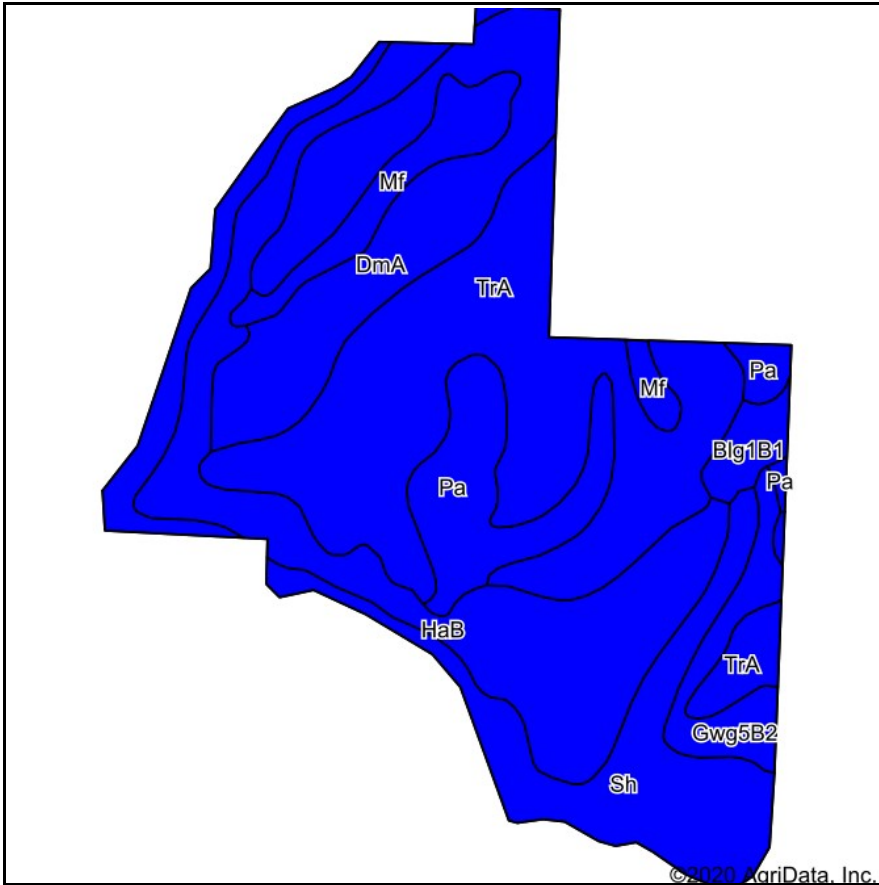

Soils data provided by USDA and NRCS.

Area Symbol: OH147, Soil Area Version: 19

| Code | Soil Description | Acres | Percent of field | Non-Irr Class Legend | Water Table | Non-Irr Class *c | Corn | Oats | Soybeans | Winter wheat | *n NCCPI Overall | *n NCCPI Soybeans | *eFOTG P | |
|-------------------------|--|-------|------------------|----------------------|-------------|------------------|------|--------------|-----------|--------------|------------------|-------------------|--------------|-------------|
| TrA | Tiro silt loam, 0 to 2 percent slopes | 56.07 | 29.9% | | 0.7ft. | llw | 172 | | 50 | 60 | 78 | 70 | 78 | |
| HaB | Haney loam, 2 to 6 percent slopes | 37.03 | 19.8% | | 2.7ft. | lle | 100 | 85 | 38 | 44 | 62 | 48 | 71 | |
| Sh | Shoals silt loam, 0 to 2 percent slopes, frequently flooded | 30.47 | 16.3% | | 1ft. | llw | 121 | | 35 | | 74 | 73 | 68 | |
| DmA | Digby loam, 1 to 4 percent slopes | 29.93 | 16.0% | | 1.7ft. | llw | 115 | 80 | 44 | 45 | 58 | 49 | 75 | |
| Pa | Pandora silt loam | 15.02 | 8.0% | | 0.5ft. | llw | 115 | 74 | 37 | 48 | 74 | 65 | 72 | |
| Mf | Millgrove loam | 8.86 | 4.7% | | 0.5ft. | llw | 130 | 95 | 50 | 50 | 71 | 71 | 100 | |
| Gwg5B2 | Glywood clay loam, ground moraine, 2 to 6 percent slopes, eroded | 6.85 | 3.7% | | 1.5ft. | lle | 125 | | 42 | 55 | 51 | 38 | 65 | |
| Blg1B1 | Blount silt loam, ground moraine, 2 to 4 percent slopes | 3.24 | 1.7% | | 0.7ft. | lle | 137 | | 44 | 61 | 62 | 56 | 75 | |
| Weighted Average | | | | | | | | 131.5 | 40 | 42.8 | 43.1 | *n 69.1 | *n 61 | 74.5 |

Soils data provided by USDA and NRCS.