

# Soils Map

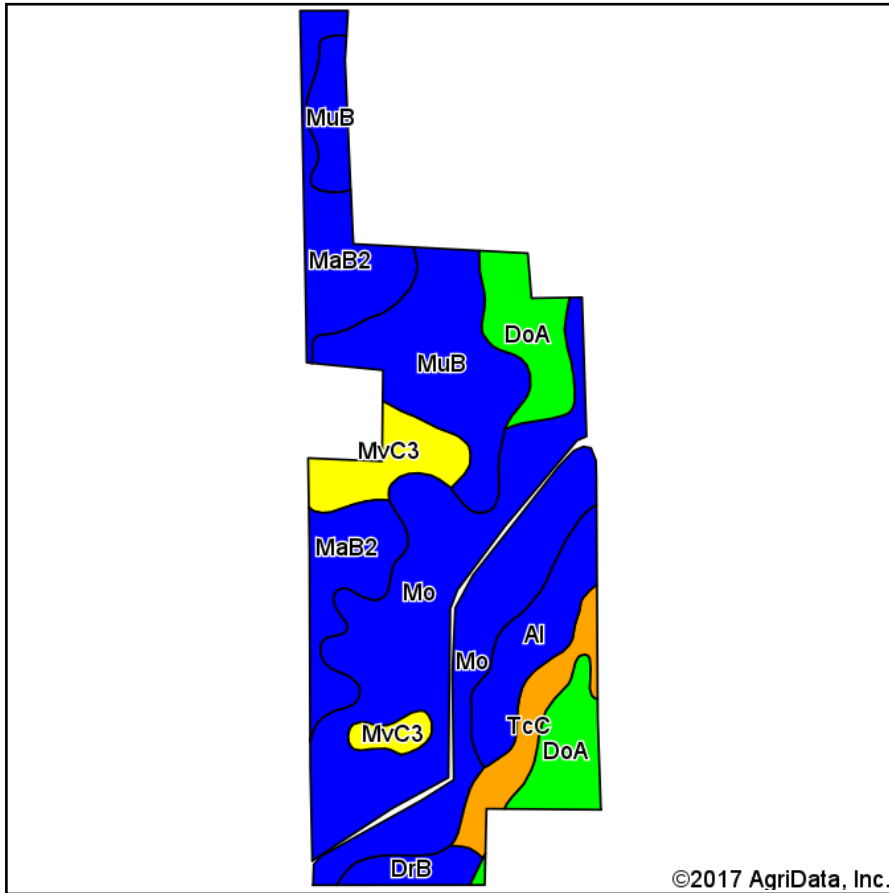

Soils data provided by USDA and NRCS.

©2017 AgriData, Inc.

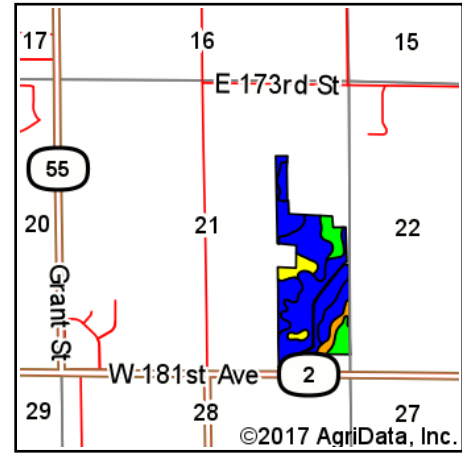

State: **Indiana**  
 County: **Lake**  
 Location: **21-33N-8W**  
 Township: **Cedar Creek**  
 Acres: **81.02**  
 Date: **5/16/2017**



© AgriData, Inc. 2017 www.AgriDataInc.com



## Area Symbol: IN089, Soil Area Version: 19

Code	Soil Description	Acres	Percent of field	Non-Irr Class Legend	Water Table	Restrictive Layer	Soil Drainage	Non-Irr Class *c	Corn	Soybeans	Winter wheat
Mo	Milford silt loam, overwash	29.73	36.7%	[Blue]	0.2ft.	> 6.5ft.	Very poorly drained	IIw	160	44	64
MuB	Ozaukee silt loam, 2 to 6 percent slopes	14.02	17.3%	[Blue]	2.2ft.	3.2ft. (Densic material)	Moderately well drained	IIe	131	41	52
MaB2	Markham silt loam, 2 to 6 percent slopes, eroded	12.04	14.9%	[Blue]	2.2ft.	2.5ft. (Densic material)	Moderately well drained	IIe	122	41	55
DoA	Door loam, 0 to 2 percent slopes	8.71	10.8%	[Green]	> 6.5ft.	3.8ft. (Strongly contrasting textural stratification)	Well drained	I	126	45	63
Al	Alida loam	5.49	6.8%	[Blue]	1.5ft.	> 6.5ft.	Somewhat poorly drained	IIIs	150	47	68
MvC3	Ozaukee silty clay loam, 6 to 12 percent slopes, severely eroded	5.13	6.3%	[Yellow]	2.4ft.	2.1ft. (Densic material)	Moderately well drained	IVe	105	33	42
TcC	Tracy loam, 6 to 12 percent slopes	3.99	4.9%	[Orange]	> 6.5ft.	> 6.5ft.	Well drained	IIIe	97	34	48
DrB	Door loam, silty clay loam substratum, 2 to 6 percent slopes	1.91	2.4%	[Blue]	> 6.5ft.	3.8ft. (Densic material)	Well drained	IIe	135	47	68
<b>Weighted Average</b>									<b>137.8</b>	<b>42.2</b>	<b>58.7</b>

\*c: Using Capabilities Class Dominant Condition Aggregation Method

Soils data provided by USDA and NRCS.