

# Tillable Soils Map

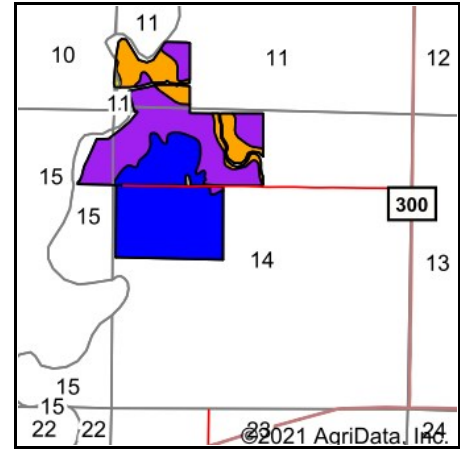

State: **Illinois**  
 County: **Wabash**  
 Location: **14-1S-14W**  
 Township: **Bellmont**  
 Acres: **180.92**  
 Date: **11/8/2021**

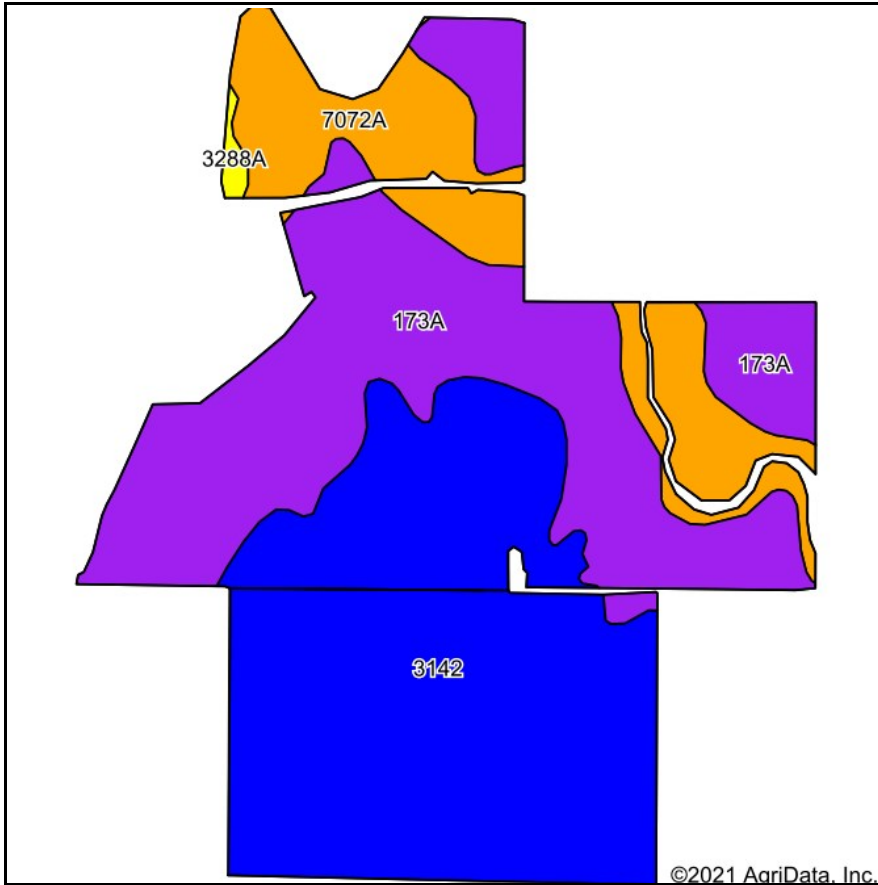

Maps Provided By:



Soils data provided by USDA and NRCS.

©2021 AgriData, Inc.

© AgriData, Inc. 2021

www.AgriDataInc.com

Area Symbol: IL047, Soil Area Version: 13  
 Area Symbol: IL185, Soil Area Version: 15

Code	Soil Description	Acres	Percent of field	Il. State Productivity Index Legend	Soil Drainage	Subsoil rooting <sup>a</sup>	Corn Bu/A	Soybeans Bu/A	Wheat Bu/A	Oats Bu/A <sup>b</sup>	Sorghum <sup>c</sup> Bu/A	Alfalfa <sup>d</sup> hay, T/A	Grass-legume <sup>e</sup> hay, T/A	Crop productivity index for optimum management
3142	Patton silty clay loam, frequently flooded	84.04	46.5%		Poorly drained	FAV	178	58	68	85	0	0.00	5.39	132
173A	McGary silt loam, 0 to 2 percent slope	68.53	37.9%		Somewhat poorly drained	UNF	132	45	56	64	0	0.00	4.26	100
7072A	Sharon silt loam, 0 to 2 percent slopes, rarely flooded	27.51	15.2%		Moderately well drained	FAV	164	53	63	83	0	4.77	0.00	122
3288A	Petrolia silty clay loam, 0 to 2 percent slopes, frequently flooded	0.84	0.5%		Poorly drained	FAV	162	49	61	79	0	0.00	4.89	117
<b>Weighted Average</b>							<b>158.4</b>	<b>52.3</b>	<b>62.7</b>	<b>76.7</b>	<b>*-</b>	<b>0.73</b>	<b>4.14</b>	<b>118.3</b>