

# Soils Map

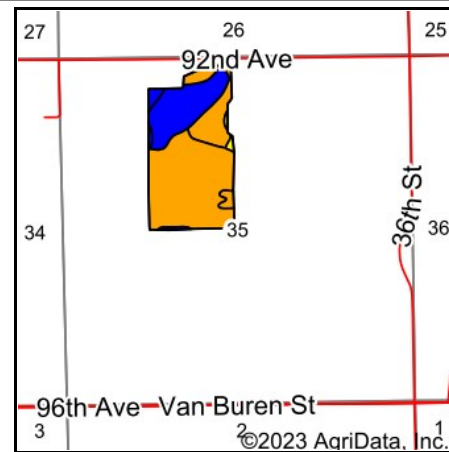

State: **Michigan**  
 County: **Van Buren**  
 Location: **35-4S-14W**  
 Township: **Decatur**  
 Acres: **67.37**  
 Date: **4/4/2023**

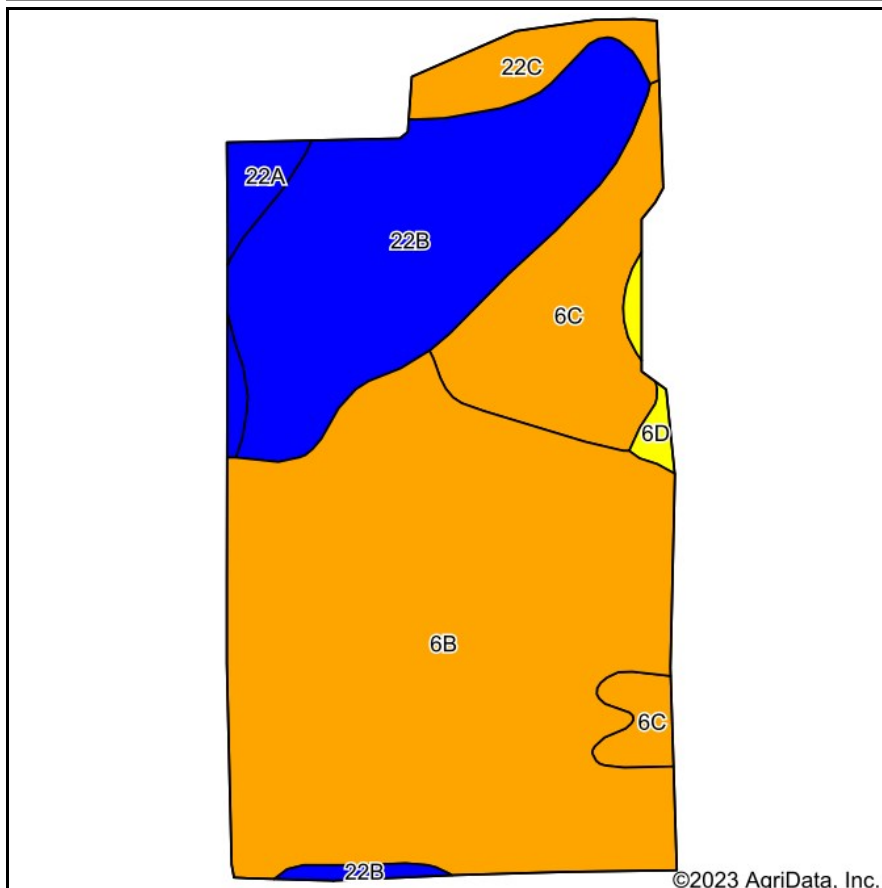

Maps Provided By:



Soils data provided by USDA and NRCS.

©2023 AgriData, Inc.

© AgriData, Inc. 2023

www.AgriDataInc.com

## Archived Soils Ending 1/21/2012

Code	Soil Description	Acres	Percent of field	Non-Irr Class Legend	Restrictive Layer	Soil Drainage	Non-Irr Class *c	Irr Class *c	Corn Bu	Corn Irrigated Bu	Soybeans Bu	Soybeans Irrigated Bu	Winter wheat Bu
6B	Oshtemo sandy loam, 0 to 6 percent slopes	37.43	55.6%		> 6.5ft.	Well drained	lls	lle	95	175	30	57	45
22B	Kalamazoo loam, 2 to 6 percent slopes	16.73	24.8%		> 6.5ft.	Well drained	lle	lle	95	175	30	55	40
6C	Oshtemo sandy loam, 6 to 12 percent slopes	8.75	13.0%		> 6.5ft.	Well drained	lle	lle	90	165	26	50	40
22C	Kalamazoo loam, 6 to 12 percent slopes	2.41	3.6%		> 6.5ft.	Well drained	lle		85		27		38
22A	Kalamazoo loam, 0 to 2 percent slopes	1.40	2.1%		> 6.5ft.	Well drained	lls	lls	100	175	30	55	40
6D	Oshtemo-Coloma loamy sands, 12 to 18 percent slopes	0.65	1.0%		> 6.5ft.	Well drained	Ive		80		21		35
<b>Weighted Average</b>							<b>2.74</b>	<b>*-</b>	<b>94</b>	<b>165.8</b>	<b>29.3</b>	<b>53</b>	<b>42.7</b>

\*c: Using Capabilities Class Dominant Condition Aggregation Method

\*- Irr Class weighted average cannot be calculated on the current soils data due to missing data.