

Soils Map

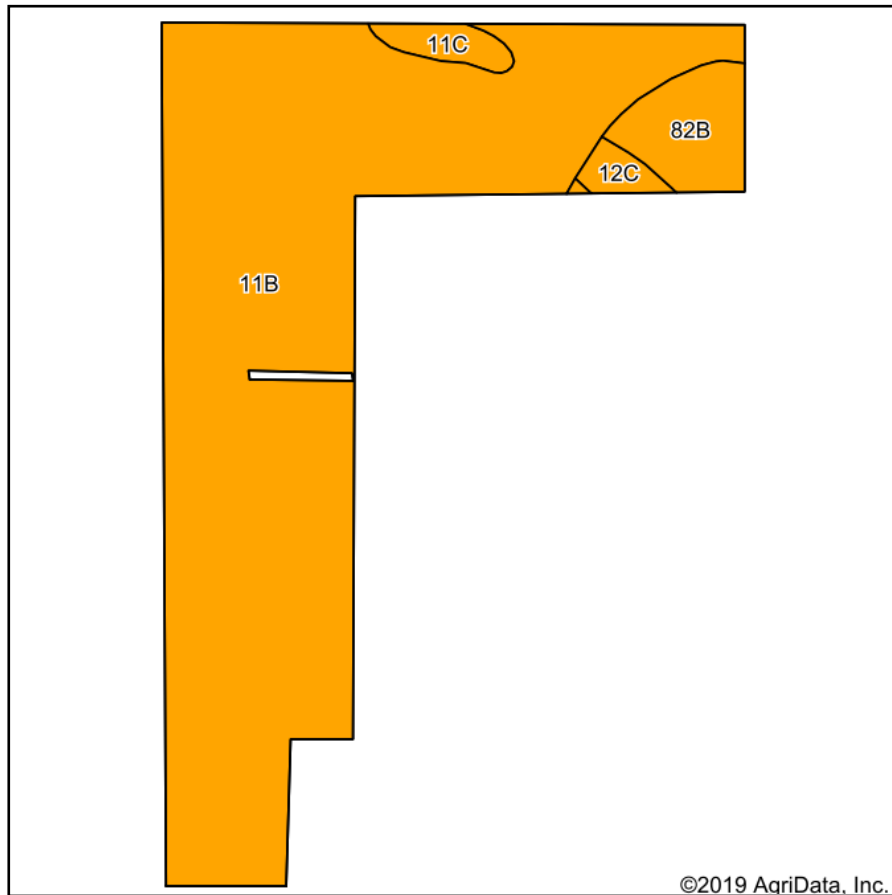

Soils data provided by USDA and NRCS.

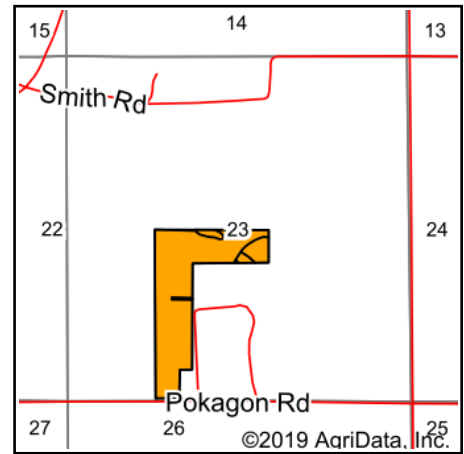

State: **Michigan**
 County: **Berrien**
 Location: **23-6S-17W**
 Township: **Berrien**
 Acres: **44.84**
 Date: **7/16/2019**



Maps Provided By:



Area Symbol: MI021, Soil Area Version: 13

Code	Soil Description	Acres	Percent of field	Non-Irr Class Legend	Restrictive Layer	Soil Drainage	Non-Irr Class *c	Irr Class *c	Cor n	Corn Irrigated	Soybeans	Soybeans Irrigated	Winter wheat	*n NCCPI Soybeans
11B	Oshtemo sandy loam, 0 to 6 percent slopes	40.58	90.5%		> 6.5ft.	Well drained	III s	III s						41
82B	Oshtemo-Ockley complex, 0 to 4 percent slopes	2.71	6.0%		> 6.5ft.	Well drained	III s	III e	95	175	30	57	45	50
11C	Oshtemo sandy loam, 6 to 12 percent slopes	0.91	2.0%		> 6.5ft.	Well drained	III e	III e						39
12C	Ockley loam, 6 to 12 percent slopes	0.64	1.4%		> 6.5ft.	Well drained	III e		100		35		40	56
Weighted Average									7.2	10.6	2.3	3.4	3.3	*n 41.7

*n: The aggregation method is "Weighted Average using major components"

*c: Using Capabilities Class Dominant Condition Aggregation Method

Soils data provided by USDA and NRCS.