

Soils Map

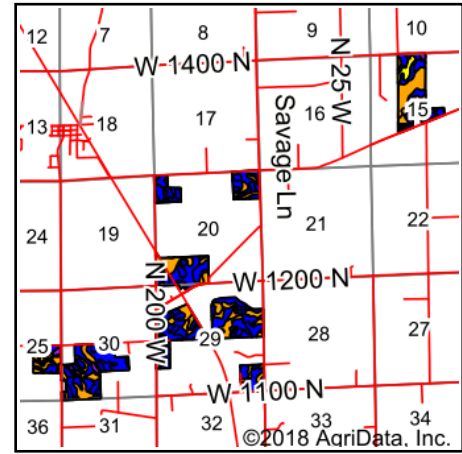

State: **Indiana**
 County: **Miami**
 Location: **20-29N-4E**
 Township: **Allen**
 Acres: **651.88**
 Date: **4/11/2018**

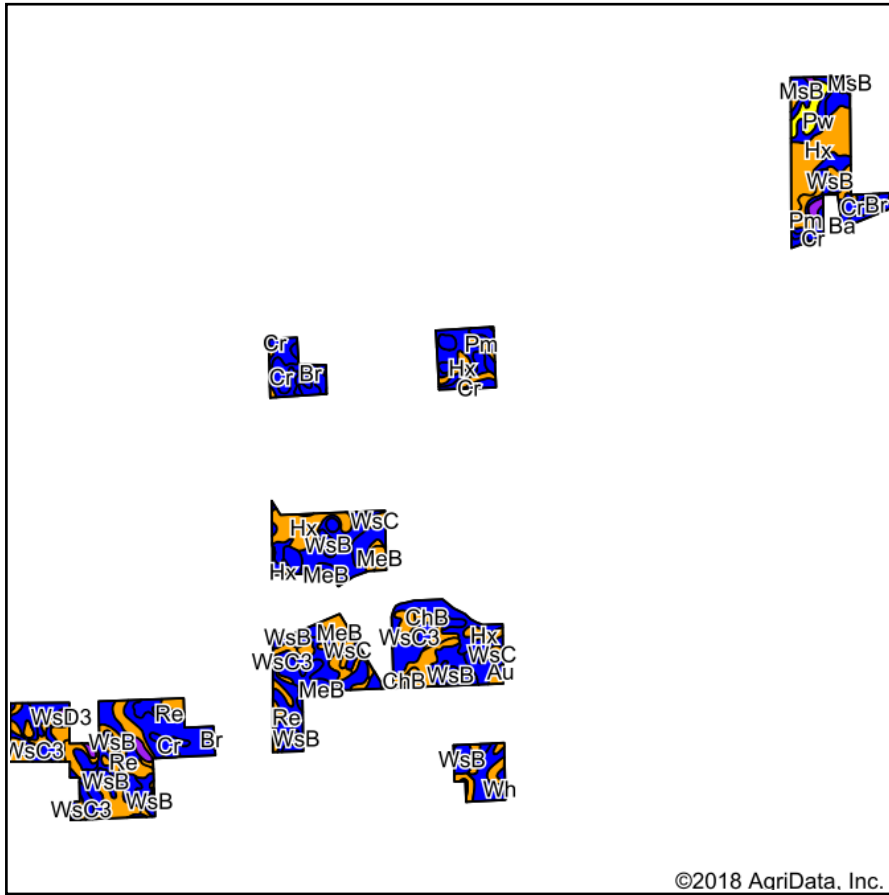

Soils data provided by USDA and NRCS.

©2018 AgriData, Inc.

Area Symbol: IN103, Soil Area Version: 21

Code	Soil Description	Acres	Percent of field	Non-Irr Class Legend	Water Table	Restrictive Layer	Soil Drainage	Non-Irr Class *c	Corn	Soybeans	Winter wheat
WsB	Wawasee sandy loam, 2 to 6 percent slopes	150.11	23.0%		> 6.5ft.	> 6.5ft.	Well drained	Ile	126	44	63
Re	Rensselaer loam	102.89	15.8%		0.7ft.	> 6.5ft.	Poorly drained	IIlw	172	48	69
Br	Brookston loam	91.53	14.0%		0.7ft.	> 6.5ft.	Poorly drained	IIlw	172	49	70
Hx	Houghton muck, drained	79.11	12.1%		0.7ft.	> 6.5ft.	Very poorly drained	IIIW	159	42	64
WsC3	Wawasee loam, 6 to 12 percent slopes, severely eroded	64.92	10.0%		> 6.5ft.	> 6.5ft.	Well drained	IIle	125	44	63
Cr	Crosier loam, 0 to 2 percent slopes	47.42	7.3%		2ft.	3.2ft. (Densic material)	Somewhat poorly drained	IIlw	154	50	69
MeB	Metea loamy fine sand, 2 to 6 percent slopes	35.57	5.5%		> 6.5ft.	> 6.5ft.	Well drained	IIle	110	39	55
WsC	Wawasee sandy loam, 6 to 12 percent slopes	10.22	1.6%		> 6.5ft.	> 6.5ft.	Well drained	IIle	130	46	65
MtC3	Morley silty clay loam, 6 to 12 percent slopes, severely eroded	10.16	1.6%		2.5ft.	2.4ft. (Densic material)	Moderately well drained	IVe	105	37	47
ChB	Chelsea fine sand, 2 to 9 percent slopes	9.76	1.5%		> 6.5ft.	> 6.5ft.	Excessively drained	IIIs	90	32	41
Wsd3	Wawasee loam, 12 to 18 percent slopes, severely eroded	9.01	1.4%		> 6.5ft.	> 6.5ft.	Well drained	VIle	110	39	55
Pw	Pewamo silty clay loam, 0 to 1 percent slopes	8.95	1.4%		0.5ft.	> 6.5ft.	Very poorly drained	IIlw	157	47	64
Pm	Palms muck, drained	8.09	1.2%		0.7ft.	> 6.5ft.	Very poorly drained	IIIW	158	43	63
OtA	Oshtemo sandy loam, 0 to 4 percent slopes	5.86	0.9%		> 6.5ft.	4.2ft. (Strongly contrasting textural stratification)	Well drained	IIIs	99	35	50
MsB	Glynwood silt loam, 2 to 6 percent slopes	5.41	0.8%		1.5ft.	2.8ft. (Densic material)	Moderately well drained	Ile	133	46	60



Au	Aubbeenaubbee sandy loam, 0 to 2 percent slopes	4.66	0.7%		1.2ft.	> 6.5ft.	Somewhat poorly drained	Ilw	135	44	61
Gr	Gilford sandy loam, till plain, 0 to 2 percent slopes	4.20	0.6%		3ft.	> 6.5ft.	Poorly drained	Illw	146	33	59
MtD3	Morley silty clay loam, 12 to 25 percent slopes, severely eroded	2.82	0.4%		2.5ft.	2.9ft. (Densic material)	Moderately well drained	Vle	75	26	34
Wh	Washtenaw silt loam	1.19	0.2%		0.2ft.	> 6.5ft.	Poorly drained	Ilw	165	49	66
Weighted Average									144.4	44.8	64.1

*c: Using Capabilities Class Dominant Condition Aggregation Method

Soils data provided by USDA and NRCS.