

# Soil Map

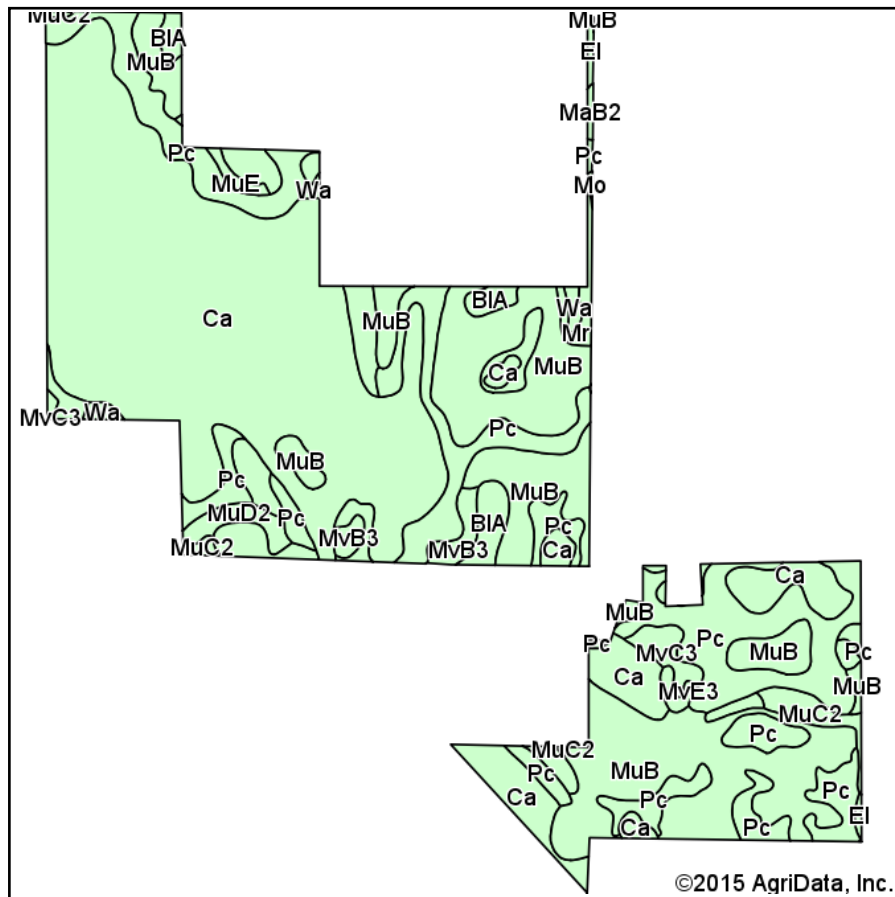

Soils data provided by USDA and NRCS.

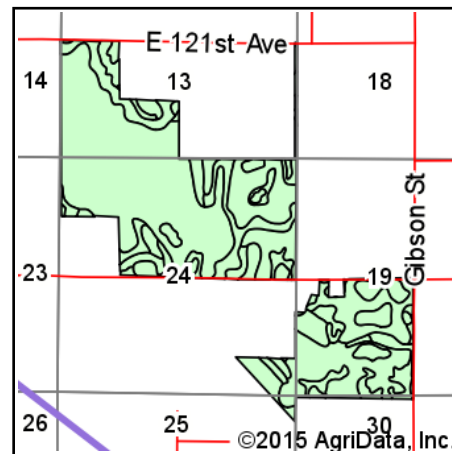

State: **Indiana**  
 County: **Lake**  
 Location: **24-34N-8W**  
 Township: **Winfield**  
 Acres: **579.31**  
 Date: **2/13/2015**

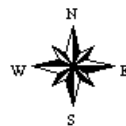

Maps Provided By:  
  
 CUSTOMIZED ONLINE MAPPING  
 © AgriData, Inc. 2014 www.AgriDataInc.com

## Area Symbol: IN089, Soil Area Version: 16

Code	Soil Description	Acres	Percent of field	Water Table	Restrictive Layer	Soil Drainage	Non-Irr Class	Corn	Soybeans	Winter wheat
Ca	Houghton muck, drained, 0 to 1 percent slopes	256.67	44.3%	0ft.	> 6.5ft.	Very poorly drained	Illw	150	40	60
MuB	Morley silt loam, 2 to 6 percent slopes	141.02	24.3%	2.7ft.	3ft. (Densic material)	Moderately well drained	Ile	122	43	55
Pc	Pewamo silty clay loam	120.42	20.8%	0.5ft.	> 6.5ft.	Poorly drained	Ilw	160	44	64
MuC2	Morley silt loam, 6 to 12 percent slopes, eroded	11.01	1.9%	2.7ft.	3ft. (Densic material)	Moderately well drained	Ille	108	38	49
BIA	Blount silt loam, Lake Michigan Lobe, 0 to 2 percent slopes	10.01	1.7%	1.1ft.	1.1ft. (Abrupt textural change)	Somewhat poorly drained	Ilw	124	42	51
Mr	Milford silty clay loam, 0 to 2 percent slopes	9.78	1.7%	0.5ft.	> 6.5ft.	Poorly drained	Ilw	149	49	50
MuD2	Morley silt loam, 12 to 18 percent slopes, eroded	8.02	1.4%	2.7ft.	3ft. (Densic material)	Moderately well drained	IVe	94	33	42
MvB3	Morley silty clay loam, 2 to 6 percent slopes, severely eroded	7.22	1.2%	2.4ft.	2.4ft. (Densic material)	Moderately well drained	Ille	108	38	49
MvC3	Morley silty clay loam, 6 to 12 percent slopes, severely eroded	6.45	1.1%	2.4ft.	2.4ft. (Densic material)	Moderately well drained	IVe	98	35	44
Wa	Wallkill silt loam	2.84	0.5%	0.2ft.	> 6.5ft.	Very poorly drained	Illw	165	49	66
MvE3	Morley silty clay loam, 18 to 25 percent slopes, severely eroded	1.82	0.3%	2.4ft.	2.4ft. (Densic material)	Well drained	VIe	70	24	36
MuE	Morley silt loam, 18 to 25 percent slopes	1.80	0.3%	3ft.	3ft. (Densic material)	Well drained	VIe			
El	Elliott silt loam, 0 to 2 percent slopes	1.36	0.2%	1.5ft.	3.4ft. (Densic material)	Somewhat poorly drained	Ilis	147	48	59
MaB2	Markham silt loam, 2 to 6 percent slopes, eroded	0.64	0.1%	2.2ft.	2.5ft. (Densic material)	Moderately well drained	Ile	122	41	55
Mo	Milford silt loam, overwash	0.25	0.0%	0.2ft.	> 6.5ft.	Very poorly drained	Ilw	160	44	64
Weighted Average								141.4	41.4	58.3

Area Symbol: IN089, Soil Area Version: 16

Soils data provided by USDA and NRCS.