

Soils Map

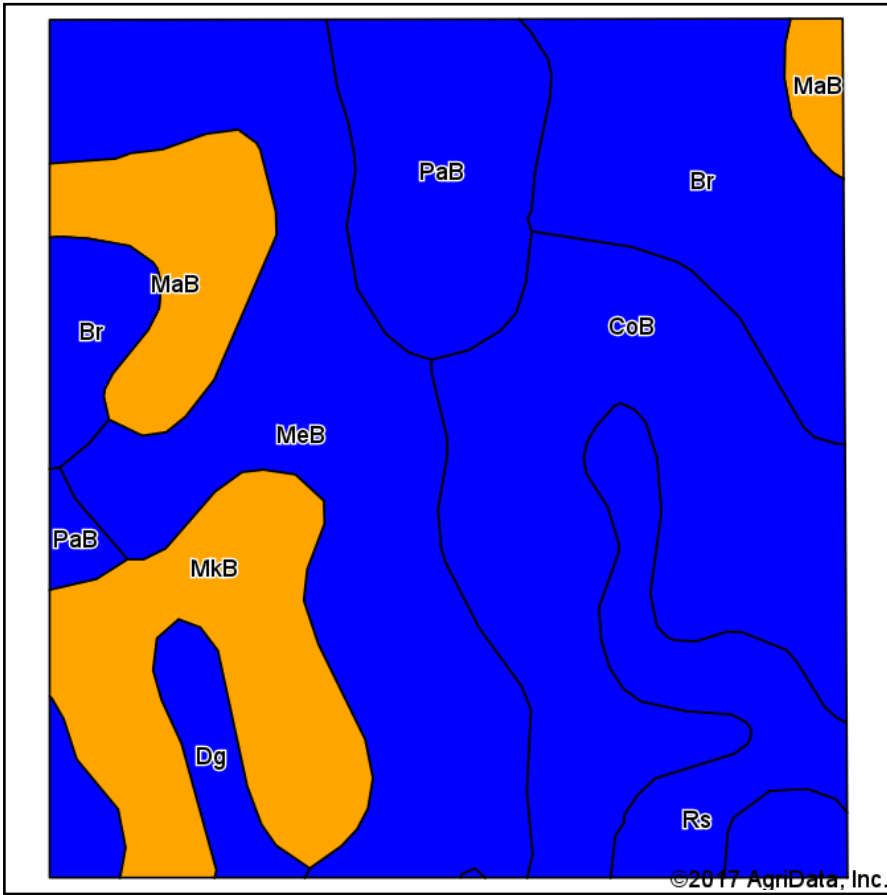

Soils data provided by USDA and NRCS.

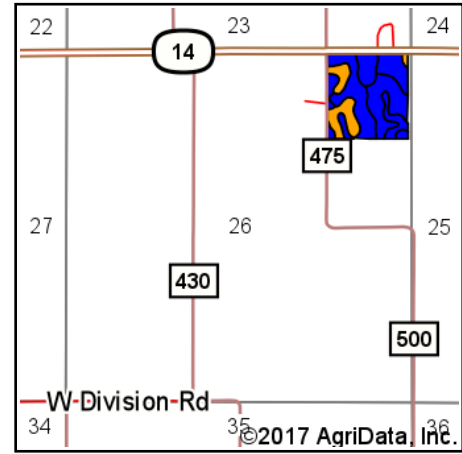

State: **Indiana**
 County: **Jasper**
 Location: **26-30N-5W**
 Township: **Gillam**
 Acres: **37.55**
 Date: **2/12/2017**



Maps Provided By:



© AgriData, Inc. 2017

www.AgriDataInc.com



Area Symbol: IN073, Soil Area Version: 17

Code	Soil Description	Acres	Percent of field	Non-Irr Class Legend	Water Table	Soil Drainage	Non-Irr Class *c	Corn	Soybeans	Winter wheat
MeB	Metamora fine sandy loam, moderately permeable, 1 to 4 percent slopes	9.10	24.2%		1.2ft.	Somewhat poorly drained	Ile	145	46	66
CoB	Corwin loam, moderately permeable, 1 to 3 percent slopes	8.89	23.7%		2.2ft.	Moderately well drained	Ile	145	48	66
Br	Brookston loam	5.35	14.2%		1.2ft.	Poorly drained	Ilw	172	49	70
MkB	Metea loamy sand, moderately permeable, 2 to 6 percent slopes	4.23	11.3%		> 6.5ft.	Well drained	Ille	103	37	52
PaB	Parr fine sandy loam, 2 to 6 percent slopes	3.57	9.5%		> 6.5ft.	Well drained	Ile	145	47	73
Rs	Rensselaer fine sandy loam, till substratum	2.55	6.8%		0.5ft.	Poorly drained	Ilw	170	47	68
MaB	Markton-Aubbeenaubee complex, 1 to 3 percent slopes	2.53	6.7%		1.2ft.	Somewhat poorly drained	Ille	132	41	60
Dg	Darroch, till substratum-Odell complex	1.33	3.5%		1.2ft.	Somewhat poorly drained	Ilw	155	48	69
Weighted Average								145.3	45.8	65.5

Area Symbol: IN073, Soil Area Version: 17

*c: Using Capabilities Class Dominant Condition Aggregation Method

Soils data provided by USDA and NRCS.

Soils Map

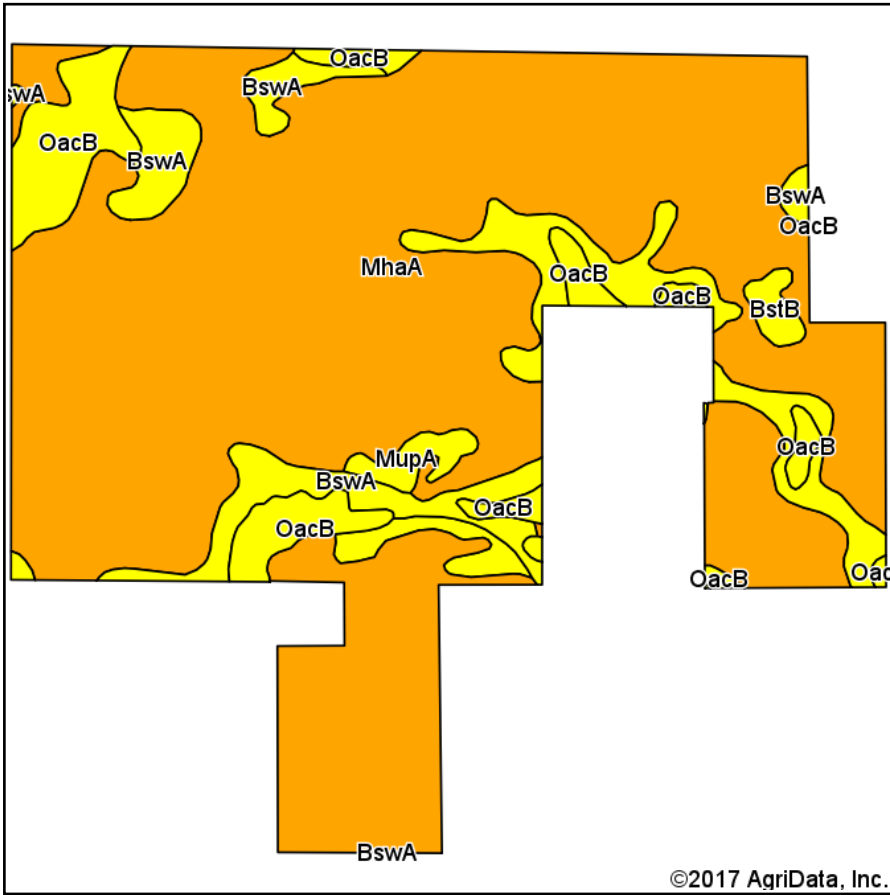

Soils data provided by USDA and NRCS.

©2017 AgriData, Inc.

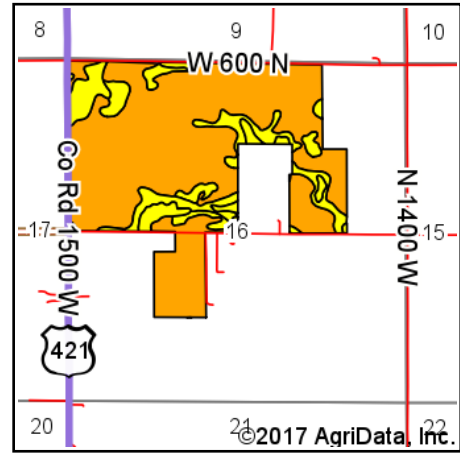

State: **Indiana**
 County: **Pulaski**
 Location: **16-31N-4W**
 Township: **Cass**
 Acres: **242.98**
 Date: **7/23/2017**



Maps Provided By:



© AgriData, Inc. 2017

www.AgriDataInc.com



Area Symbol: IN131, Soil Area Version: 18

Code	Soil Description	Acres	Percent of field	Non-Irr Class Legend	Water Table	Soil Drainage	Non-Irr Class *c	Corn	Soybeans	Winter wheat
MhaA	Maumee loamy fine sand, 0 to 1 percent slopes	192.92	79.4%		0.2ft.	Poorly drained	IIIw	133	28	54
BswA	Brems-Morocco loamy fine sands, 0 to 1 percent slopes	26.34	10.8%		2.5ft.	Moderately well drained	IVs	98	31	44
OacB	Oakville-Denham fine sands, 1 to 5 percent slopes	17.18	7.1%		3ft.	Excessively drained	IVs	84	30	38
MupA	Morocco loamy fine sand, 0 to 1 percent slopes	4.94	2.0%		1.5ft.	Somewhat poorly drained	IVs	102	28	46
BstB	Brems loamy fine sand, 1 to 4 percent slopes	1.60	0.7%		2.5ft.	Moderately well drained	IVs	97	33	44
Weighted Average								124.9	28.5	51.6

*c: Using Capabilities Class Dominant Condition Aggregation Method

Soils data provided by USDA and NRCS.