

Soils Map

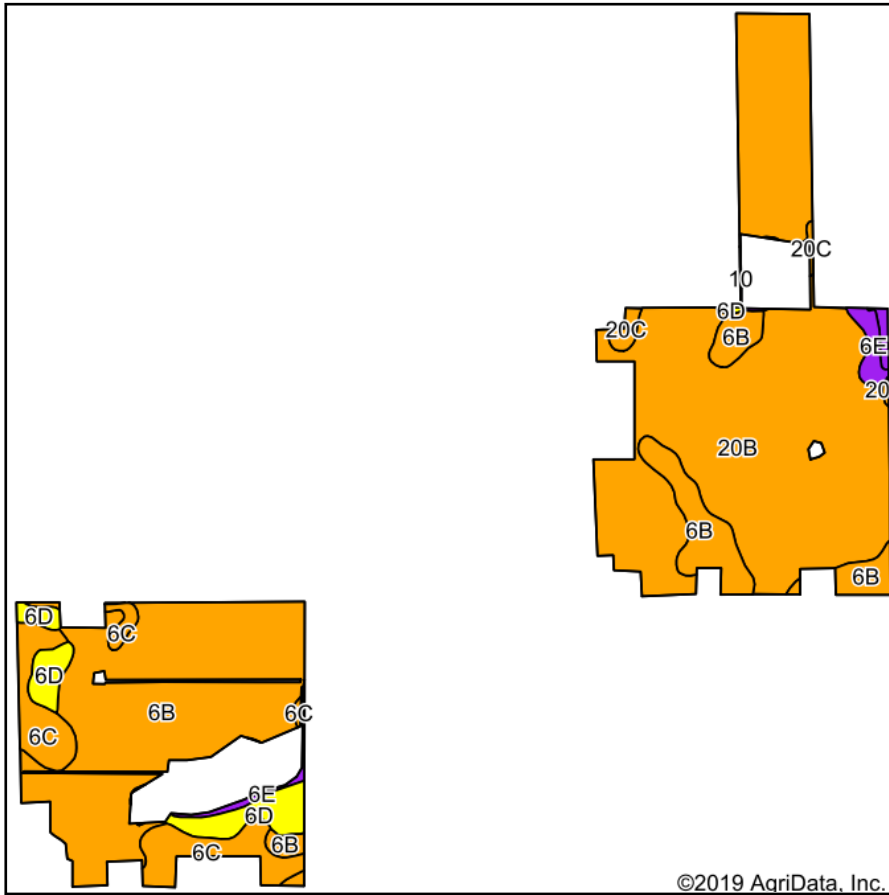

Soils data provided by USDA and NRCS.

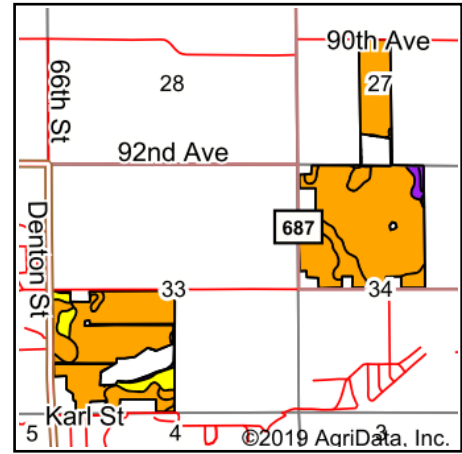

State: **Michigan**
 County: **Van Buren**
 Location: **33-4S-16W**
 Township: **Keeler**
 Acres: **292.31**
 Date: **10/14/2019**



Archived Soils Ending 1/21/2012															
Code	Soil Description	Acres	Percent of field	Non-Irr Class Legend	Water Table	Restrictive Layer	Soil Drainage	Non-Irr Class *c	Irr Class *c	Cor n	Corn Irrigated	Soybeans	Soybeans Irrigated	Winter wheat	
20B	Spinks loamy sand, 0 to 6 percent slopes	149.72	51.2%		0ft.	> 6.5ft.	Well drained	IIIIs	IIIIs	75	165	27	50	30	
6B	Oshtemo sandy loam, 0 to 6 percent slopes	101.81	34.8%		> 6.5ft.	> 6.5ft.	Well drained	IIIIs	IIIe	95	175	30	57	45	
6C	Oshtemo sandy loam, 6 to 12 percent slopes	20.55	7.0%		> 6.5ft.	> 6.5ft.	Well drained	IIIe	IIIe	90	165	26	50	40	
6D	Oshtemo-Coloma loamy sands, 12 to 18 percent slopes	12.35	4.2%		> 6.5ft.	> 6.5ft.	Well drained	IVe		80		21		35	
6E	Oshtemo-Coloma loamy sands, 18 to 25 percent slopes	4.59	1.6%		> 6.5ft.	> 6.5ft.	Well drained	Vle							
20C	Spinks loamy sand, 6 to 12 percent slopes	2.22	0.8%		0ft.	> 6.5ft.	Well drained	IIIe	IIIe	68	155	23	50	30	
10	Aquents and Histosols, ponded	1.07	0.4%		0ft.	> 6.5ft.	Very poorly drained	Vlw							
Weighted Average											81.7	158.2	27.2	49.4	35.6

*c: Using Capabilities Class Dominant Condition Aggregation Method
 Soils data provided by USDA and NRCS.

Soils Map

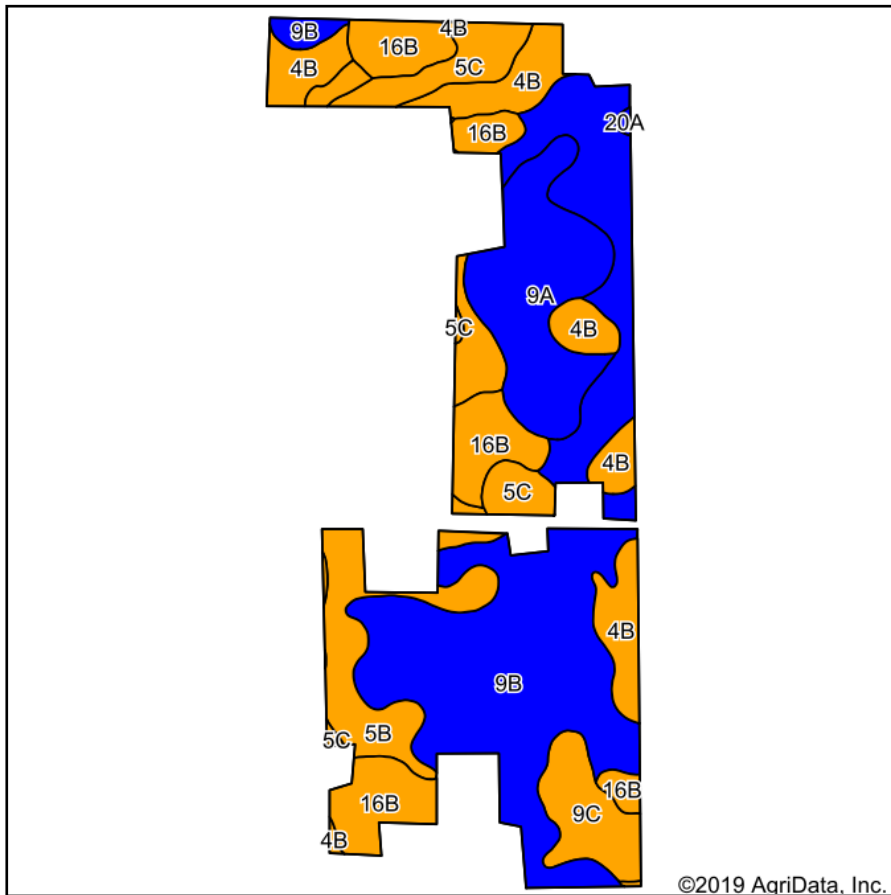

Soils data provided by USDA and NRCS.

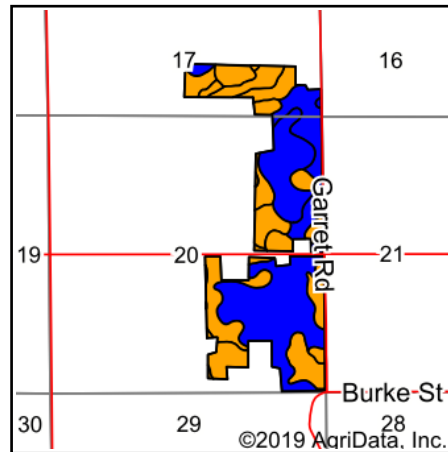

State: **Michigan**
 County: **Cass**
 Location: **20-5S-16W**
 Township: **Silver Creek**
 Acres: **219.04**
 Date: **10/14/2019**

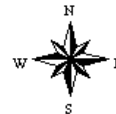

Archived Soils Ending 1/21/2012														
Code	Soil Description	Acres	Percent of field	Non-Irr Class Legend	Water Table	Restrictive Layer	Soil Drainage	Non-Irr Class *c	Irr Class *c	Corn	Corn Irrigated	Soybeans	Soybeans Irrigated	Winter wheat
9B	Kalamazoo loam, 2 to 6 percent slopes	89.97	41.1%		> 6.5ft.	> 6.5ft.	Well drained	Ile	Ile	100	175	30	55	40
9A	Kalamazoo loam, 0 to 2 percent slopes	28.89	13.2%		> 6.5ft.	> 6.5ft.	Well drained	Ils	Ils	110	175	30	55	40
16B	Ormas loamy sand, 0 to 6 percent slopes	26.79	12.2%		> 6.5ft.	> 6.5ft.	Well drained	Ille		80		28		36
4B	Oshtemo sandy loam, 2 to 6 percent slopes	26.01	11.9%		> 6.5ft.	> 6.5ft.	Well drained	Ills	Ille	100	175	30	57	45
5B	Spinks loamy sand, 0 to 6 percent slopes	23.66	10.8%		> 6.5ft.	> 6.5ft.	Well drained	Ills	Ills	75	165	27	50	30
5C	Spinks loamy sand, 6 to 12 percent slopes	12.46	5.7%		> 6.5ft.	> 6.5ft.	Well drained	Ille	Ille	68	155	23	50	30
9C	Kalamazoo loam, 6 to 12 percent slopes	10.92	5.0%		> 6.5ft.	> 6.5ft.	Well drained	Ille		85		27		38
20A	Bronson loamy sand, 0 to 3 percent slopes	0.34	0.2%		0.5ft.	> 6.5ft.	Moderately well drained	Ils	Ils	100	170	30	55	40
Weighted Average										93.6	142.6	28.9	44.9	38.4

*c: Using Capabilities Class Dominant Condition Aggregation Method
 Soils data provided by USDA and NRCS.