

Soils Map

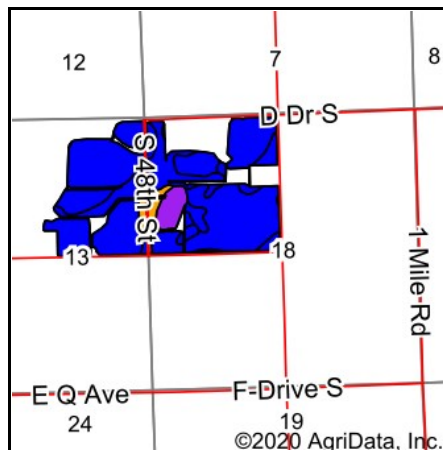

State: **Michigan**
 County: **Calhoun**
 Location: **18-3S-8W**
 Township: **Leroy**
 Acres: **202.12**
 Date: **10/19/2020**

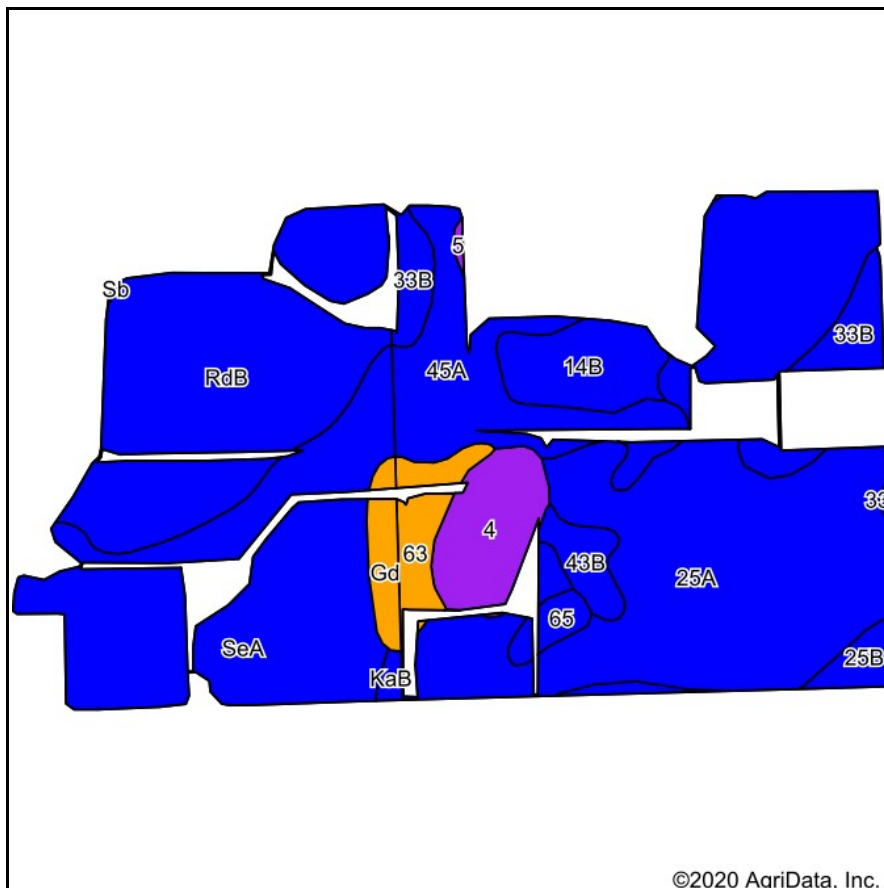
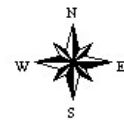

Soils data provided by USDA and NRCS.

Area Symbol: MI025, Soil Area Version: 18
 Area Symbol: MI077, Soil Area Version: 15

Code	Soil Description	Acres	Percent of field	Non-Irr Class Legend	Water Table	Non-Irr Class *c	Irr Class *c	Corn	Corn silage	Soybeans	Winter wheat	*n NCCPI Overall	*n NCCPI Soybeans
25A	Kalamazoo loam, 0 to 2 percent slopes	67.07	33.2%		> 6.5ft.	Ils	Ils					68	48
RdB	Riddles loam, 2 to 6 percent slopes	39.92	19.8%		> 6.5ft.	Ile		110	20	38	50	69	65
SeA	Sleeth loam, 0 to 3 percent slopes	39.41	19.5%		2ft.	Ilw		120		42	48	64	64
45A	Sleeth loam, 0 to 2 percent slopes	15.83	7.8%		2ft.	Ilw						73	64
4	Adrian muck, 0 to 1 percent slopes	8.38	4.1%		0.5ft.	V w						23	4
14B	Bronson sandy loam, 0 to 6 percent slopes	7.82	3.9%		2.7ft.	Ile	Ils					52	48
33B	Riddles loam, 0 to 6 percent slopes	7.36	3.6%		> 6.5ft.	Ile						72	65
63	Gilford fine sandy loam, 0 to 2 percent slopes, gravelly subsoil	4.47	2.2%		1ft.	Illw		150		42	60	51	22
43B	Brady sandy loam, 1 to 4 percent slopes	3.14	1.6%		2ft.	Ile						57	34
Gd	Gilford sandy loam, 0 to 2 percent slopes, gravelly subsoil	2.97	1.5%		0ft.	Illw		149		42	59	48	21
25B	Kalamazoo loam, 2 to 6 percent slopes	2.95	1.5%		> 6.5ft.	Ile	Ile					68	48
65	Sebewa loam, 0 to 2 percent slopes	1.90	0.9%		0ft.	Ilw						77	76
KaB	Kalamazoo loam, 2 to 6 percent slopes	0.65	0.3%		> 6.5ft.	Ile	Ile					68	48

Soils data provided by USDA and NRCS.



Code	Soil Description	Acres	Percent of field	Non-Irr Class Legend	Water Table	Non-Irr Class *c	Irr Class *c	Corn	Corn silage	Soybeans	Winter wheat	*n NCCPI Overall	*n NCCPI Soybeans
5	Palms muck, 0 to 1 percent slopes	0.25	0.1%		0.5ft.	V w						18	12
Weighted Average								50.6	4	17.2	21.4	*n 64.7	*n 53.6

Soil Map

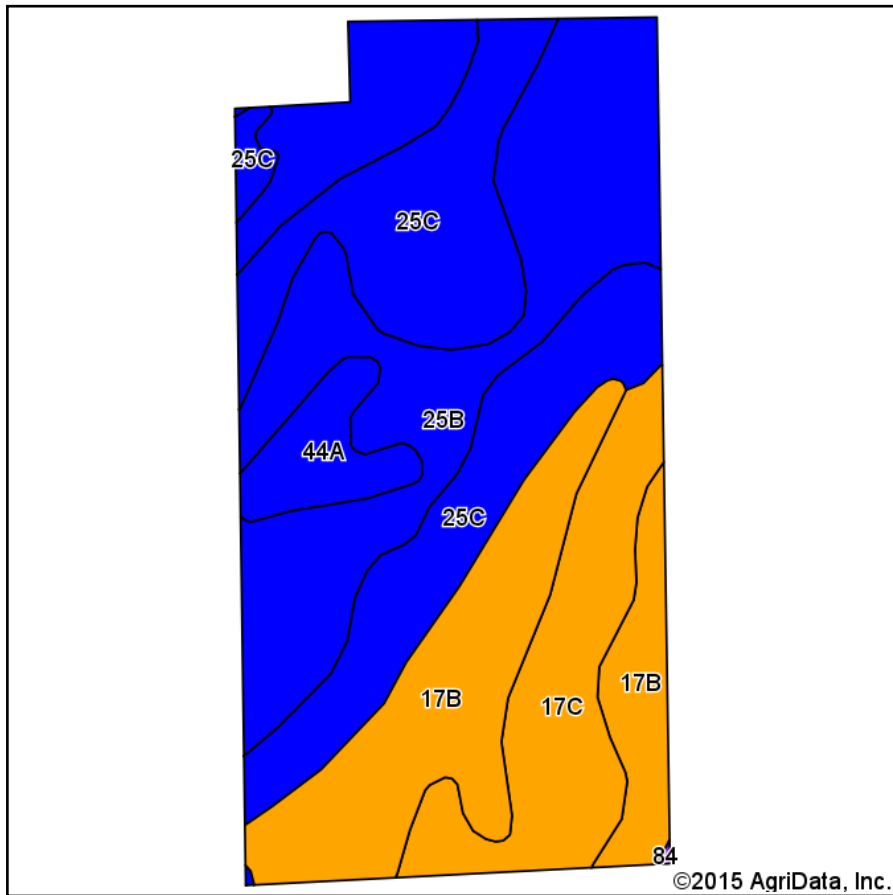

Soils data provided by USDA and NRCS.

©2015 AgriData, Inc.

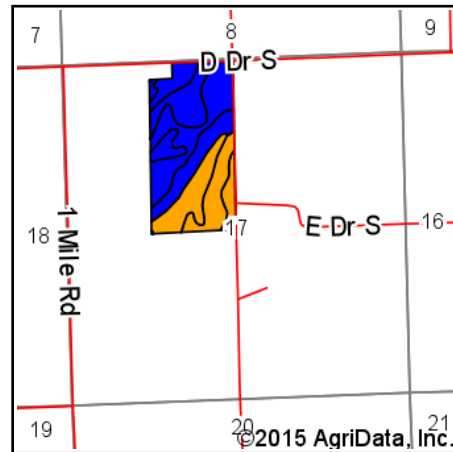

State: **Michigan**
 County: **Calhoun**
 Location: **17-3S-8W**
 Township: **Leroy**
 Acres: **77.84**
 Date: **12/8/2015**

Maps Provided By:

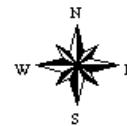

Area Symbol: MI025, Soil Area Version: 12

Code	Soil Description	Acres	Percent of field	Non-Irr Class Legend	Water Table	Soil Drainage	Non-Irr Class *c	Irr Class *c	Alfalfa hay	Corn	Corn Irrigated	Corn silage	Corn silage Irrigated	Oats	Soybeans	Soybeans Irrigated	Winter wheat
25B	Kalamazoo loam, 2 to 6 percent slopes	26.27	33.7%		> 6.5ft.	Well drained	Ile	Ile		1							
25C	Kalamazoo loam, 6 to 12 percent slopes	21.61	27.8%		> 6.5ft.	Well drained	Ile	Ile		1							
17B	Boyer sandy loam, 0 to 6 percent slopes	16.15	20.7%		> 6.5ft.	Well drained	Ills		4	72	165	13	24	58	27	50	31
17C	Boyer sandy loam, 6 to 12 percent slopes	10.42	13.4%		> 6.5ft.	Well drained	Ille		3	69	148	12	22	53	23	45	28
44A	Matherton loam, 0 to 3 percent slopes	3.39	4.4%		1.5ft.	Somewhat poorly drained	Ilw		5	107		17		86	32		40
Weighted Average									1.4	29.5	54	5	7.9	22.9	10.1	16.4	11.9

Area Symbol: MI025, Soil Area Version: 12

*c: Using Capabilities Class Dominant Condition Aggregation Method

Soils data provided by USDA and NRCS.