

Soil Map

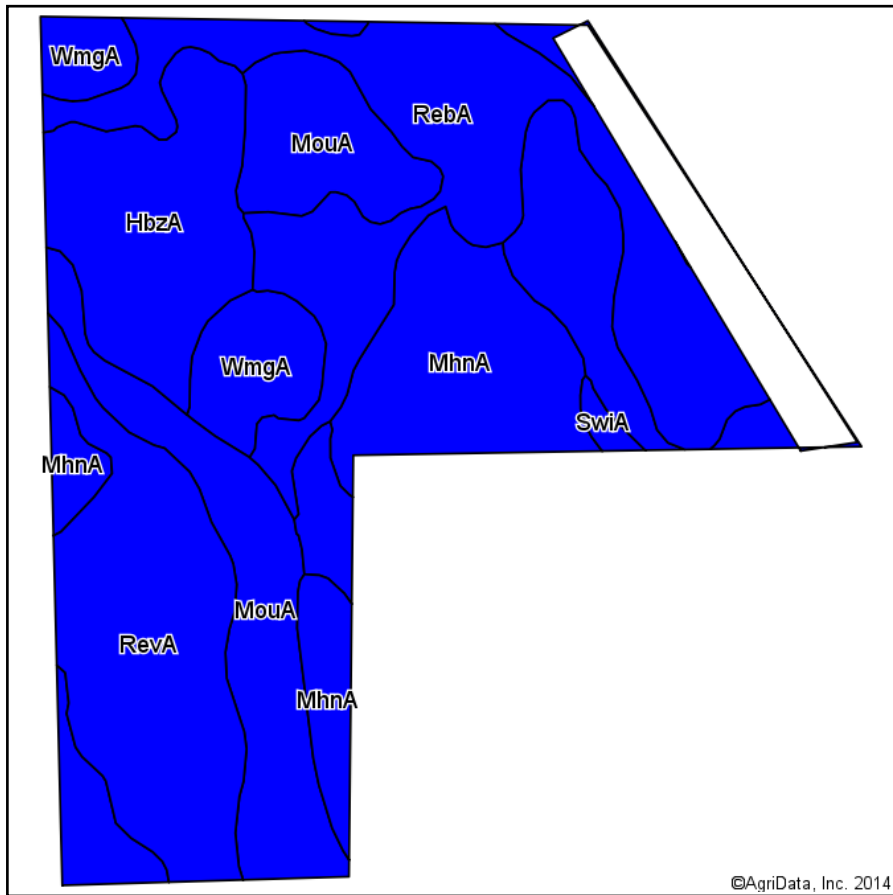

Soils data provided by USDA and NRCS.

©AgriData, Inc. 2014

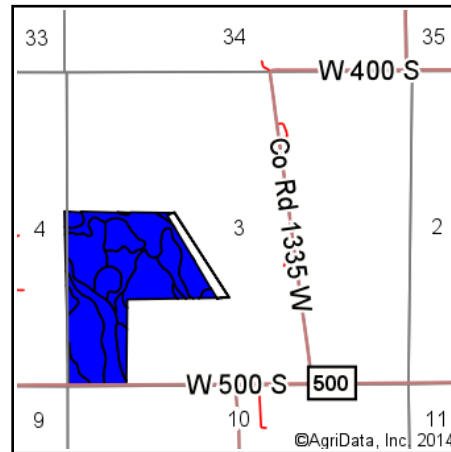

State: **Indiana**
 County: **Pulaski**
 Location: **3-29N-4W**
 Township: **Salem**
 Acres: **87.66**
 Date: **1/20/2015**

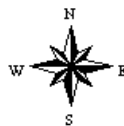

Maps Provided By:

 CUSTOMIZED ONLINE MAPPING
 © AgriData, Inc. 2014 www.AgriDataInc.com

Area Symbol: IN131, Soil Area Version: 15

Code	Soil Description	Acres	Percent of field	Non-Irr Class Legend	Water Table	Non-Irr Class	Irr Class	Corn	Corn Irrigated	Soybeans	Soybeans Irrigated	Winter wheat	
MouA	Milford silty clay loam, 0 to 1 percent slopes	22.83	26.0%		0ft.	Ilw		161		44		64	
RebA	Radioville-Mermill loams, 0 to 1 percent slopes	19.75	22.5%		0.2ft.	Ilw		171		49		69	
RevA	Rensselaer-Radioville loams, 0 to 1 percent slopes	16.08	18.3%		0.2ft.	Ilw		169		46		68	
MhnA	Medaryville fine sandy loam, 0 to 1 percent slopes	12.86	14.7%		1ft.	Ilw		147	5	41		2	65
HbzA	Headlee-Brady fine sandy loams, 0 to 1 percent slopes	10.56	12.0%		0.5ft.	Ilw		140	8	43		3	63
WmgA	Whiskerville-Bronson fine sandy loams, 0 to 1 percent slopes	5.14	5.9%		2ft.	Ils	Ils	126	144	41		47	56
SwiA	Strole silt loam, 0 to 1 percent slopes	0.44	0.5%		0.5ft.	Ilw		146	8	44		3	65
Weighted Average								158	10.2	44.8	3.4	65.4	

Area Symbol: IN131, Soil Area Version: 15

Field borders provided by Farm Service Agency as of 5/21/2008. Aerial photography provided by Aerial Photography Field Office.