

Soils Map

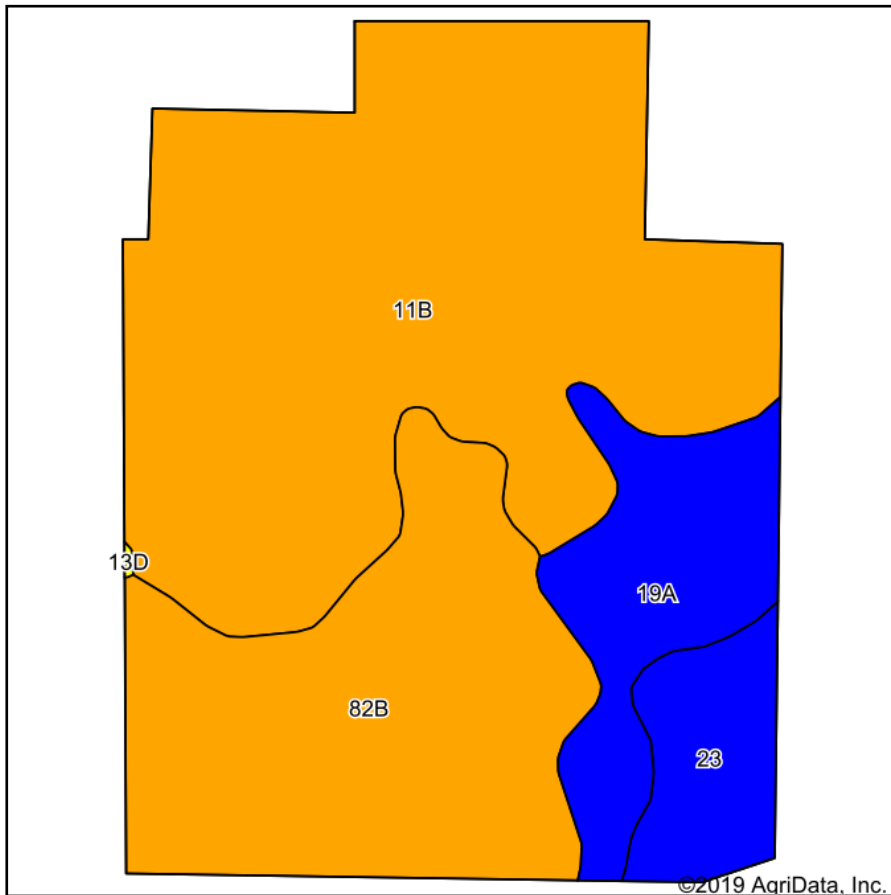

Soils data provided by USDA and NRCS.

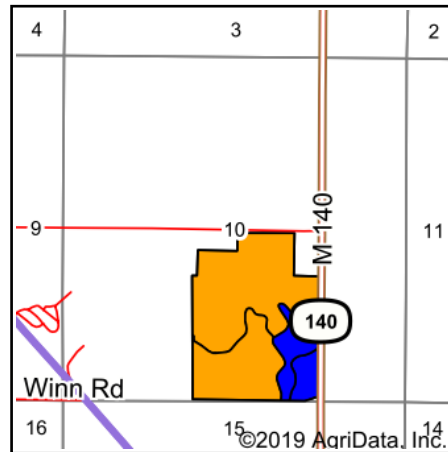

State: **Michigan**
 County: **Berrien**
 Location: **10-7S-17W**
 Township: **Niles**
 Acres: **104.74**
 Date: **2/19/2020**



Archived Soils Ending 1/21/2012

Code	Soil Description	Acres	Percent of field	Non-Irr Class Legend	Non-Irr Class *c	Irr Class *c	Alfalfa hay	Alfalfa hay Irrigated	Corn	Corn Irrigated	Corn silage	Corn silage Irrigated	Oats	Soybeans	Soybeans Irrigated	Winter wheat
11B	Oshtemo sandy loam, 0 to 6 percent slopes	56.26	53.7%		III s	III e	3.5	8	95	175	10	27	80	30	57	45
82B	Oshtemo-Ockley complex, 0 to 4 percent slopes	29.64	28.3%		III s	III e	3.5	8	95	175	10	27	80	30	57	45
19A	Brady sandy loam, 0 to 2 percent slopes	12.24	11.7%		II w		4.5		115		19		95	33		50
23	Sebewa loam	6.60	6.3%		II w		4.8		115		19		95	36		55
Weighted Average							3.7	6.6	98.6	143.5	11.6	22.1	82.7	30.7	46.7	46.2

*c: Using Capabilities Class Dominant Condition Aggregation Method
 Soils data provided by USDA and NRCS.