

# Soils Map

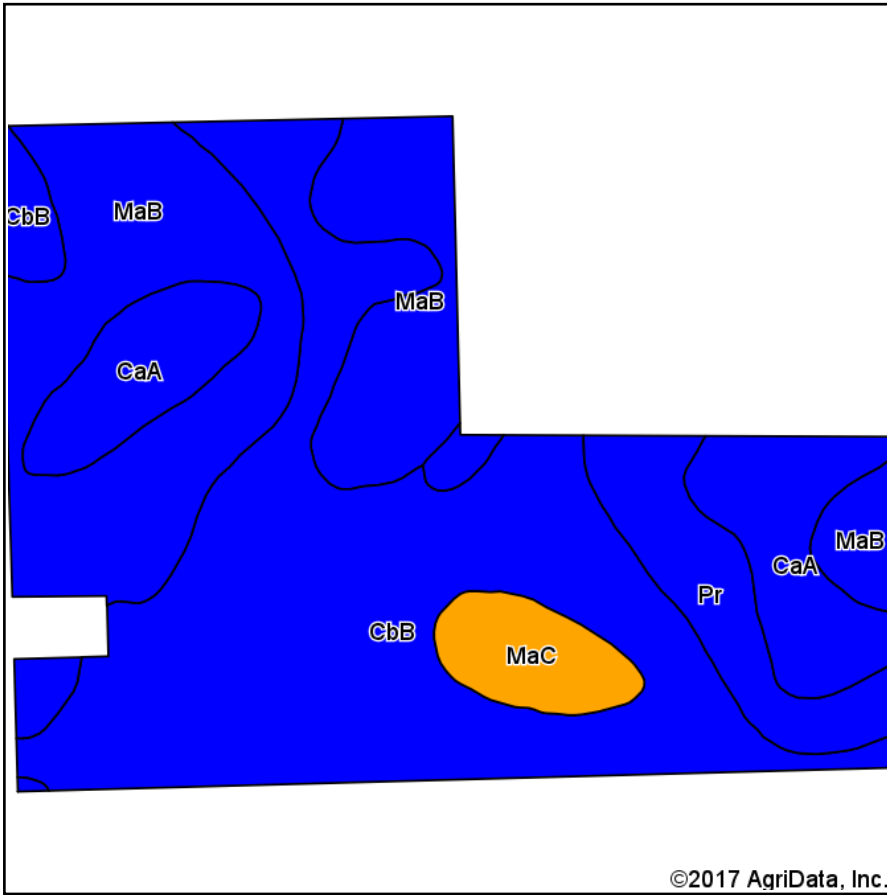

Soils data provided by USDA and NRCS.

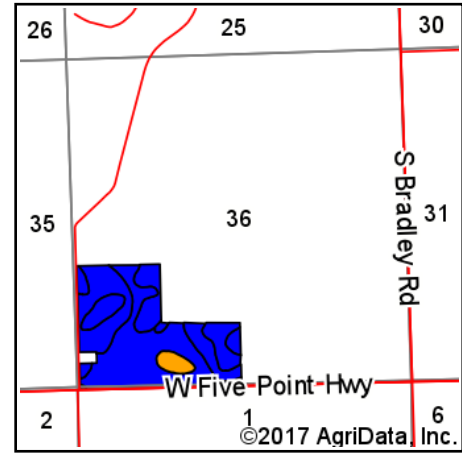

State: **Michigan**  
 County: **Eaton**  
 Location: **36-2N-6W**  
 Township: **Kalamo**  
 Acres: **86.83**  
 Date: **4/6/2017**



Maps Provided By:



© AgriData, Inc. 2017

www.AgriDataInc.com



## Archived Soils Ending 11/15/2015

Area Symbol: MI045, Soil Area Version: 10

Code	Soil Description	Acres	Percent of field	Non-Irr Class Legend	Water Table	Soil Drainage	Non-Irr Class *c	Alfalfa hay	Alfalfa hay Irrigated	Corn	Corn Irrigated	Corn silage	Corn silage Irrigated	Oats	Soybeans	Winter wheat
CbB	Capac-Marlette loams, 1 to 6 percent slopes	38.90	44.8%		4.2ft.	Somewhat poorly drained	Ile	5.5	6.8	110	155	17	26	95	36	62
MaB	Marlette loam, 2 to 6 percent slopes	26.80	30.9%		4.5ft.	Moderately well drained	Ile									
CaA	Capac loam, 0 to 3 percent slopes	10.77	12.4%		1.5ft.	Somewhat poorly drained	Ilw	5.5	7	120	155	18	26	100	40	65
Pr	Parkhill loam	6.82	7.9%		0ft.	Poorly drained	Ilw	4.2		140		22		115	45	65
MaC	Filer loam, 6 to 12 percent slopes	3.54	4.1%		> 6.5ft.	Well drained	Ille									
<b>Weighted Average</b>								<b>3.5</b>	<b>3.9</b>	<b>75.2</b>	<b>88.7</b>	<b>11.6</b>	<b>14.9</b>	<b>64</b>	<b>24.6</b>	<b>40.9</b>

\*c: Using Capabilities Class Dominant Condition Aggregation Method

Soils data provided by USDA and NRCS.