

Soils Map

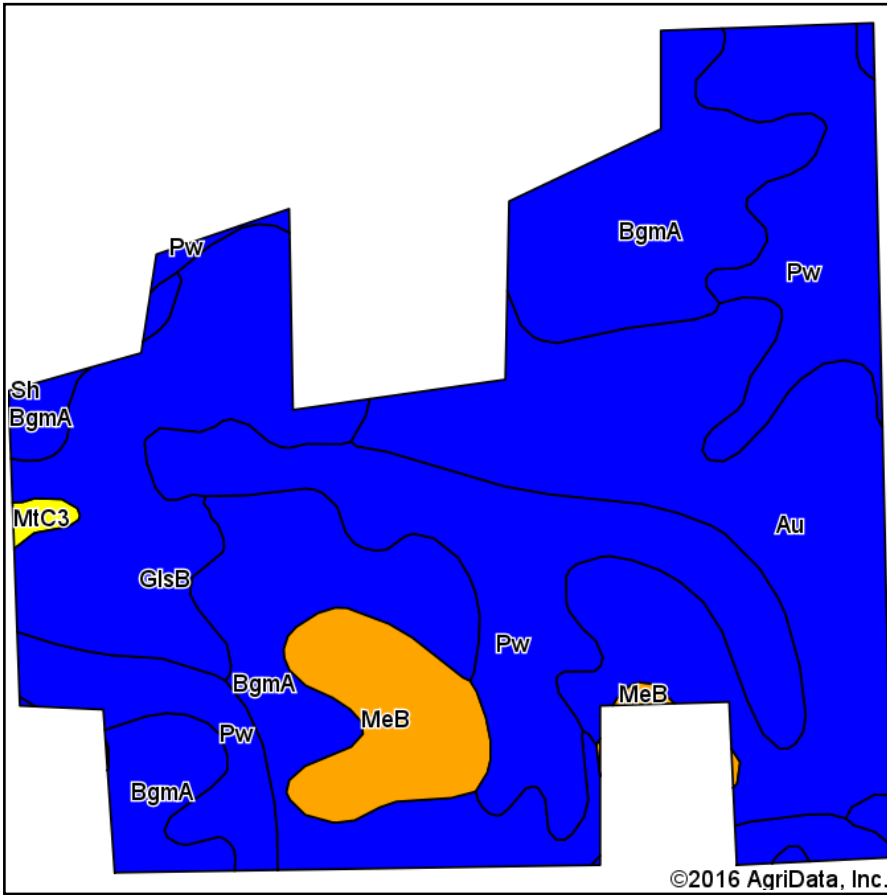

Soils data provided by USDA and NRCS.

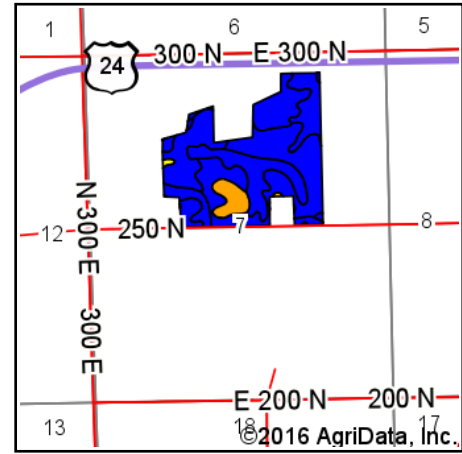

State: **Indiana**
 County: **Miami**
 Location: **7-27N-5E**
 Township: **Erie**
 Acres: **91.7**
 Date: **9/8/2016**



Area Symbol: IN103, Soil Area Version: 19

Code	Soil Description	Acres	Percent of field	Non-Irr Class Legend	Water Table	Soil Drainage	Non-Irr Class *c	Corn	Soybeans	Winter wheat
Pw	Pewamo silty clay loam, 0 to 1 percent slopes	26.72	29.1%		0.5ft.	Very poorly drained	IIw	157	47	64
BgmA	Blount silt loam, ground moraine, 0 to 2 percent slopes	24.10	26.3%		0.7ft.	Somewhat poorly drained	IIw	141	45	63
Au	Aubbeenaubee sandy loam, 0 to 2 percent slopes	22.80	24.9%		1.2ft.	Somewhat poorly drained	IIw	135	44	61
GlsB	Glynwood silt loam, ground moraine, 2 to 6 percent slopes	12.36	13.5%		1.5ft.	Moderately well drained	IIe	132	46	59
MeB	Metea loamy fine sand, 2 to 6 percent slopes	5.35	5.8%		> 6.5ft.	Well drained	IIIe	110	39	55
MtC3	Morley silty clay loam, 6 to 12 percent slopes, severely eroded	0.37	0.4%		2.5ft.	Moderately well drained	IVe	105	37	47
Weighted Average								141	45.1	61.7

Area Symbol: IN103, Soil Area Version: 19

*c: Using Capabilities Class Dominant Condition Aggregation Method

Soils data provided by USDA and NRCS.