

# Soils Map

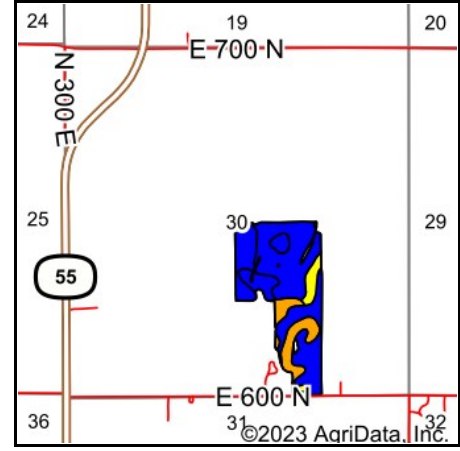

State: **Indiana**  
 County: **Warren**  
 Location: **30-23N-7W**  
 Township: **Adams**  
 Acres: **54.6**  
 Date: **4/4/2023**

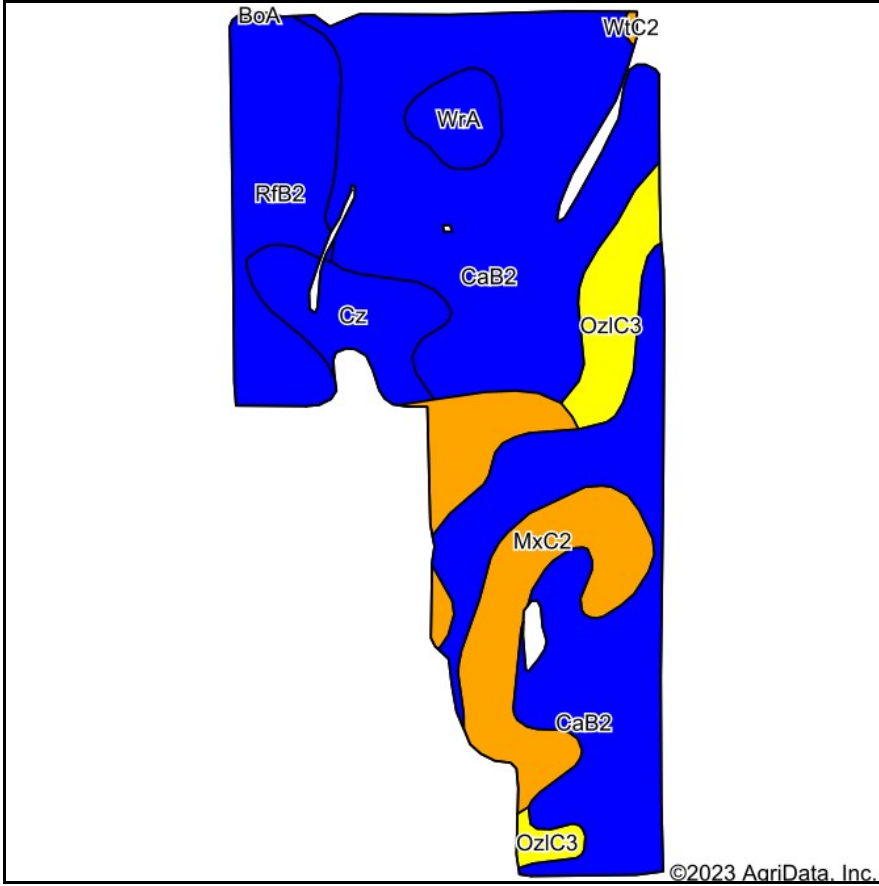

Soils data provided by USDA and NRCS.

Area Symbol: IN171, Soil Area Version: 25

Code	Soil Description	Acres	Percent of field	Non-Irr Class Legend	Water Table	Restrictive Layer	Soil Drainage	Non-Irr Class *c	Corn Bu	Soybeans Bu	Winter wheat Bu	*n NCCPI Corn	*n NCCPI Soybeans
CaB2	Cadiz silt loam, moderately wet, 1 to 6 percent slopes, eroded	31.54	57.8%		2.2ft.	3ft. (Densic material)	Moderately well drained	Ile	131	46	59	70	51
MxC2	Morley-Cadiz silt loams, moderately wet, 6 to 12 percent slopes, eroded	7.84	14.4%		2.5ft.	2.4ft. (Densic material)	Moderately well drained	IIle	121	42	54	62	44
RfB2	Rainsville-Williamstown-Rockfield silt loams, 2 to 6 percent slopes, eroded	6.95	12.7%		2.2ft.	4.6ft. (Densic material)	Moderately well drained	Ile	133	47	60	76	58
Cz	Cyclone silty clay loam, 0 to 2 percent slopes	3.45	6.3%		0.2ft.	> 6.5ft.	Poorly drained	IIw	185	65	75	87	81
OzlC3	Ozaukee silty clay loam, 6 to 12 percent slopes, severely eroded	3.23	5.9%		2.4ft.	2.1ft. (Densic material)	Moderately well drained	Ive	105	33	42	41	27
WrA	Williamsport-Elliott silt loams, 0 to 2 percent slopes	1.52	2.8%		1.2ft.	4.2ft. (Densic material)	Somewhat poorly drained	IIw	151	46	68	86	73

Soils data provided by USDA and NRCS.



Code	Soil Description	Acres	Percent of field	Non-Irr Class Legend	Water Table	Restrictive Layer	Soil Drainage	Non-Irr Class *c	Corn Bu	Soybeans Bu	Winter wheat Bu	*n NCCPI Corn	*n NCCPI Soybeans
WtC2	Williamstown-Rainsville silt loams, 6 to 12 percent slopes, eroded	0.07	0.1%		2ft.	2.9ft. (Densic material)	Moderately well drained	lle	122	43	55	67	49
<b>Weighted Average</b>								<b>2.26</b>	<b>132.2</b>	<b>46</b>	<b>58.7</b>	<b>*n 69.4</b>	<b>*n 52</b>

\*n: The aggregation method is "Weighted Average using all components"

\*c: Using Capabilities Class Dominant Condition Aggregation Method