

Soils Map

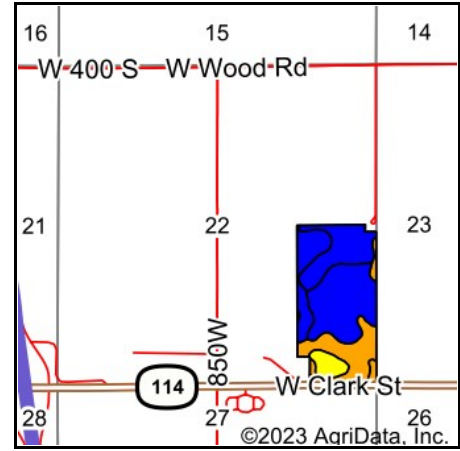

State: **Indiana**
 County: **Jasper**
 Location: **22-29N-7W**
 Township: **Newton**
 Acres: **76.72**
 Date: **3/24/2023**

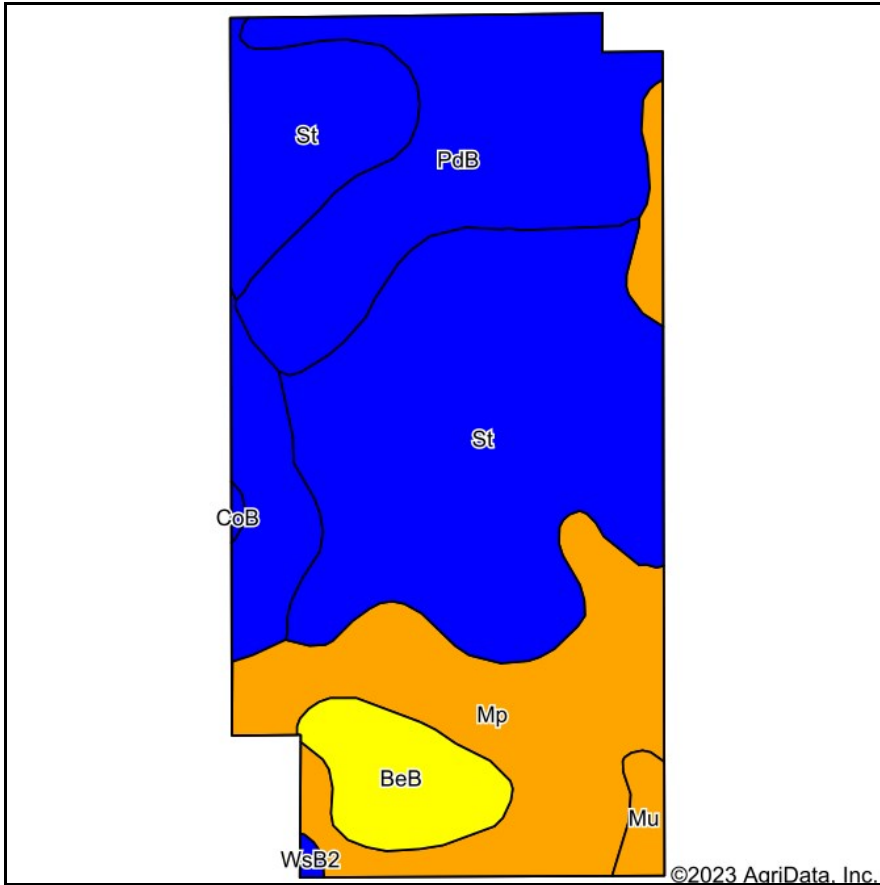

Soils data provided by USDA and NRCS.

Archived Soils Ending 1/21/2012

| Code | Soil Description | Acres | Percent of field | Non-Irr Class Legend | Water Table | Restrictive Layer | Soil Drainage | Non-Irr Class *c | Com Bu | Soybeans Bu | Winter wheat Bu |
|-------------------------|--|-------|------------------|----------------------|-------------|--------------------------|-------------------------|------------------|--------------|-------------|-----------------|
| St | Strole clay loam | 33.55 | 43.7% | Blue | 1.2ft. | > 6.5ft. | Somewhat poorly drained | IIw | 145 | 44 | 65 |
| Mp | Montgomery silty clay loam | 16.96 | 22.1% | Orange | 0.5ft. | 1.8ft. (Densic material) | Very poorly drained | IIIw | 160 | 44 | 64 |
| PdB | Parr-Ayr complex, 2 to 6 percent slopes | 16.02 | 20.9% | Blue | > 6.5ft. | 2.6ft. (Densic material) | Well drained | Ile | 140 | 46 | 70 |
| BeB | Brems loamy sand, 1 to 3 percent slopes | 4.61 | 6.0% | Yellow | 2.5ft. | > 6.5ft. | Moderately well drained | IVs | 95 | 33 | 43 |
| Re | Rensselaer loam | 4.25 | 5.5% | Blue | 0ft. | > 6.5ft. | Poorly drained | IIw | 172 | 48 | 69 |
| Mu | Morocco loamy sand | 1.04 | 1.4% | Orange | 1ft. | > 6.5ft. | Somewhat poorly drained | IIIs | 100 | 28 | 45 |
| WsB2 | Wawasee loam, 2 to 6 percent slopes, eroded | 0.17 | 0.2% | Blue | > 6.5ft. | > 6.5ft. | Well drained | Ile | 140 | 49 | 70 |
| CoB | Corwin loam, moderately permeable, 1 to 3 percent slopes | 0.12 | 0.2% | Blue | 2.2ft. | 3.3ft. (Densic material) | Moderately well drained | Ile | 155 | 51 | 70 |
| Weighted Average | | | | | | | | 2.35 | 145.2 | 43.8 | 64.5 |

*c: Using Capabilities Class Dominant Condition Aggregation Method