

Soils Map

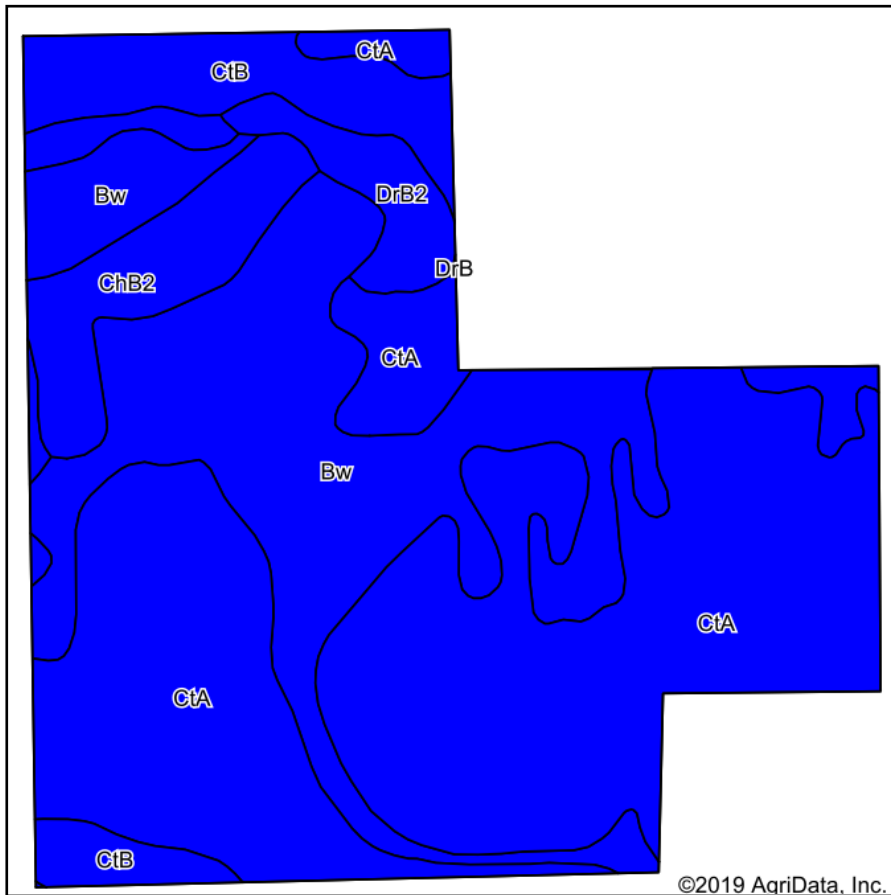

Soils data provided by USDA and NRCS.

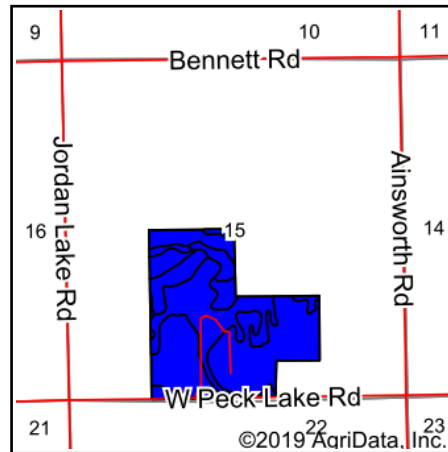

State: **Michigan**
 County: **Ionia**
 Location: **15-6N-7W**
 Township: **Berlin**
 Acres: **118.92**
 Date: **12/27/2019**



Maps Provided By:



Archived Soils Ending 1/21/2012

Code	Soil Description	Acres	Percent of field	Non-Irr Class Legend	Water Table	Restrictive Layer	Soil Drainage	Non-Irr Class *c	Corn	Corn Irrigated	Soybeans	Winter wheat
CtA	Conover loam, 0 to 2 percent slopes	62.30	52.4%		1.5ft.	> 6.5ft.	Somewhat poorly drained	llw	130		40	65
Bw	Brookston loam	34.85	29.3%		0ft.	> 6.5ft.	Very poorly drained	llw	145		51	65
CtB	Conover loam, 2 to 6 percent slopes	9.49	8.0%		1.5ft.	> 6.5ft.	Somewhat poorly drained	lle	120		36	60
ChB2	Celina loam, 2 to 6 percent slopes, moderately eroded	8.56	7.2%		4.2ft.	> 6.5ft.	Well drained	lle	120	160		60
DrB2	Dryden sandy loam, 2 to 6 percent slopes, moderately eroded	3.72	3.1%		2.5ft.	> 6.5ft.	Moderately well drained	lle	95		27	45
Weighted Average									131.8	11.5	39.6	63.6

*c: Using Capabilities Class Dominant Condition Aggregation Method

Soils data provided by USDA and NRCS.