

Soils Map

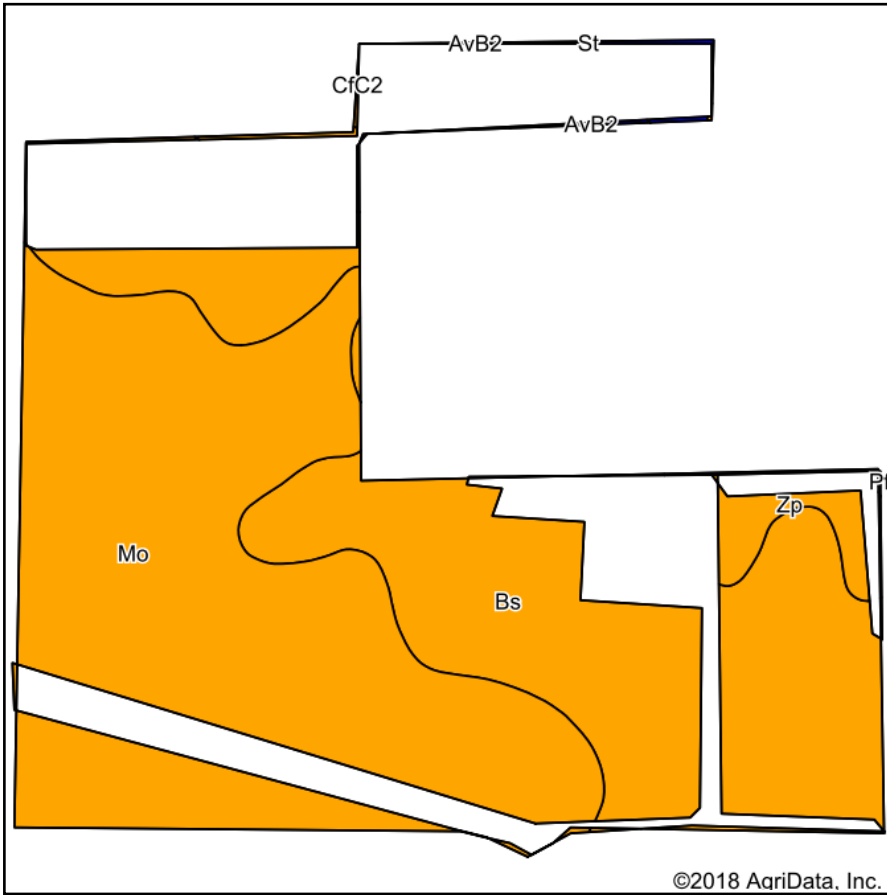

Soils data provided by USDA and NRCS.

©2018 AgriData, Inc.

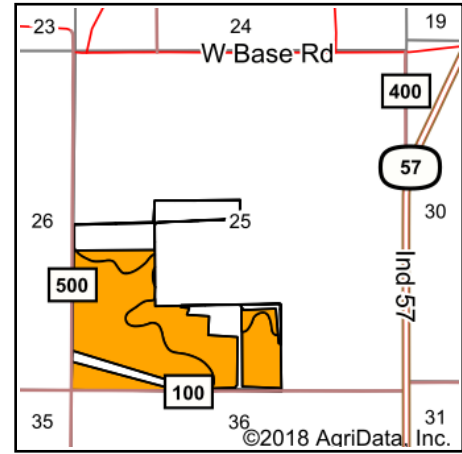

State: **Indiana**
 County: **Greene**
 Location: **25-7N-6W**
 Township: **Fairplay**
 Acres: **108.22**
 Date: **1/10/2019**



Area Symbol: IN055, Soil Area Version: 22

Code	Soil Description	Acres	Percent of field	Non-Irr Class Legend	Water Table	Restrictive Layer	Soil Drainage	Non-Irr Class *c	Corn	Soybeans	Winter wheat	*n NCCPI Soybeans
Mo	Montgomery silty clay loam	60.98	56.3%		0ft.	> 6.5ft.	Poorly drained	IIIw	146	41	58	75
Bs	Booker mucky clay	43.96	40.6%		0ft.	> 6.5ft.	Very poorly drained	IIIw	170	40	68	64
Zp	Zipp silty clay	2.77	2.6%		0ft.	> 6.5ft.	Poorly drained	IIIw	155	39	62	57
St	Stendal silt loam, frequently flooded	0.26	0.2%		0.5ft.	> 6.5ft.	Somewhat poorly drained	IIw	125	37	1	53
AvB2	Ava silt loam, 2 to 6 percent slopes, eroded	0.16	0.1%		2.5ft.	2.2ft. (Fragipan)	Moderately well drained	Ile	131	46	59	28
CfC2	Cincinnati silt loam, Wabash Lowland, 6 to 12 percent slopes, eroded	0.09	0.1%		2.5ft.	2.1ft. (Fragipan)	Well drained	IIle	116	40	52	26
Weighted Average									155.9	40.5	62	*n 69.9

*n: The aggregation method is "Weighted Average using major components"

*c: Using Capabilities Class Dominant Condition Aggregation Method

Soils data provided by USDA and NRCS.

Soils Map

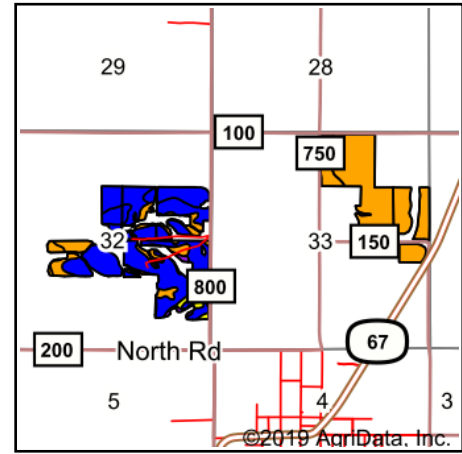
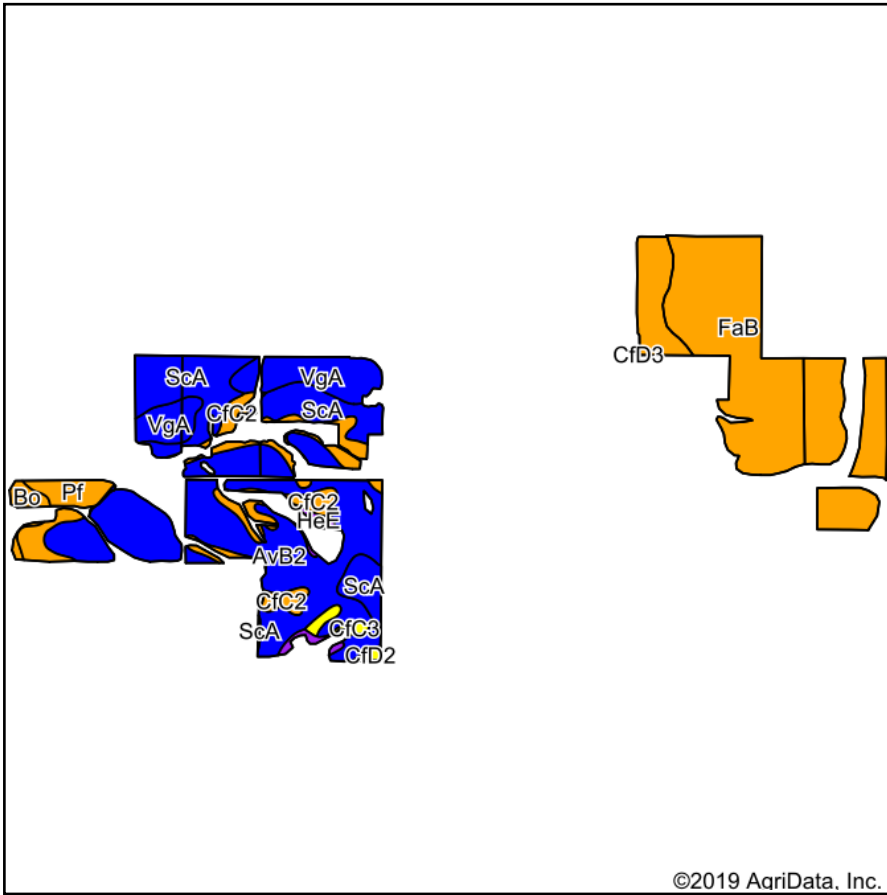

State: **Indiana**
 County: **Greene**
 Location: **33-7N-6W**
 Township: **Grant**
 Acres: **232.84**
 Date: **2/19/2019**



Soils data provided by USDA and NRCS.

Area Symbol: IN055, Soil Area Version: 22

Cod e	Soil Description	Acres	Percent of field	Non-Irr Class Legend	Non-Irr Class *c	Corn	Grass legume hay	Pasture	Soybeans	Winter wheat	Alfalfa hay	Tobacco	*n NCCPI Soybeans
FaB	Fairpoint silt loam, reclaimed, 2 to 8 percent slopes	85.05	36.5%		IIIe	145	5	10	51	73	3		40
AvB 2	Ava silt loam, 2 to 6 percent slopes, eroded	68.13	29.3%		IIe	131	4	9	46	59	5		28
ScA	Shakamak silt loam, 1 to 3 percent slopes	30.75	13.2%		IIe	130	4	9	46	59	5		55
VgA	Vigo silt loam, 0 to 2 percent slopes	17.93	7.7%		IIw	150	5	10	49	68			84
Cfc2	Cincinnati silt loam, Wabash Lowland, 6 to 12 percent slopes, eroded	15.55	6.7%		IIIe	116	4	8	40	52	4	3190	26
Pf	Peoga silt loam, 0 to 1 percent slopes	8.33	3.6%		IIIw	142	4	10	50	57			83
Bo	Bonnie silt loam, frequently flooded	2.43	1.0%		IIIw	135			39				52
HeE	Hickory silt loam, 18 to 25 percent slopes	2.20	0.9%		VIe		3	7					49
Cfc3	Cincinnati silt loam, Wabash Lowland, 6 to 12 percent slopes, severely eroded	1.83	0.8%		IVe	102	3	7	36	46	4	130	17
Cfd2	Cincinnati silt loam, 12 to 18 percent slopes, eroded	0.64	0.3%		IVe	110	4	7	39	50			47
Weighted Average						135.4	4.4	9.3	47.2	63	3.5	214.1	*n 42.5

*n: The aggregation method is "Weighted Average using major components"

*c: Using Capabilities Class Dominant Condition Aggregation Method

Soils data provided by USDA and NRCS.