

Soils Map

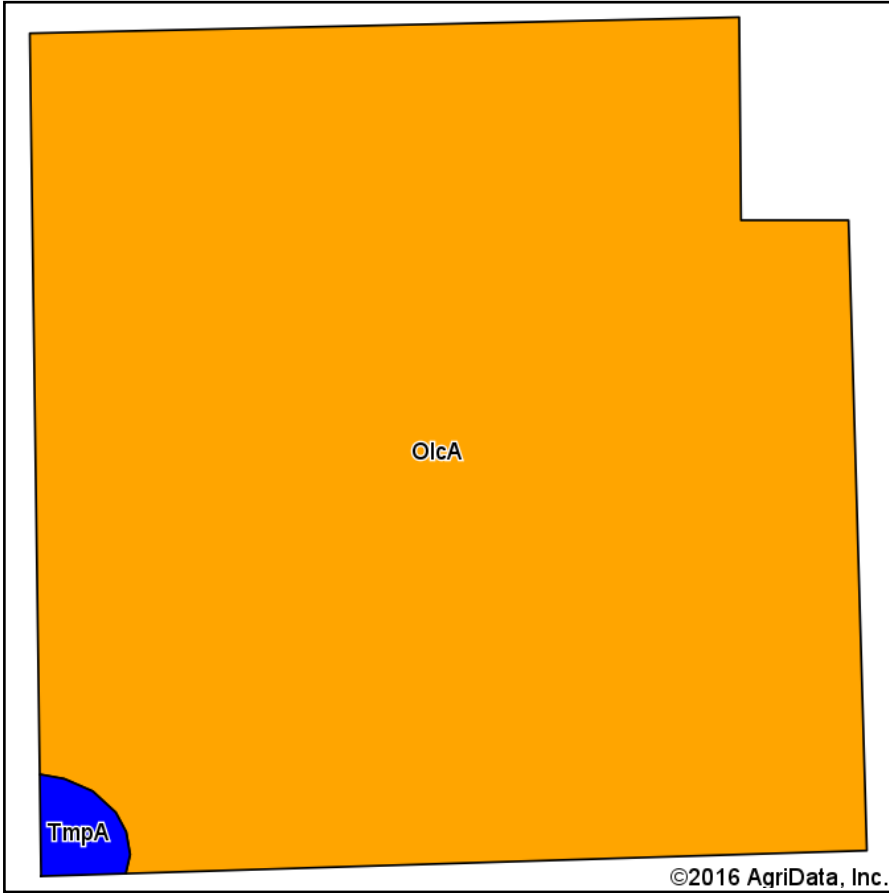

Soils data provided by USDA and NRCS.

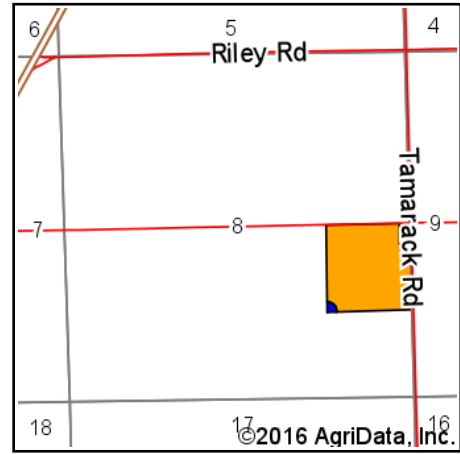

State: **Indiana**
 County: **St Joseph**
 Location: **8-35N-1E**
 Township: **Lincoln**
 Acres: **38.03**
 Date: **11/8/2016**



Maps Provided By:



© AgriData, Inc. 2016

www.AgriDataInc.com



Area Symbol: IN141, Soil Area Version: 19

Code	Soil Description	Acres	Percent of field	Non-Irr Class Legend	Soil Drainage	Non-Irr Class *c	Corn	Corn Irrigated	Soybeans	Soybeans Irrigated	Winter wheat
OlcA	Oshtemo sandy loam, 0 to 1 percent slopes	37.62	98.9%		Well drained	IIIc	109	12	38	4	54
TmpA	Tracy sandy loam, 0 to 1 percent slopes	0.41	1.1%		Well drained	IIc	102		36		50
Weighted Average							108.9	11.9	38	4	54

Area Symbol: IN141, Soil Area Version: 19

*c: Using Capabilities Class Dominant Condition Aggregation Method

Soils data provided by USDA and NRCS.