

Soils Map

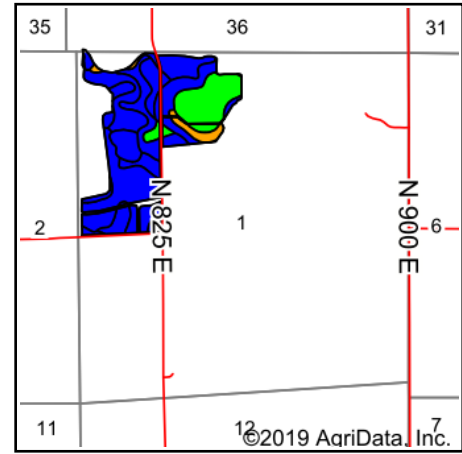

State: **Indiana**
 County: **Warren**
 Location: **1-22N-7W**
 Township: **Warren**
 Acres: **88.41**
 Date: **2/26/2019**

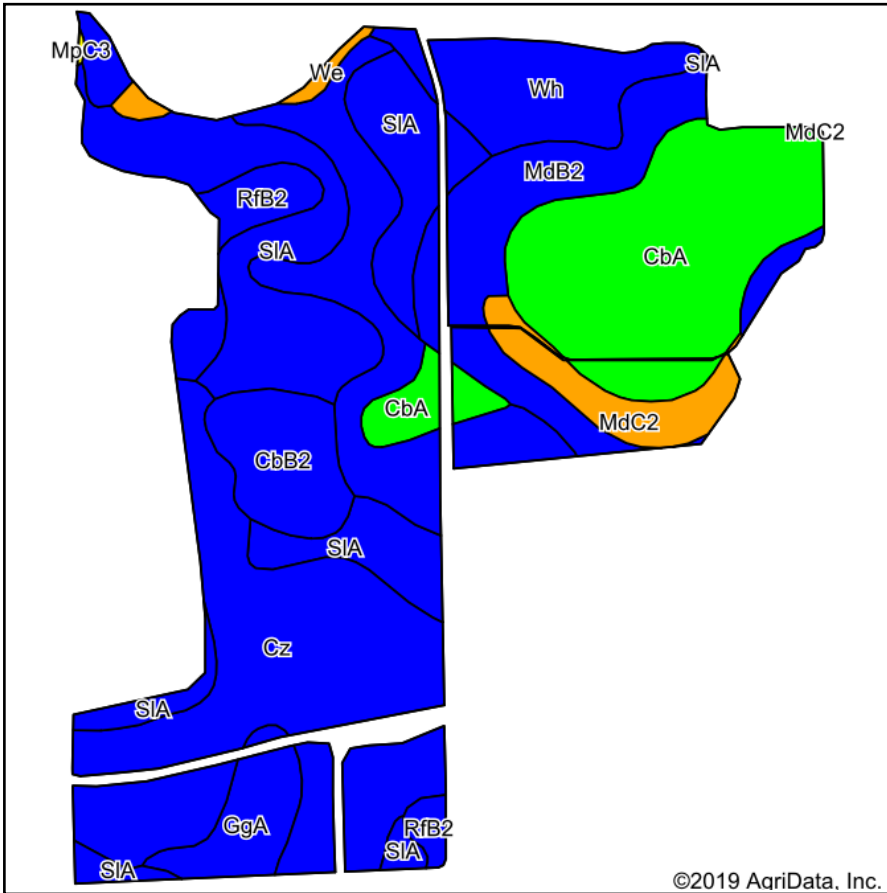

Soils data provided by USDA and NRCS.

Area Symbol: IN171, Soil Area Version: 21

Code	Soil Description	Acres	Percent of field	Non-Irr Class Legend	Non-Irr Class *c	Corn	Soybeans	Winter wheat	*n NCCPI Overall	*n NCCPI Soybeans
Cz	Cyclone silty clay loam, 0 to 2 percent slopes	28.07	31.7%		IIw	185	65	75	85	79
SIA	Starks silt loam, till substratum, 0 to 2 percent slopes	17.15	19.4%		IIw	160	52	72	93	80
CbA	Camden silt loam, 0 to 2 percent slopes	15.94	18.0%		Iw	156	54	63	91	77
MdB2	Martinsville loam, 2 to 6 percent slopes, eroded	8.45	9.6%		Ile	131	46	66	73	59
Wh	Washtenaw silt loam	5.59	6.3%		IIw	165	49	66	94	85
CbB2	Camden silt loam, 2 to 6 percent slopes, eroded	4.04	4.6%		Ile	141	50	70	78	66
MdC2	Martinsville loam, 6 to 12 percent slopes, eroded	2.90	3.3%		IIIe	122	43	61	71	57
RfB2	Rainsville-Williamstown-Rockfield silt loams, 2 to 6 percent slopes, eroded	2.84	3.2%		Ile	133	47	60	58	49
GgA	Gilboa silt loam, 0 to 2 percent slopes	2.79	3.2%		IIw	155	48	69	78	71
We	Walkkill variant silty clay loam	0.64	0.7%		IIIw	160	43	64	99	84
Weighted Average						161.6	55	69.4	*n 85.3	*n 74.8

*n: The aggregation method is "Weighted Average using major components"

*c: Using Capabilities Class Dominant Condition Aggregation Method

Soils data provided by USDA and NRCS.