

Soils Map

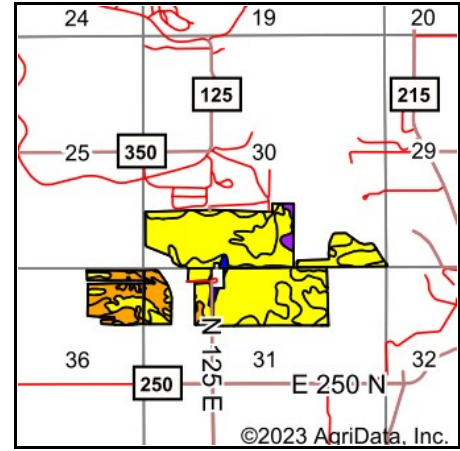

State: **Indiana**
 County: **Pulaski**
 Location: **30-31N-1W**
 Township: **Tippecanoe**
 Acres: **252.78**
 Date: **3/2/2023**

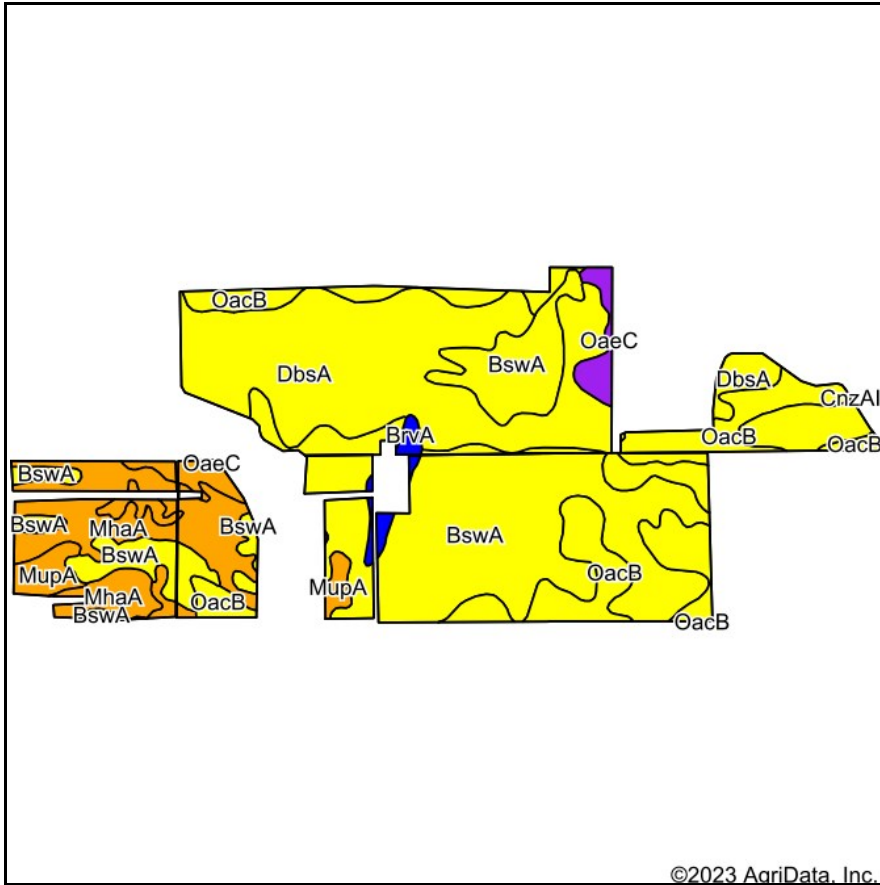

Maps Provided By:



© AgriData, Inc. 2023

www.AgriDataInc.com



Soils data provided by USDA and NRCS.

©2023 AgriData, Inc.

Area Symbol: IN131, Soil Area Version: 24

Code	Soil Description	Acres	Percent of field	Non-Irr Class Legend	Water Table	Restrictive Layer	Soil Drainage	Non-Irr Class *c	Corn Bu	Corn Irrigated Bu	Soybeans Bu	Soybeans Irrigated Bu	Winter wheat Bu	*n NCCPI Corn	*n NCCPI Soybeans
BswA	Brems-Morocco loamy fine sands, 0 to 1 percent slopes	94.07	37.2%		2.5ft.	> 6.5ft.	Moderately well drained	IVs	98		31		44	32	31
DbsA	Denham fine sand, 0 to 1 percent slopes	85.73	33.9%		3ft.	> 6.5ft.	Moderately well drained	IVs	90		31		41	27	27
OacB	Oakville-Denham fine sands, 1 to 5 percent slopes	30.90	12.2%		3ft.	> 6.5ft.	Excessively drained	IVs	84		30		38	26	26
MhaA	Maumee loamy fine sand, 0 to 1 percent slopes	24.86	9.8%		0.2ft.	> 6.5ft.	Poorly drained	Illw	134		47		54	55	37
MupA	Morocco loamy fine sand, 0 to 2 percent slopes	11.17	4.4%		1ft.	> 6.5ft.	Somewhat poorly drained	Ills	102		36		41	51	34

Soils data provided by USDA and NRCS.



Code	Soil Description	Acres	Percent of field	Non-Irr Class Legend	Water Table	Restrictive Layer	Soil Drainage	Non-Irr Class *c	Corn Bu	Corn Irrigated Bu	Soybeans Bu	Soybeans Irrigated Bu	Winter wheat Bu	*n NCCPI Corn	*n NCCPI Soybeans
OaeC	Oakville fine sand, 5 to 12 percent slopes	3.54	1.4%		> 6.5ft.	> 6.5ft.	Excessively drained	Vls	73		26		33	26	25
BrvA	Brady fine sandy loam, 0 to 1 percent slopes	2.51	1.0%		0.5ft.	4.6ft. (Strongly contrasting textural stratification)	Somewhat poorly drained	llw	125	9	35	3	56	64	53
Weighted Average								3.87	97.2	0.1	32.6	*-	43.1	*n 32.9	*n 29.9

*n: The aggregation method is "Weighted Average using all components"

*c: Using Capabilities Class Dominant Condition Aggregation Method