

Soils Map

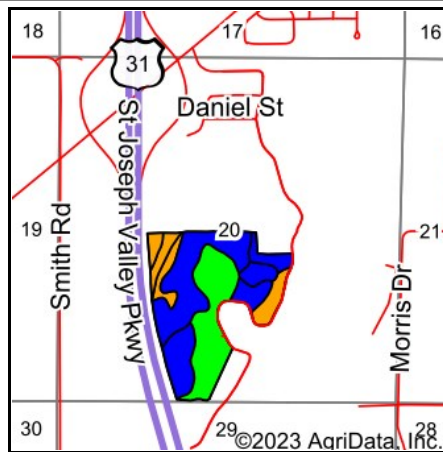

State: **Michigan**
 County: **Berrien**
 Location: **20-7S-17W**
 Township: **Niles**
 Acres: **81.32**
 Date: **3/2/2023**

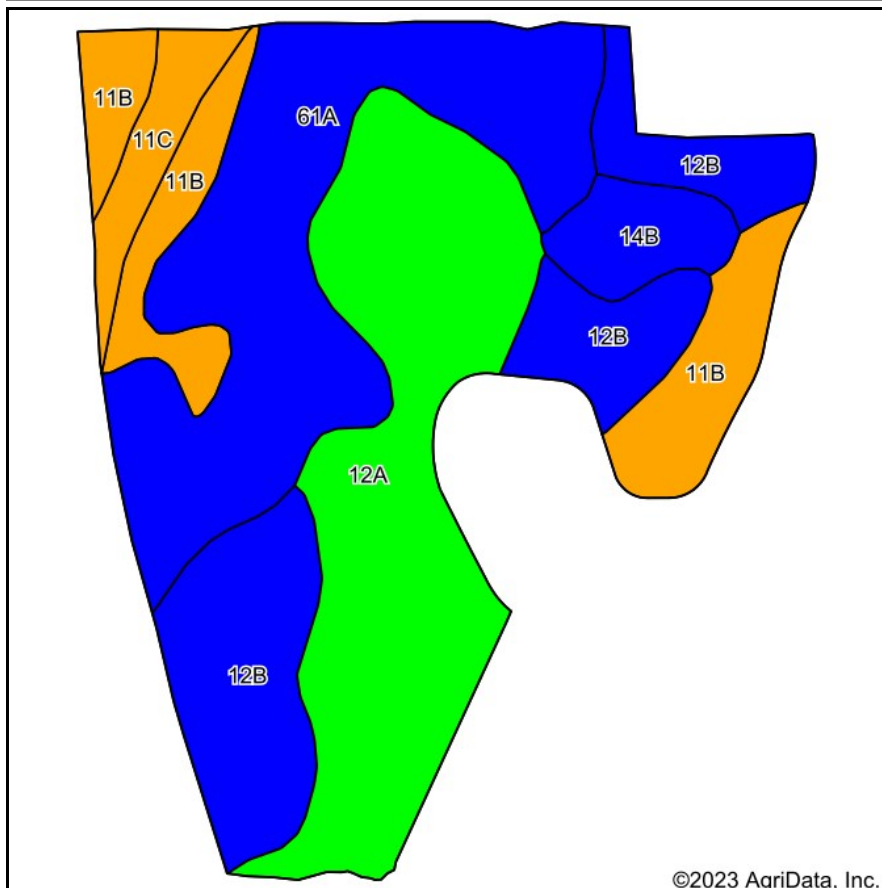

Soils data provided by USDA and NRCS.

Archived Soils Ending 1/21/2012

Code	Soil Description	Acres	Percent of field	Non-Irr Class Legend	Water Table	Restrictive Layer	Soil Drainage	Non-Irr Class *c	Irr Class *c	Corn Bu	Corn Irrigated Bu	Soybeans Bu	Soybeans Irrigated Bu	Winter wheat Bu
12A	Ockley loam, 0 to 2 percent slopes	24.49	30.1%		> 6.5ft.	> 6.5ft.	Well drained	Iw		110		38		44
61A	Whitaker loam, 0 to 2 percent slopes	23.56	29.0%		0.5ft.	> 6.5ft.	Somewhat poorly drained	IIw		125		44		50
12B	Ockley loam, 2 to 6 percent slopes	16.57	20.4%		> 6.5ft.	> 6.5ft.	Well drained	Ile		110		38		44
11B	Oshtemo sandy loam, 0 to 6 percent slopes	10.30	12.7%		> 6.5ft.	> 6.5ft.	Well drained	IIIs	IIle	95	175	30	57	45
14B	Riddles loam, 2 to 6 percent slopes	3.41	4.2%		> 6.5ft.	> 6.5ft.	Well drained	Ile		110		38		50
11C	Oshtemo sandy loam, 6 to 12 percent slopes	2.99	3.7%		> 6.5ft.	> 6.5ft.	Well drained	IIle	IIle	90	165	26	50	40
Weighted Average								1.86	*-	111.7	28.2	38.3	9.1	46

*c: Using Capabilities Class Dominant Condition Aggregation Method

*- Irr Class weighted average cannot be calculated on the current soils data due to missing data.

Soils data provided by USDA and NRCS.