

Soils Map

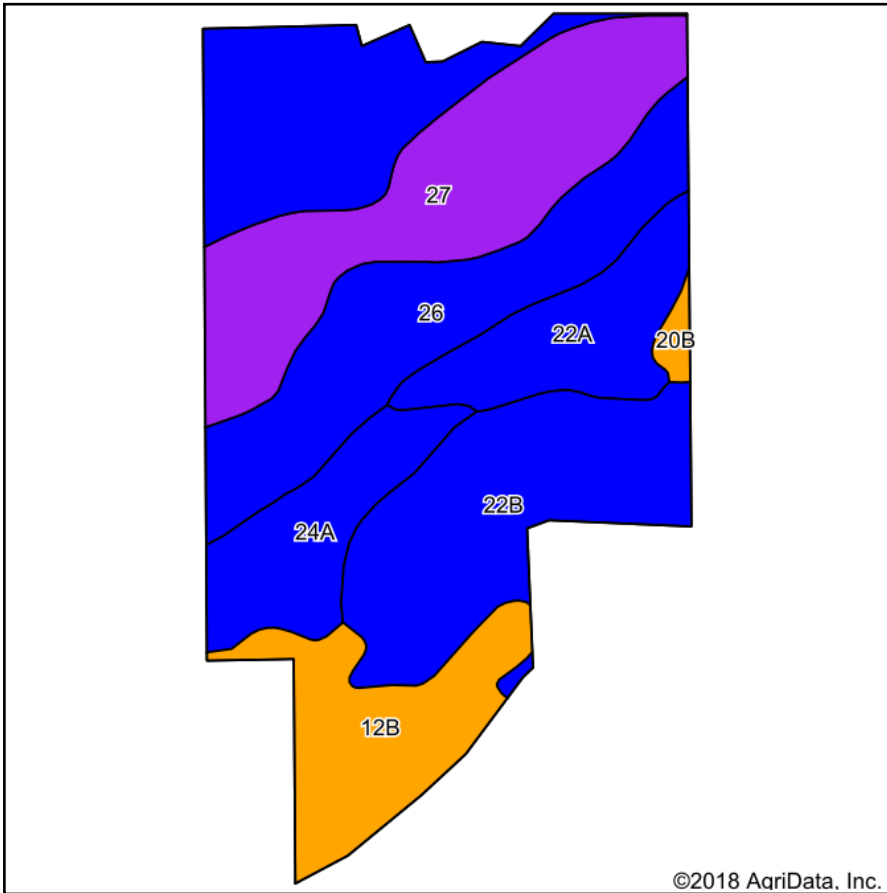

Soils data provided by USDA and NRCS.

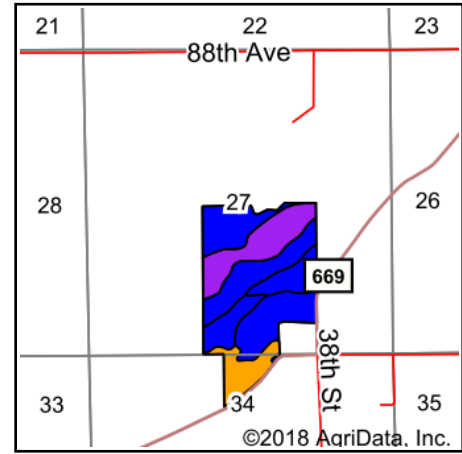

State: **Michigan**
 County: **Van Buren**
 Location: **27-4S-14W**
 Township: **Decatur**
 Acres: **119.71**
 Date: **12/11/2018**



Maps Provided By:



Area Symbol: MI159, Soil Area Version: 14

Code	Soil Description	Acres	Percent of field	Non-Irr Class Legend	Soil Drainage	Non-Irr Class *c	Irr Class *c	Corn	Corn Irrigated	Soybeans	Soybeans Irrigated
26	Gilford sandy loam, 0 to 1 percent slopes	37.07	31.0%	Blue	Poorly drained	IIw		150		42	
27	Adrian muck, 0 to 1 percent slopes	25.12	21.0%	Purple	Very poorly drained	Vw					
22B	Kalamazoo loam, 2 to 6 percent slopes	22.06	18.4%	Blue	Well drained	Ile	Ile				
12B	Spinks-Oshtemo complex, 0 to 6 percent slopes	13.65	11.4%	Orange	Well drained	IIIIs	IIIIs				
22A	Kalamazoo loam, 0 to 2 percent slopes	10.59	8.8%	Blue	Well drained	IIs	IIs				
24A	Bronson sandy loam, 0 to 3 percent slopes	10.28	8.6%	Blue	Moderately well drained	IIs	IIs	100	170	30	55
20B	Spinks loamy sand, 0 to 6 percent slopes	0.94	0.8%	Orange	Well drained	IIIIs	IIIIs				
Weighted Average								55	14.6	15.6	4.7

*c: Using Capabilities Class Dominant Condition Aggregation Method

Soils data provided by USDA and NRCS.