

Soils Map

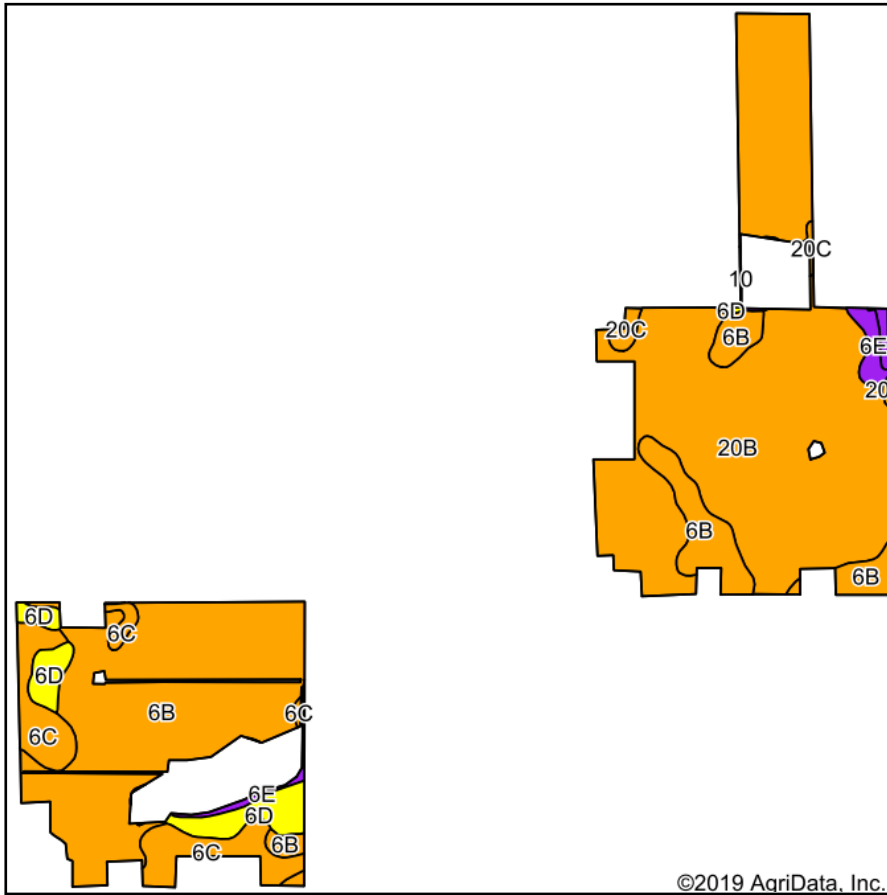

Soils data provided by USDA and NRCS.

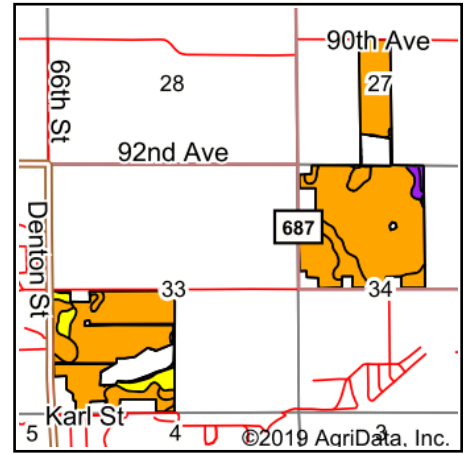

State: **Michigan**
 County: **Van Buren**
 Location: **33-4S-16W**
 Township: **Keeler**
 Acres: **292.31**
 Date: **10/14/2019**



Maps Provided By:
surety
 CUSTOMIZED ONLINE MAPPING
 © AgriData, Inc. 2019 www.AgriDataInc.com



Archived Soils Ending 1/21/2012

Code	Soil Description	Acres	Percent of field	Non-Irr Class Legend	Water Table	Restrictive Layer	Soil Drainage	Non-Irr Class *c	Irr Class *c	Cor n	Corn Irrigated	Soybeans	Soybeans Irrigated	Winter wheat
20B	Spinks loamy sand, 0 to 6 percent slopes	149.72	51.2%		0ft.	> 6.5ft.	Well drained	IIIs	IIIs	75	165	27	50	30
6B	Oshtemo sandy loam, 0 to 6 percent slopes	101.81	34.8%		> 6.5ft.	> 6.5ft.	Well drained	IIIs	IIle	95	175	30	57	45
6C	Oshtemo sandy loam, 6 to 12 percent slopes	20.55	7.0%		> 6.5ft.	> 6.5ft.	Well drained	IIle	IIle	90	165	26	50	40
6D	Oshtemo-Coloma loamy sands, 12 to 18 percent slopes	12.35	4.2%		> 6.5ft.	> 6.5ft.	Well drained	IVe		80		21		35
6E	Oshtemo-Coloma loamy sands, 18 to 25 percent slopes	4.59	1.6%		> 6.5ft.	> 6.5ft.	Well drained	VIe						
20C	Spinks loamy sand, 6 to 12 percent slopes	2.22	0.8%		0ft.	> 6.5ft.	Well drained	IIle	IIle	68	155	23	50	30
10	Aquents and Histosols, ponded	1.07	0.4%		0ft.	> 6.5ft.	Very poorly drained	VIw						
Weighted Average										81.7	158.2	27.2	49.4	35.6

*c: Using Capabilities Class Dominant Condition Aggregation Method
 Soils data provided by USDA and NRCS.