

# Soils Map

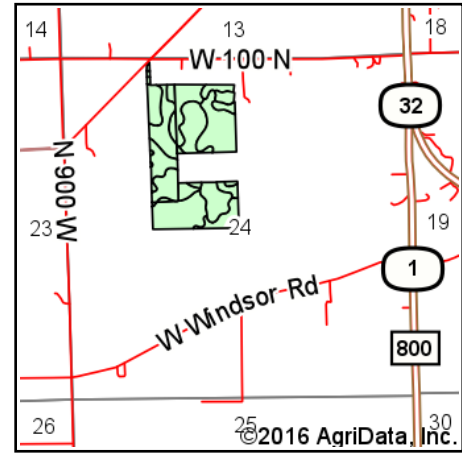

State: **Indiana**  
 County: **Randolph**  
 Location: **24-20N-12E**  
 Township: **Stoney Creek**  
 Acres: **58.83**  
 Date: **3/16/2016**

Maps Provided By:

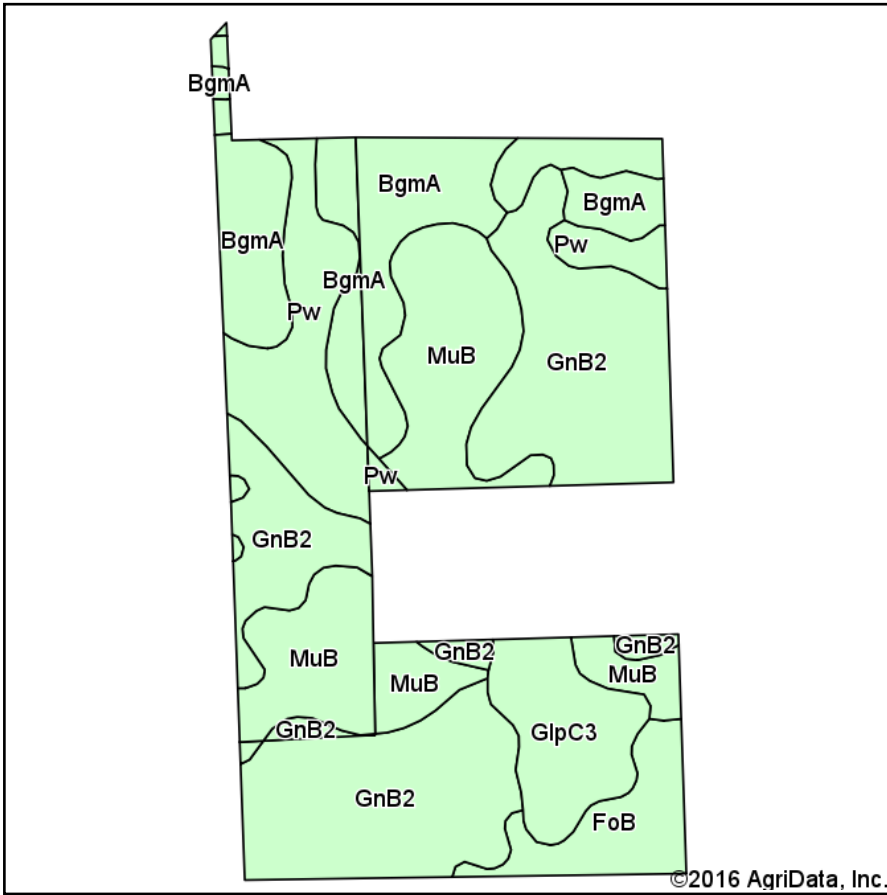

© AgriData, Inc. 2016 [www.AgriDataInc.com](http://www.AgriDataInc.com)



**Area Symbol: IN135, Soil Area Version: 18**

Code	Soil Description	Acres	Percent of field	Water Table	Restrictive Layer	Soil Drainage	Non-Irr Class *c	Corn	Soybeans	Winter wheat
GnB2	Glynwood silt loam, 1 to 4 percent slopes, eroded	21.15	36.0%	1.5ft.	2.5ft. (Densic material)	Moderately well drained	Ile	129	44	57
MuB	Morley silt loam, 3 to 6 percent slopes	11.92	20.3%	2.7ft.	2.6ft. (Densic material)	Moderately well drained	Ile	117	41	53
BgmA	Blount silt loam, ground moraine, 0 to 2 percent slopes	10.10	17.2%	0.7ft.	3.2ft. (Densic material)	Somewhat poorly drained	Ilw	141	45	63
Pw	Pewamo silty clay loam, 0 to 1 percent slopes	8.16	13.9%	0.5ft.	> 6.5ft.	Very poorly drained	Ilw	157	47	64
GlpC3	Glynwood clay loam, 6 to 12 percent slopes, severely eroded	4.33	7.4%	1.5ft.	2.1ft. (Densic material)	Moderately well drained	IVe	112	29	49
FoB	Fox loam, 2 to 6 percent slopes	3.17	5.4%	> 6.5ft.	2.9ft. (Strongly contrasting textural stratification)	Well drained	Ile	100	35	50
<b>Weighted Average</b>								<b>129.7</b>	<b>42.4</b>	<b>57.2</b>

Area Symbol: IN135, Soil Area Version: 18

\*c: Using Capabilities Class Dominant Condition Aggregation Method

Soils data provided by USDA and NRCS.