

# Soils Map

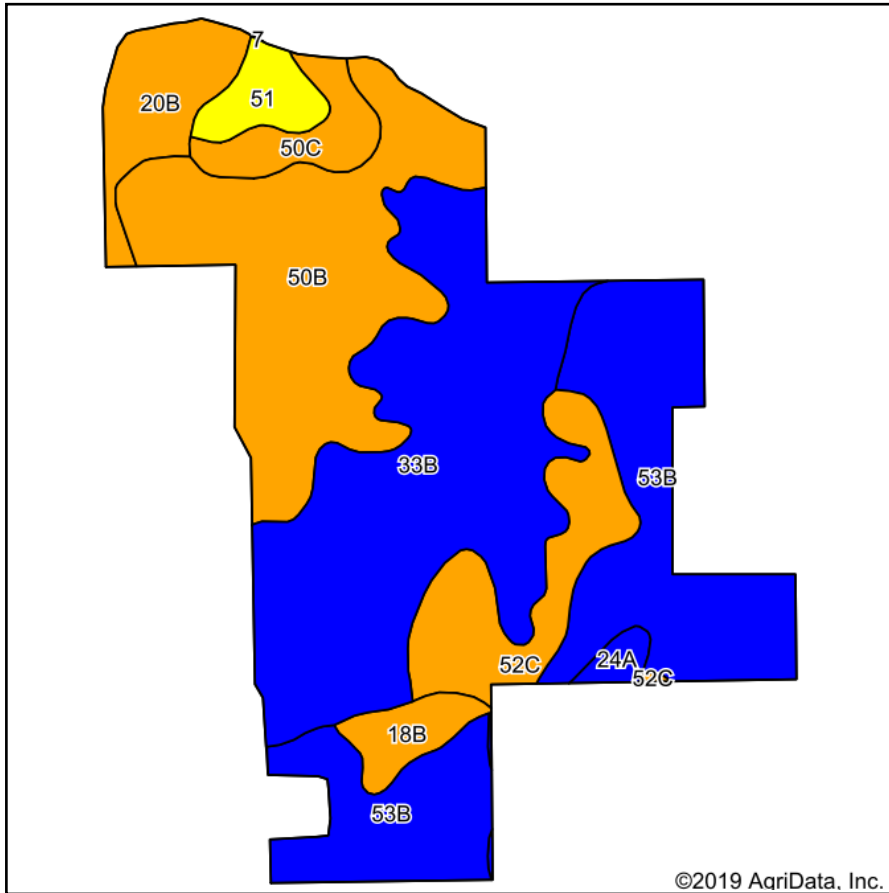

Soils data provided by USDA and NRCS.

©2019 AgriData, Inc.

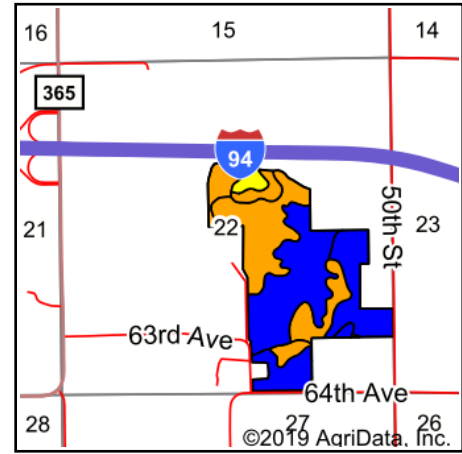

State: **Michigan**  
 County: **Van Buren**  
 Location: **22-3S-15W**  
 Township: **Lawrence**  
 Acres: **128.54**  
 Date: **5/6/2019**



## Archived Soils Ending 11/6/2014

Area Symbol: MI159, Soil Area Version: 9

Code	Soil Description	Acres	Percent of field	Non-Irr Class Legend	Water Table	Restrictive Layer	Soil Drainage	Non-Irr Class *c	Irr Class *c	Corn	Corn Irrigated	Soybeans	Soybeans Irrigated	Winter wheat
33B	Tuscola silt loam, 0 to 4 percent slopes	39.62	30.8%		1.5ft.	> 6.5ft.	Moderately well drained	Ile		100		32		47
53B	Capac loam, 1 to 5 percent slopes	30.49	23.7%		1.5ft.	> 6.5ft.	Somewhat poorly drained	Ile		110	155	36		62
50B	Metea loamy fine sand, 1 to 6 percent slopes	28.69	22.3%		> 6.5ft.	> 6.5ft.	Well drained	Ille		85		30		42
52C	Riddles sandy loam, 6 to 12 percent slopes	10.84	8.4%		> 6.5ft.	> 6.5ft.	Well drained	Ille		105		37		47
20B	Spinks loamy sand, 0 to 6 percent slopes	6.90	5.4%		0ft.	> 6.5ft.	Well drained	Ills	Ills	75	165	27	50	30
50C	Metea loamy fine sand, 6 to 12 percent slopes	4.33	3.4%		> 6.5ft.	> 6.5ft.	Well drained	Ille		75		26		38
51	Kingsville loamy sand	3.32	2.6%		0ft.	> 6.5ft.	Poorly drained	IVw		75		25		30
18B	Ormas loamy sand, 0 to 6 percent slopes	3.10	2.4%		> 6.5ft.	> 6.5ft.	Well drained	Ille		80		28		36
24A	Bronson sandy loam, 0 to 3 percent slopes	1.25	1.0%		0.5ft.	> 6.5ft.	Moderately well drained	Ils	Ils	100	170	30	55	40
<b>Weighted Average</b>										<b>96.1</b>	<b>47.3</b>	<b>32.2</b>	<b>3.2</b>	<b>47.5</b>

\*c: Using Capabilities Class Dominant Condition Aggregation Method

Soils data provided by USDA and NRCS.