

# Soils Map

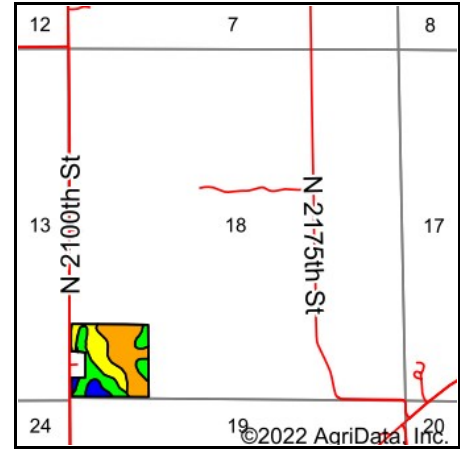

State: **Illinois**  
 County: **Edgar**  
 Location: **18-14N-10W**  
 Township: **Hunter**  
 Acres: **26.96**  
 Date: **4/28/2022**

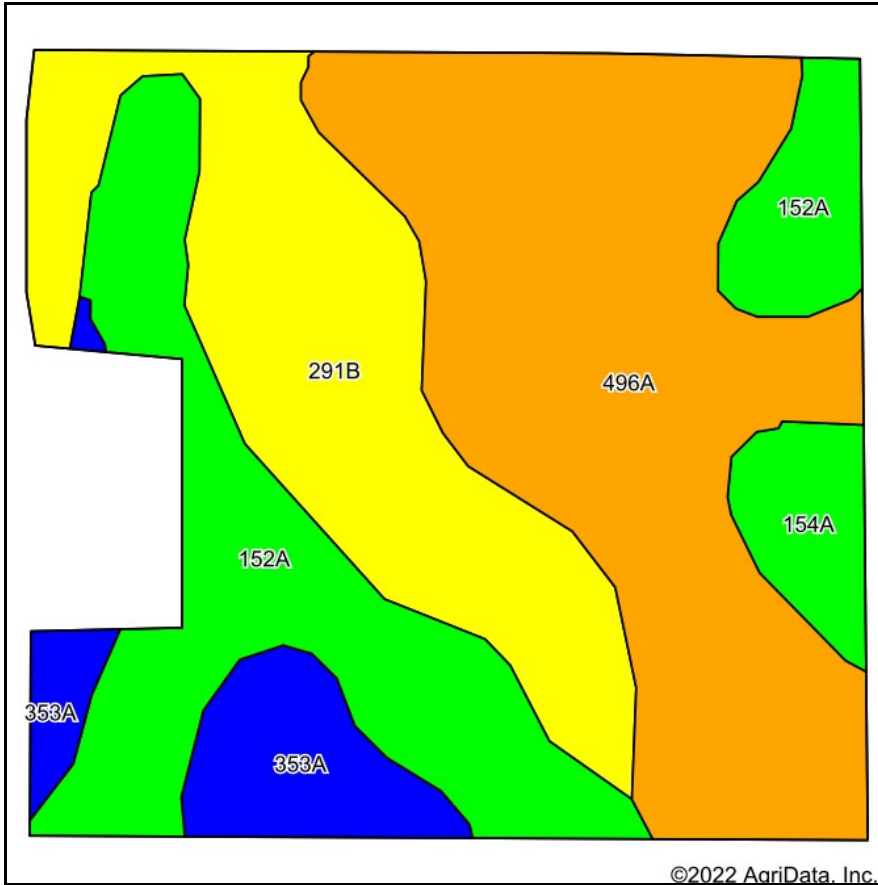

Soils data provided by USDA and NRCS.

Area Symbol: IL045, Soil Area Version: 16

Code	Soil Description	Acres	Percent of field	Il. State Productivity Index Legend	Water Table	Subsoil rooting <sup>a</sup>	Corn Bu/A	Soybeans Bu/A	Wheat Bu/A	Crop productivity index for optimum management
496A	Fincastle silt loam, Bloomington Ridged Plain, 0 to 2 percent slopes	10.57	39.2%		0.8ft.	FAV	166	52	65	121
**291B	Xenia silt loam, Bloomington Ridged Plain, 2 to 5 percent slopes	6.72	24.9%		2ft.	FAV	**160	**50	**63	**117
152A	Drummer silty clay loam, 0 to 2 percent slopes	6.61	24.5%		0.5ft.	FAV	195	63	73	144
353A	Toronto silt loam, Bloomington Ridged Plain, 0 to 2 percent slopes	2.00	7.4%		1ft.	FAV	174	56	69	128
154A	Flanagan silt loam, 0 to 2 percent slopes	1.06	3.9%		1.5ft.	FAV	194	63	77	144
<b>Weighted Average</b>							<b>173.3</b>	<b>54.9</b>	<b>67.2</b>	<b>127.1</b>

**Table: Optimum Crop Productivity Ratings for Illinois Soil by K.R. Olson and J.M. Lang, Office of Research, ACES, University of Illinois at Champaign-Urbana.** Version: 1/2/2012 Amended Table S2 B811

Crop yields and productivity indices for optimum management (B811) are maintained at the following NRES web site:

<http://soilproductivity.nres.illinois.edu/>

\*\* Indexes adjusted for slope and erosion according to Bulletin 811 Table S3

<sup>a</sup> UNF = unfavorable; FAV = favorable