

# Soils Map

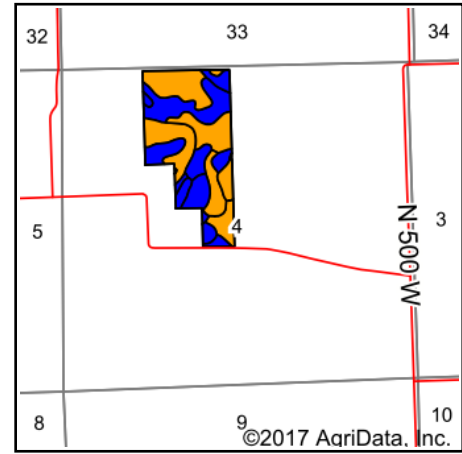

State: **Indiana**  
 County: **Kosciusko**  
 Location: **4-33N-5E**  
 Township: **Prairie**  
 Acres: **62.24**  
 Date: **10/31/2017**

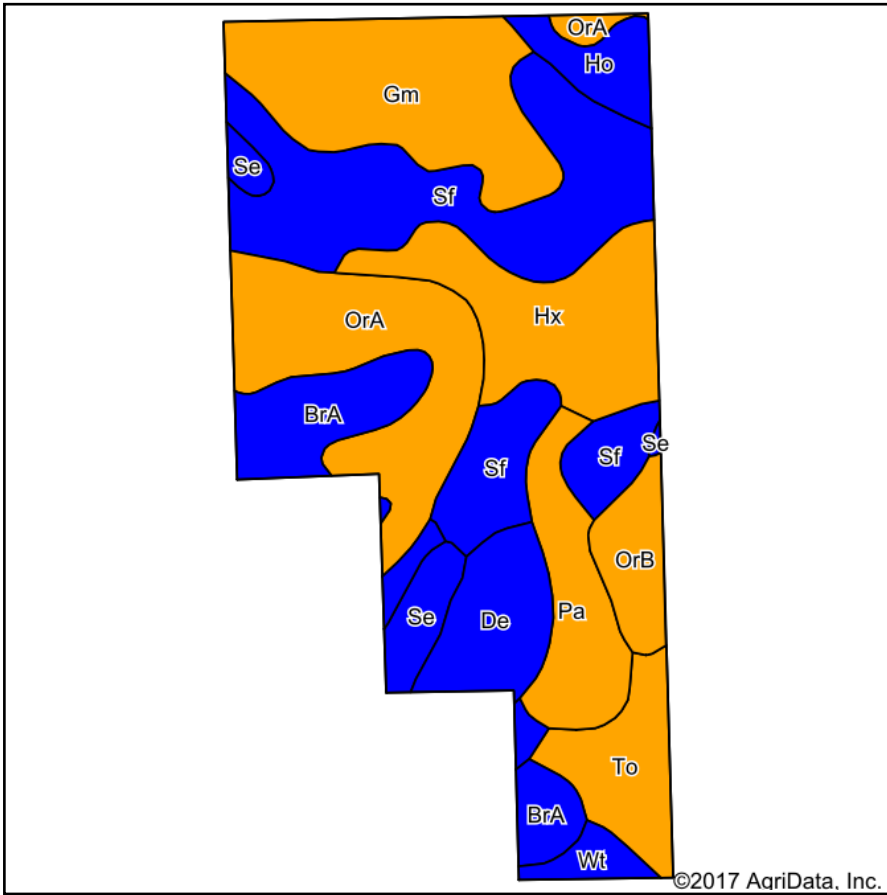

Soils data provided by USDA and NRCS.

©2017 AgriData, Inc.

## Area Symbol: IN085, Soil Area Version: 19

Cod e	Soil Description	Acres	Percent of field	Non-Irr Class Legend	Water Table	Restrictive Layer	Soil Drainage	Non-Irr Class *c	Corn	Corn Irrigated	Soybeans	Winter wheat
Sf	Sebewa mucky loam	14.40	23.1%		0.7ft.	3ft. (Strongly contrasting textural stratification)	Poorly drained	IIw	130		33	52
Gm	Gilford mucky sandy loam, gravelly substratum	8.99	14.4%		0.5ft.	> 6.5ft.	Very poorly drained	IIIw	150		33	60
OrA	Ormas loamy sand, 0 to 2 percent slopes	8.62	13.8%		> 6.5ft.	4ft. (Strongly contrasting textural stratification)	Well drained	IIIs	100		35	50
Hx	Houghton muck, drained	6.89	11.1%		0.7ft.	> 6.5ft.	Very poorly drained	IIIw	159		42	64
BrA	Bronson sandy loam, 0 to 2 percent slopes	5.03	8.1%		2ft.	> 6.5ft.	Moderately well drained	IIs	108		38	49
Pa	Palms muck, drained	4.20	6.7%		0.7ft.	> 6.5ft.	Very poorly drained	IIIw	158		43	63
To	Toledo silty clay	3.49	5.6%		0.2ft.	> 6.5ft.	Very poorly drained	IIIw	150		42	60
De	Del Rey silt loam	3.48	5.6%		1.2ft.	> 6.5ft.	Somewhat poorly drained	IIw	126		41	57
OrB	Ormas loamy sand, 2 to 6 percent slopes	2.23	3.6%		> 6.5ft.	4ft. (Strongly contrasting textural stratification)	Well drained	IIIe	100		35	50
Se	Sebewa loam, drained, 0 to 1 percent slopes	2.23	3.6%		0.7ft.	2.8ft. (Strongly contrasting textural stratification)	Poorly drained	IIw	133		36	65
Ho	Homer sandy loam	1.78	2.9%		0.5ft.	2.9ft. (Strongly contrasting textural stratification)	Somewhat poorly drained	IIw	108	6	33	48
Wt	Whitaker loam	0.90	1.4%		1.2ft.	> 6.5ft.	Somewhat poorly drained	IIw	154		50	69
<b>Weighted Average</b>									<b>131.7</b>	<b>0.2</b>	<b>36.7</b>	<b>56</b>

\*c: Using Capabilities Class Dominant Condition Aggregation Method

Soils data provided by USDA and NRCS.