

Soils Map

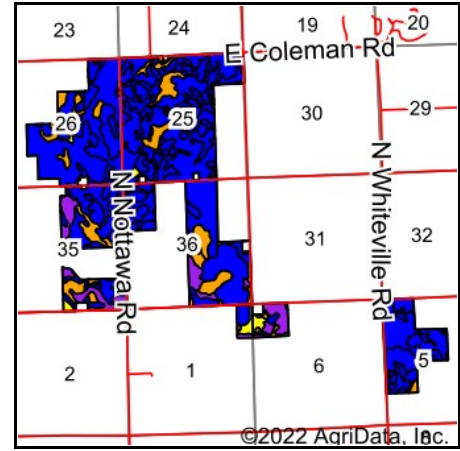

State: **Michigan**
 County: **Isabella**
 Location: **31-16N-4W**
 Township: **Vernon**
 Acres: **1597.28**
 Date: **5/17/2022**

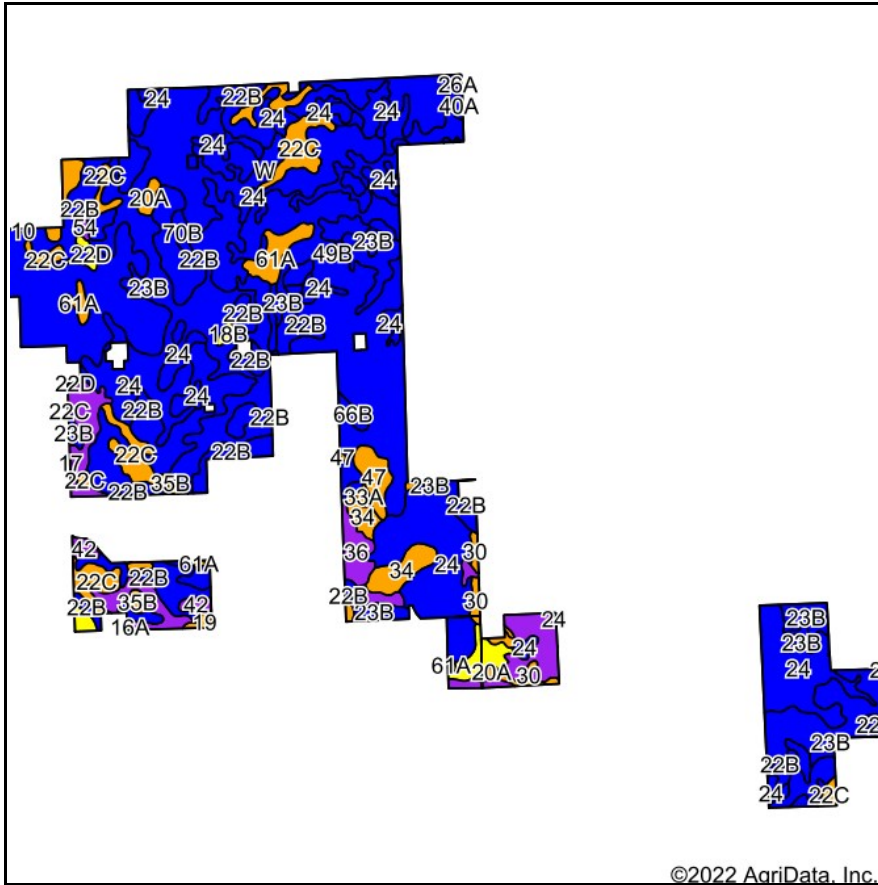

Soils data provided by USDA and NRCS.

©2022 AgriData, Inc.

Area Symbol: MI073, Soil Area Version: 16

Code	Soil Description	Acres	Percent of field	Non-Irr Class Legend	Water Table	Non-Irr Class *c	Irr Class *c	Corn Bu	Corn Irrigated Bu	Soybeans Bu	Winter wheat Bu	Winter wheat Irrigated Bu	*n NCCPI Corn	*n NCCPI Soybeans
23B	Ithaca loam, 0 to 4 percent slopes	572.56	35.8%		1.5ft.	Ile		105	140	38	46		68	66
22B	Onokama loam, Saginaw Lobe, 2 to 6 percent slopes	444.95	27.9%		> 6.5ft.	Ile							56	50
24	Ziegenfuss loam	247.06	15.5%		0ft.	IIlw		125		42	60		65	65
22C	Onokama loam, Saginaw Lobe, 6 to 12 percent slopes	70.88	4.4%		> 6.5ft.	IIle							53	45
36	Adrian muck, 0 to 1 percent slopes	44.50	2.8%		0.5ft.	V w							9	4
10	Pinnebog muck	39.19	2.5%		0ft.	V w							4	3
34	Belleville loamy sand	22.92	1.4%		0ft.	IIIw		115		35	50		27	18
61A	Selfridge sand, 0 to 3 percent slopes	21.39	1.3%		1.5ft.	IIIw		85		33	35		54	42

Soils data provided by USDA and NRCS.



Code	Soil Description	Acres	Percent of field	Non-Irr Class Legend	Water Table	Non-Irr Class *c	Irr Class *c	Corn Bu	Corn Irrigated Bu	Soybeans Bu	Winter wheat Bu	Winter wheat Irrigated Bu	*n NCCPI Corn	*n NCCPI Soybeans
40A	Parkhill loam, non dense till subsoil, 0 to 2 percent slopes	1.69	0.1%		2.5ft.	IIw							66	69
54	Histosols and Aquents, ponded	1.52	0.1%		0ft.	VIw								
W	Water	0.52	0.0%		> 6.5ft.									
16A	Wasepi loamy sand, 0 to 3 percent slopes	0.49	0.0%		1.5ft.	III s		85		32	35		46	31
29A	Minoa loamy fine sand, 0 to 3 percent slopes	0.31	0.0%		1ft.	IIIw		95			45		62	60
Weighted Average						2.32	0.01	66.3	52.5	22.6	29.7	0.2	*n 57.7	*n 53.9

*n: The aggregation method is "Weighted Average using all components"

*c: Using Capabilities Class Dominant Condition Aggregation Method

Soils Map

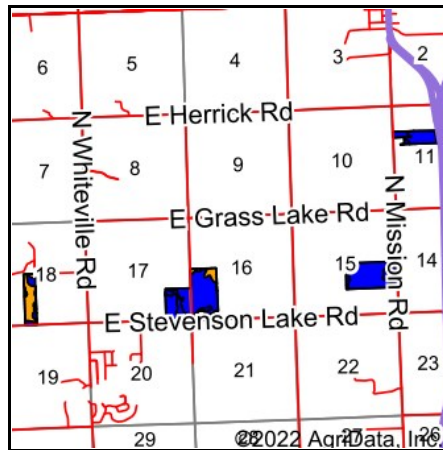
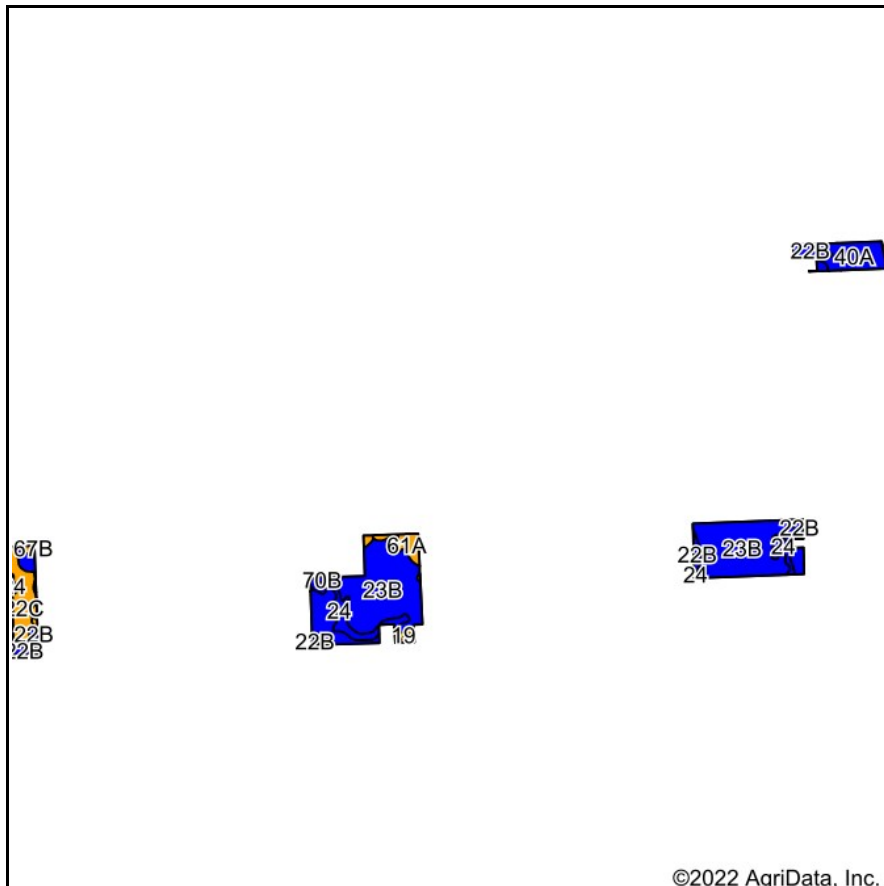

State: **Michigan**
 County: **Isabella**
 Location: **16-16N-4W**
 Township: **Vernon**
 Acres: **266.7**
 Date: **5/17/2022**



Maps Provided By:



Soils data provided by USDA and NRCS.

©2022 AgriData, Inc.

© AgriData, Inc. 2021

www.AgriDataInc.com

Area Symbol: MI073, Soil Area Version: 16

Code	Soil Description	Acres	Percent of field	Non-Irr Class Legend	Water Table	Non-Irr Class *c	Corn Bu	Corn Irrigated Bu	Soybeans Bu	Winter wheat Bu	Winter wheat Irrigated Bu	*n NCCPI Corn	*n NCCPI Soybeans
23B	Ithaca loam, 0 to 4 percent slopes	163.57	61.3%		1.5ft.	Ile	105	140	38	46		68	66
22C	Onokama loam, Saginaw Lobe, 6 to 12 percent slopes	24.08	9.0%		> 6.5ft.	Ile						53	45
40A	Parkhill loam, non dense till subsoil, 0 to 2 percent slopes	21.67	8.1%		2.5ft.	IIw						66	69
24	Ziegenfuss loam	21.44	8.0%		0ft.	IIw	125		42	60		65	65
22B	Onokama loam, Saginaw Lobe, 2 to 6 percent slopes	15.85	5.9%		> 6.5ft.	Ile						56	50
61A	Selfridge sand, 0 to 3 percent slopes	9.69	3.6%		1.5ft.	IIIw	85		33	35		54	42
CpcaaB	Capac loam, 0 to 4 percent slopes	4.20	1.6%		1ft.	Ile						69	63
19	Gilford fine sandy loam, 0 to 2 percent slopes, gravelly subsoil	1.51	0.6%		1ft.	IIIw	150		42	60		38	22

Soils data provided by USDA and NRCS.

Code	Soil Description	Acres	Percent of field	Non-Irr Class Legend	Water Table	Non-Irr Class *c	Corn Bu	Corn Irrigated Bu	Soybeans Bu	Winter wheat Bu	Winter wheat Irrigated Bu	*n NCCPI Corn	*n NCCPI Soybeans
35B	Metea loamy sand, 1 to 6 percent slopes	1.24	0.5%		> 6.5ft.	lle	85		30	42		53	40
20A	Pipestone sand, Erie-Huron Lake Plain, 0 to 3 percent slopes	1.12	0.4%		1.7ft.	lllw						58	33
70B	Ithaca-Selfridge complex, 0 to 4 percent slopes	1.00	0.4%		1.5ft.	lle	105	140	38	46		58	58
27	Corunna sandy loam	0.38	0.1%		0ft.	llw	140		40	65		58	62
36	Adrian muck, 0 to 1 percent slopes	0.38	0.1%		0.5ft.	V w						9	4
10	Pinnebog muck	0.32	0.1%		0ft.	V w						4	3
67B	Remus sandy loam, 1 to 6 percent slopes	0.17	0.1%		> 6.5ft.	lle	95	155	28	40	60	61	45
52	Udorthents, loamy	0.08	0.0%		> 6.5ft.								
Weighted Average							2.15	79.4	86.5	28.5	35.1	*- *n 64.5	*n 61.7

*n: The aggregation method is "Weighted Average using all components"

*c: Using Capabilities Class Dominant Condition Aggregation Method

Soils Map

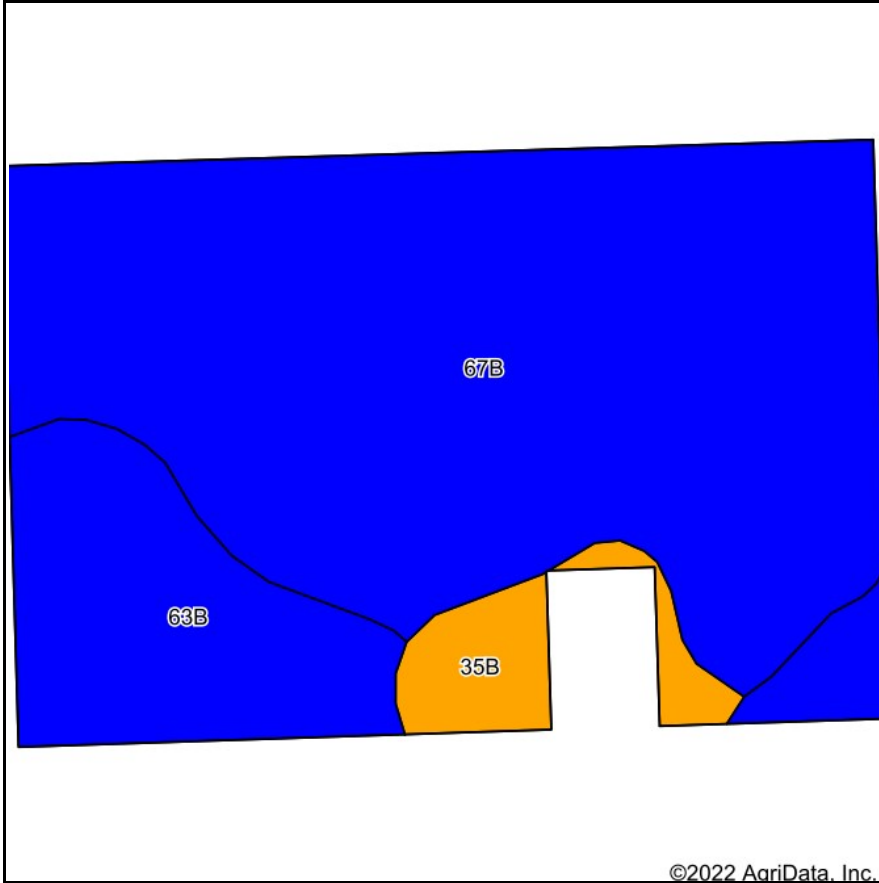

State: **Michigan**
 County: **Isabella**
 Location: **16-16N-5W**
 Township: **Gilmore**
 Acres: **57.88**
 Date: **6/7/2022**



Soils data provided by USDA and NRCS.

©2022 AgriData, Inc.

Area Symbol: MI073, Soil Area Version: 16

Code	Soil Description	Acres	Percent of field	Non-Irr Class Legend	Non-Irr Class *c	Corn Bu	Corn Irrigated Bu	Soybeans Bu	Winter wheat Bu	Winter wheat Irrigated Bu	*n NCCPI Corn	*n NCCPI Soybeans
67B	Remus sandy loam, 1 to 6 percent slopes	42.91	74.1%		lle	95	155	28	40	60	61	45
63B	Remus-Spinks complex, 1 to 6 percent slopes	11.70	20.2%		lle	95	155	28	40	60	53	39
35B	Metea loamy sand, 1 to 6 percent slopes	3.27	5.6%		lle	85		30	42		53	40
Weighted Average					2.06	94.4	146.2	28.1	40.1	56.6	*n 58.9	*n 43.5

*n: The aggregation method is "Weighted Average using all components"

*c: Using Capabilities Class Dominant Condition Aggregation Method