

# Soils Map

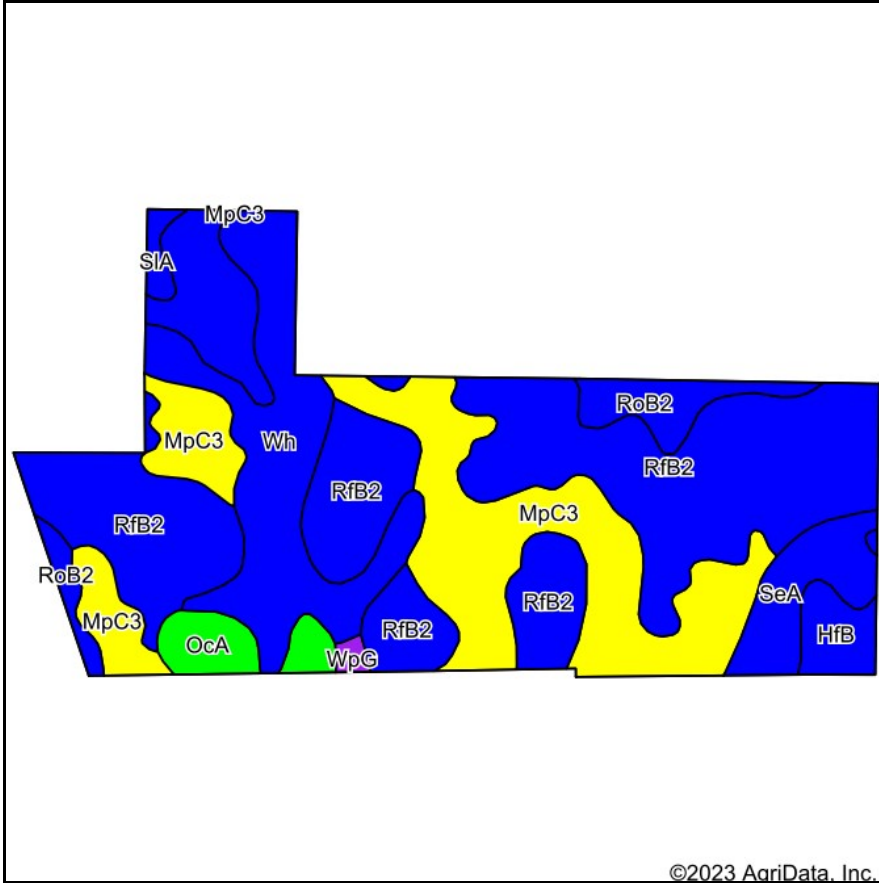

Soils data provided by USDA and NRCS.

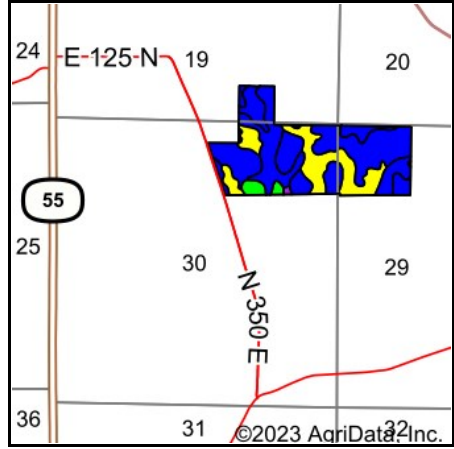

State: **Indiana**  
 County: **Warren**  
 Location: **30-22N-7W**  
 Township: **Warren**  
 Acres: **117.3**  
 Date: **11/30/2023**



Maps Provided By:



© AgriData, Inc. 2023

www.AgriDataInc.com



Area Symbol: IN171, Soil Area Version: 26

Code	Soil Description	Acres	Percent of field	Non-Irr Class Legend	Non-Irr Class *c	Corn Bu	Soybeans Bu	*n NCCPI Corn	*n NCCPI Soybeans
RfB2	Rainsville-Williamstown-Rockfield silt loams, 2 to 6 percent slopes, eroded	54.32	46.3%		lle	133	47	76	58
MpC3	Miami clay loam, 6 to 12 percent slopes, severely eroded	27.61	23.5%		IVe	126	44	55	35
Wh	Washtenaw silt loam	17.55	15.0%		llw	165	49	60	84
SeA	Shadeland variant silt loam, 0 to 2 percent slopes	5.38	4.6%		llw	102	32	75	61
RoB2	Rockfield silt loam, 2 to 6 percent slopes, eroded	4.74	4.0%		lle	141	50	85	65
OcA	Ockley silt loam, 0 to 2 percent slopes	3.58	3.1%		le	134	47	84	73
HfB	High Gap silt loam, 2 to 9 percent slopes, stony	2.77	2.4%		lle	102	36	67	55
SIA	Starks silt loam, till substratum, 0 to 2 percent slopes	0.90	0.8%		llw	160	52	93	79
WpG	Weikert Variant fine sandy loam, 35 to 80 percent slopes, very bouldery	0.45	0.4%		Vlle			14	5
<b>Weighted Average</b>					<b>2.46</b>	<b>134</b>	<b>45.6</b>	<b>*n 68.9</b>	<b>*n 57.2</b>

\*n: The aggregation method is "Weighted Average using all components"

\*c: Using Capabilities Class Dominant Condition Aggregation Method