

Soils Map

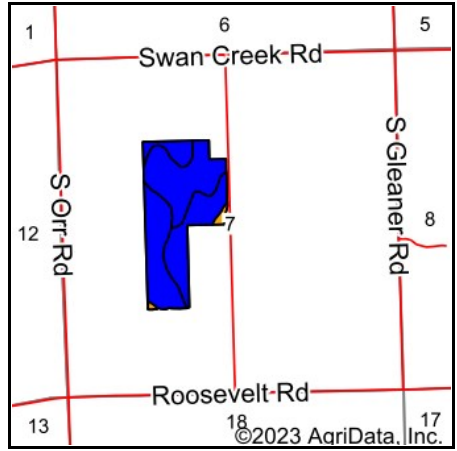

State: **Michigan**
 County: **Saginaw**
 Location: **7-11N-3E**
 Township: **Swan Creek**
 Acres: **55.7**
 Date: **4/27/2023**

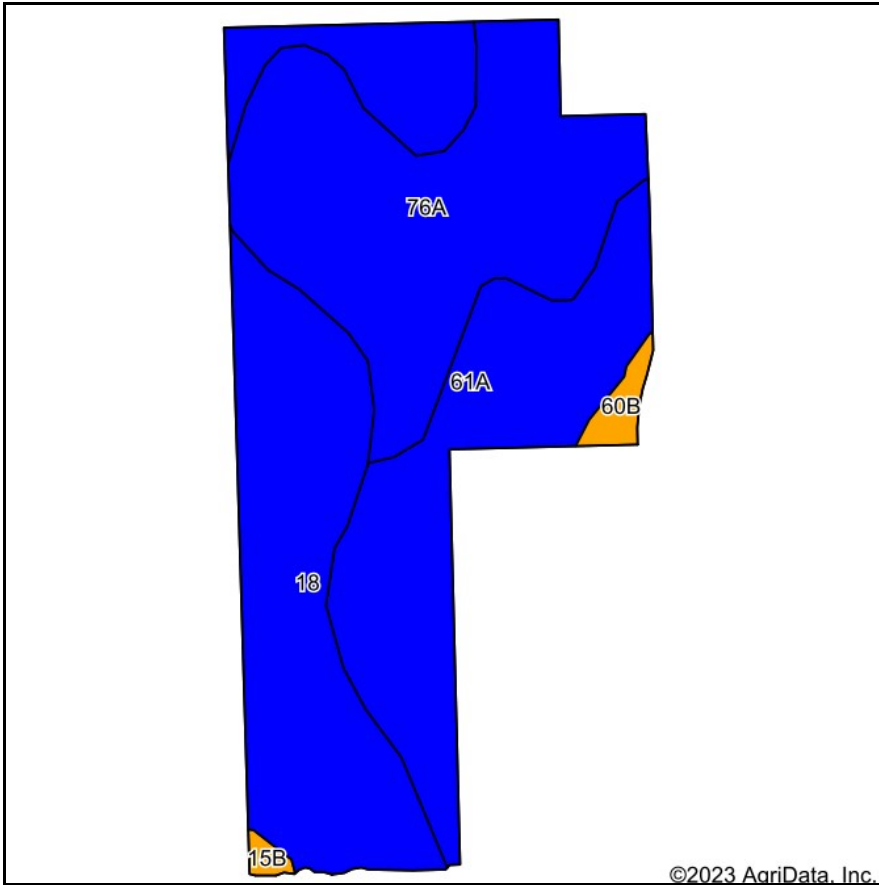

Maps Provided By:



Soils data provided by USDA and NRCS.

©2023 AgriData, Inc.

© AgriData, Inc. 2023

www.AgriDataInc.com

Archived Soils Ending 12/19/2016 Area Symbol: MI145, Soil Area Version: 14

Code	Soil Description	Acres	Percent of field	Non-Irr Class Legend	Non-Irr Class *c	Alfalfa hay Tons	Corn Bu	Corn Irrigated Bu	Corn silage Tons	Corn silage Irrigated Tons	Legume hay Tons	Oats Bu	Soybeans Bu	Sugar beets Tons	Winter wheat Bu
18	Lenawee silty clay loam, 0 to 1 percent slopes	20.11	36.1%		IIw		120				4.7	84	39.9	19.8	45
76A	Londo loam, 0 to 3 percent slopes	20.01	35.9%		IIw	5	130		20			105	40	20	65
61A	Tappan-Poseyville complex, 0 to 3 percent slopes	14.51	26.1%		IIw	5.5	140		22			115	45	23	65
60B	Arkona sand, 0 to 4 percent slopes	0.77	1.4%		IIIw	4.2	110	150	18	27		85	35		45
15B	Wixom sand, 0 to 4 percent slopes	0.30	0.5%		IIIw	4.2	110		18			85	35		45
Weighted Average					2.02	3.3	128.6	2.1	13.3	0.4	1.7	99.6	41.2	20.3	57.4

*c: Using Capabilities Class Dominant Condition Aggregation Method

Soils data provided by USDA and NRCS.