

Soils Map

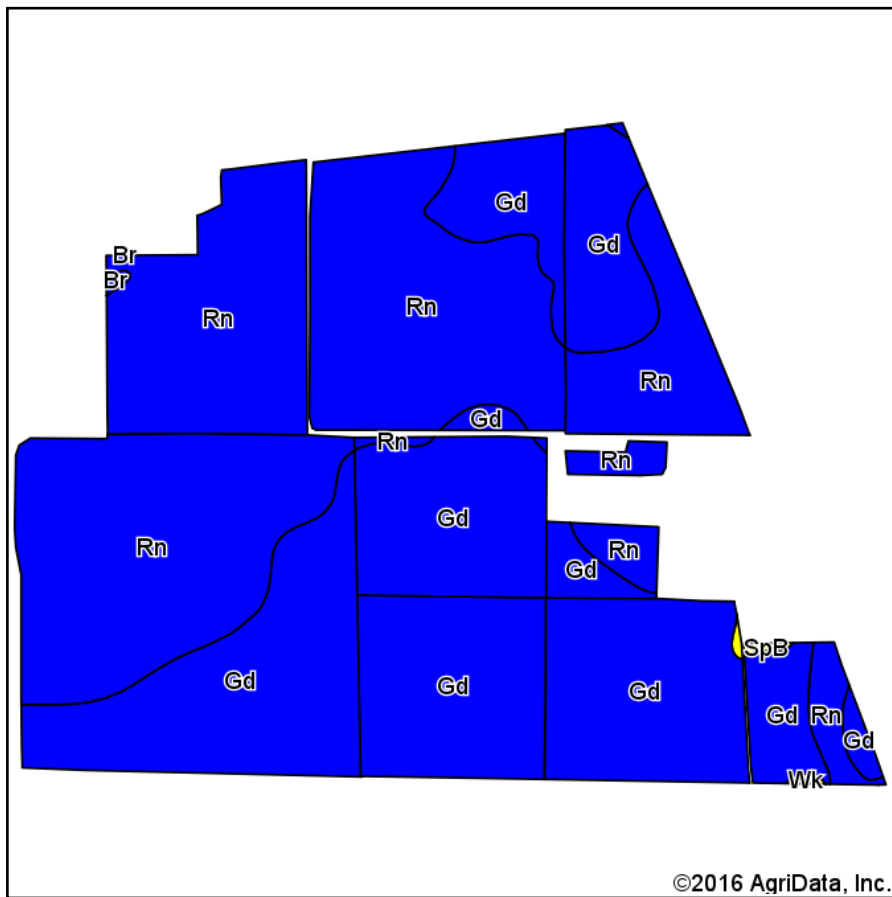

Soils data provided by USDA and NRCS.

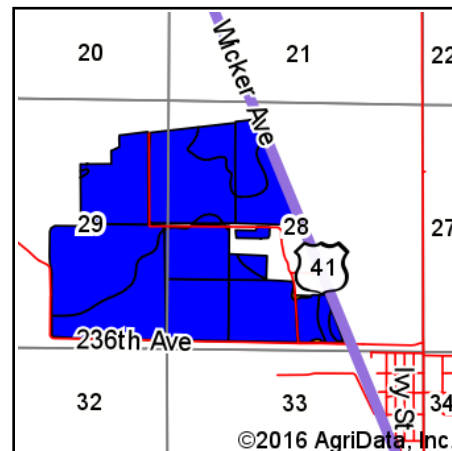

State: **Indiana**
 County: **Lake**
 Location: **28-32N-9W**
 Township: **West Creek**
 Acres: **462.93**
 Date: **1/13/2017**

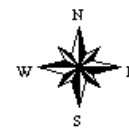

Area Symbol: IN089, Soil Area Version: 19

Code	Soil Description	Acres	Percent of field	Non-Irr Class Legend	Water Table	Soil Drainage	Non-Irr Class *c	Soybeans	Corn	Winter wheat
Rn	Rensselaer loam, sandy substratum	233.12	50.4%		0.5ft.	Poorly drained	IIw	49	175	70
Gd	Gilford fine sandy loam, 0 to 1 percent slopes	228.27	49.3%		0.2ft.	Poorly drained	IIw	42	148	60
SpB	Sparta fine sand, 0 to 4 percent slopes	0.79	0.2%		> 6.5ft.	Excessively drained	IVs	27	87	40
Br	Brady fine sandy loam	0.41	0.1%		1.2ft.	Somewhat poorly drained	IIw	34	121	54
Wk	Watseka loamy fine sand	0.34	0.1%		1.2ft.	Somewhat poorly drained	IIIs	27	105	47
Weighted Average								45.5	161.4	65

Area Symbol: IN089, Soil Area Version: 19

*c: Using Capabilities Class Dominant Condition Aggregation Method

Soils data provided by USDA and NRCS.