

Soils Map

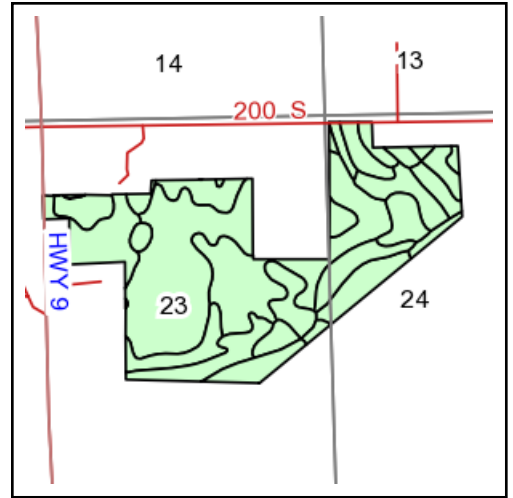

State: **Indiana**
 County: **Whitley**
 Location: **23-31N-9E**
 Township: **Columbia**
 Acres: **109.24**
 Date: **9/5/2013**

Field borders provided by Farm Service Agency as of 5/21/2008.
 Soils data provided by USDA and NRCS.

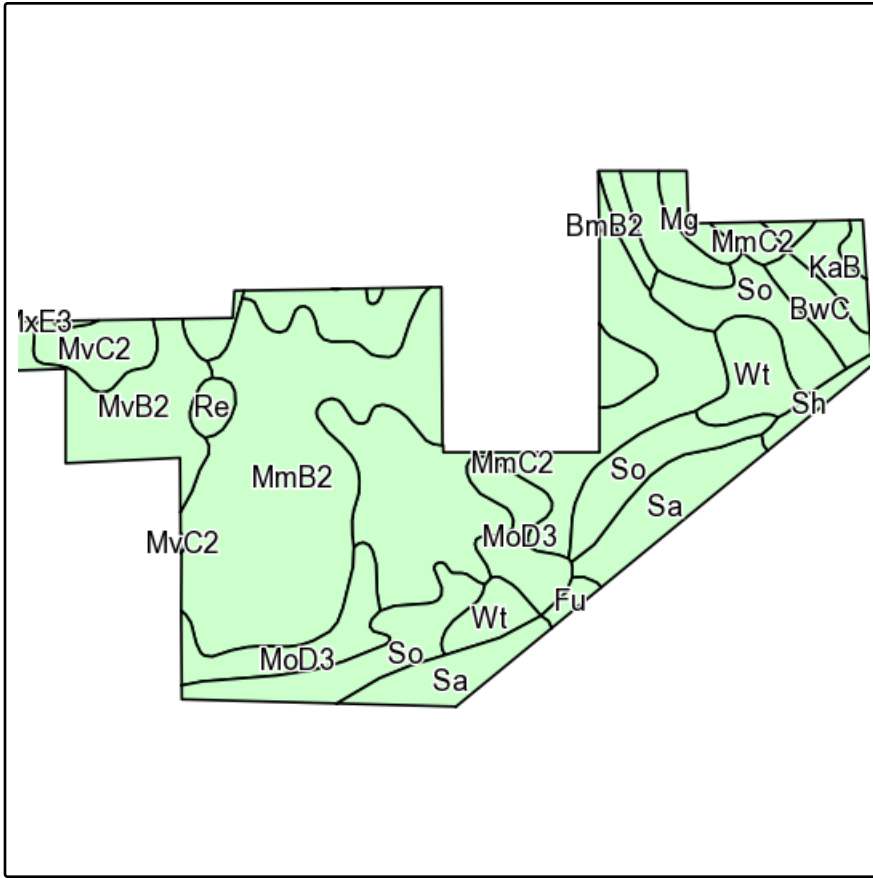

Maps provided by:



Code	Soil Description	Acres	Percent of field	Non-Irr Class	Irr Class	Corn	Soybeans	Winter wheat
MmB2	Miami sandy loam, 2 to 6 percent slopes, eroded	27.93	25.6%	Ile		135	47	61
MmC2	Miami sandy loam, 6 to 12 percent slopes, eroded	23.37	21.4%	IIle		125	44	56
So	Sloan loam, sandy substratum, frequently flooded	13.66	12.5%	IIIw		150	40	
Sa	Saranac silty clay loam, sandy substratum, frequently flooded	7.84	7.2%	Vw				
MoD3	Miami clay loam, 12 to 20 percent slopes, severely eroded	7.73	7.1%	VIe		110	39	50
MvB2	Morley loam, 3 to 6 percent slopes, eroded	7.24	6.6%	Ile		125	44	56
Wt	Whitaker loam	5.15	4.7%	IIw		154	51	70
MvC2	Morley loam, 6 to 12 percent slopes, eroded	3.92	3.6%	IIIe		115	40	52
BwC	Boyer sandy loam, 6 to 12 percent slopes	2.62	2.4%	IIIe		90	32	45
Wc	Walkkill Variant silty clay loam, coprogenous earth substratum	2.54	2.3%	IIIw		165	49	66
KaB	Kalamazoo sandy loam, 2 to 6 percent slopes	1.88	1.7%	Ile	II	130	46	65
Mg	Mermill loam	1.39	1.3%	IIw		170	49	68
Pw	Pewamo silty clay loam	1.17	1.1%	IIw		160	44	64
Sh	Shoals silt loam, sandy substratum, frequently flooded	1.03	0.9%	IIIw		130	42	
Re	Rensselaer loam	0.94	0.9%	IIw		172	48	69
Fu	Fulton silty clay loam	0.56	0.5%	IIIw		135	44	61
BmB2	Blount silt loam, 1 to 4 percent slopes, eroded	0.27	0.2%	Ile		135	44	61
Weighted Average						123.3	40.9	46.3