

Soils Map

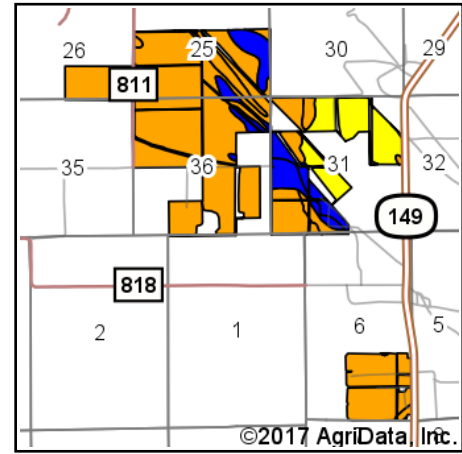

State: **Arkansas**
 County: **Cross**
 Location: **36-7N-5E**
 Township: **Tyronza**
 Acres: **1283.5**
 Date: **6/2/2017**

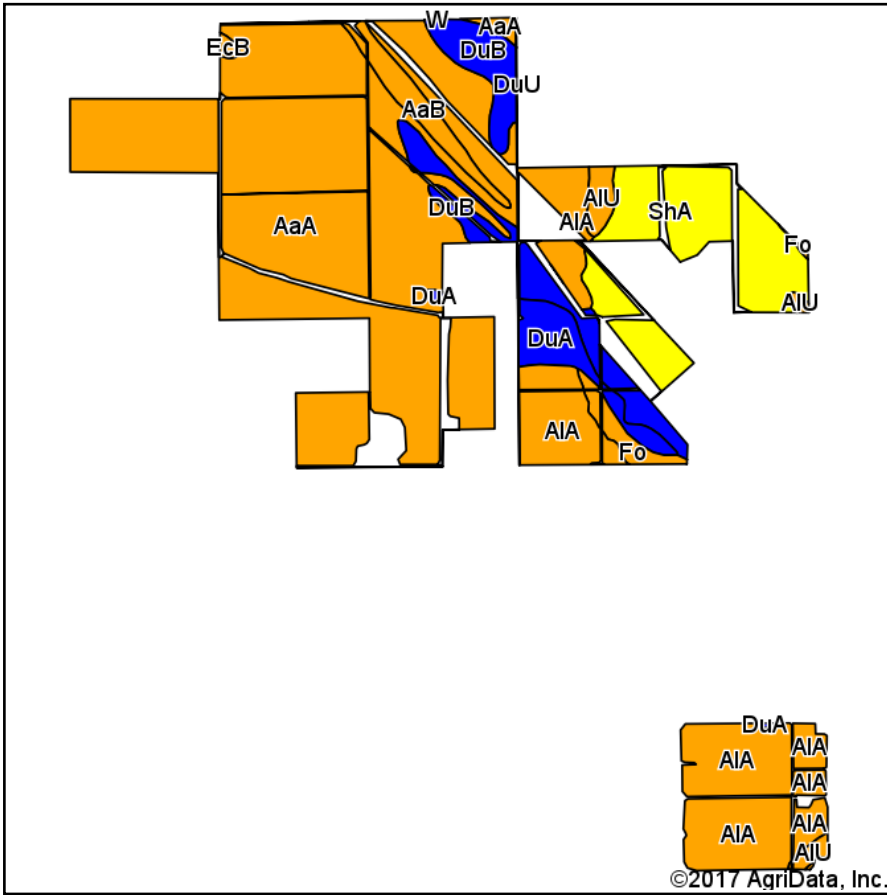

Area Symbol: AR035, Soil Area Version: 15
 Area Symbol: AR037, Soil Area Version: 16

Code	Soil Description	Acres	Percent of field	Non-Irr Class Legend	Water Table	Restrictive Layer	Soil Drainage	Non-Irr Class *c	Corn	Cotton lint	Rice Irrigated	Soybeans	Wheat Irrigated	Wheat
AaA	Alligator clay, 0 to 1 percent slopes, rarely flooded, west	697.01	54.3%		0ft.	> 6.5ft.	Poorly drained	IIIw		600	130	35	45	
AIA	Alligator silty clay, 0 to 1 percent slopes	230.53	18.0%		0.8ft.	> 6.5ft.	Poorly drained	IIIw		600	130	35	45	
ShA	Sharkey silty clay, 0 to 1 percent slopes, protected	147.89	11.5%		0ft.	> 6.5ft.	Poorly drained	IVw		650	130	40		45
DuB	Dundee silt loam, gently undulating	61.49	4.8%		2.5ft.	> 6.5ft.	Somewhat poorly drained	IIw	80	750		35		
DuA	Dundee silt loam, 0 to 1 percent slopes	39.26	3.1%		2ft.	> 6.5ft.	Somewhat poorly drained	IIw	85	750		40		45
DuU	Dundee silt loam, gently undulating	38.26	3.0%		2.5ft.	> 6.5ft.	Somewhat poorly drained	IIw	85	750		40		45
AaB	Alligator clay, gently undulating	30.14	2.3%		0.8ft.	> 6.5ft.	Poorly drained	IIIw		600	130	35	45	
AIU	Alligator silty clay, gently undulating	18.48	1.4%		0.8ft.	> 6.5ft.	Poorly drained	IIIw		600	130	35	45	
Fo	Forestdale silty clay loam	16.48	1.3%		1ft.	> 6.5ft.	Poorly drained	IIIw	50	600	130	35		40
EcB	Earle clay, gently undulating	2.48	0.2%		0.5ft.	> 6.5ft.	Poorly drained	IIIw	50	650		35		40
DuA	Dundee silt loam, 0 to 1 percent slopes	1.48	0.1%		2.5ft.	> 6.5ft.	Somewhat poorly drained	IIw	85	750		40		45
Weighted Average									9.8	622.3	115.5	35.9	34.2	8.5

*c: Using Capabilities Class Dominant Condition Aggregation Method

Soils data provided by USDA and NRCS.

Soils Map

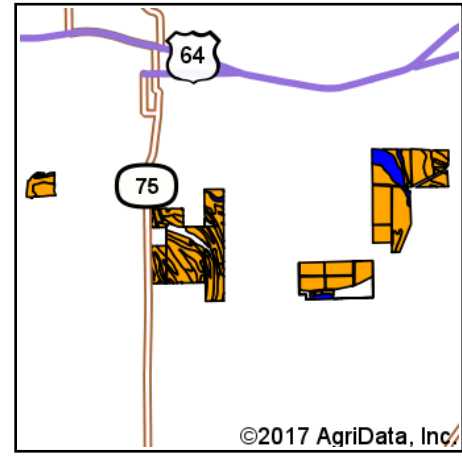
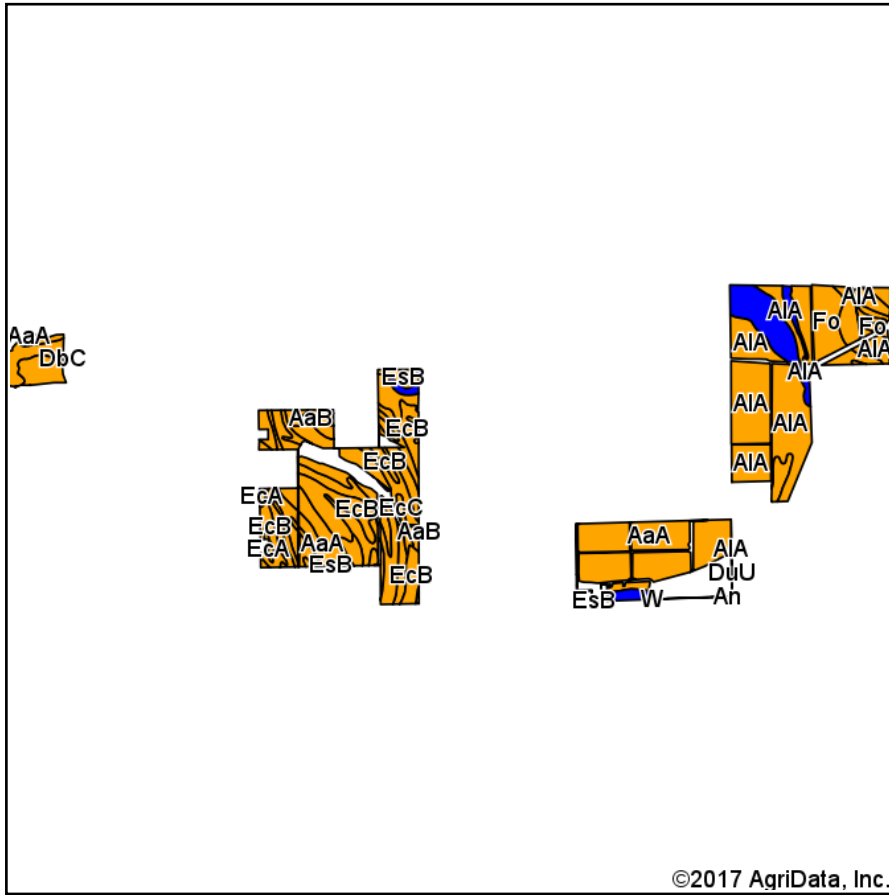

State: **Arkansas**
 County: **Cross**
 Location: **14-7N-5E**
 Township: **Tyronza**
 Acres: **1424.37**
 Date: **6/2/2017**



Maps Provided By:



© AgriData, Inc. 2017

www.AgrIDataInc.com



Soils data provided by USDA and NRCS.

©2017 AgriData, Inc.

Area Symbol: AR035, Soil Area Version: 15

Area Symbol: AR037, Soil Area Version: 16

Code	Soil Description	Acres	Percent of field	Non-Irr Class Legend	Water Table	Restrictive Layer	Soil Drainage	Non-Irr Class *c	Corn	Cotton lint	Rice Irrigated	Soybeans	Wheat	Wheat Irrigated
AaA	Alligator clay, 0 to 1 percent slopes, rarely flooded, west	464.62	32.6%		0ft.	> 6.5ft.	Poorly drained	IIIw		600	130	35		45
AIA	Alligator silty clay, 0 to 1 percent slopes	336.58	23.6%		0.8ft.	> 6.5ft.	Poorly drained	IIIw		600	130	35		45
EcB	Earle clay, gently undulating	266.40	18.7%		0.5ft.	> 6.5ft.	Poorly drained	IIIw	50	650		35	40	
Fo	Forestdale silty clay loam	105.63	7.4%		1ft.	> 6.5ft.	Poorly drained	IIIw	50	600	130	35	40	
DuA	Dundee silt loam, 0 to 1 percent slopes	86.29	6.1%		2ft.	> 6.5ft.	Somewhat poorly drained	IIw	85	750		40	45	
EsB	Earle silty clay loam, gently undulating	63.84	4.5%		0.5ft.	> 6.5ft.	Poorly drained	IIIw	50	650		35	40	
AaB	Alligator clay, gently undulating	35.70	2.5%		0.8ft.	> 6.5ft.	Poorly drained	IIIw		600	130	35		45
EcC	Earle clay, undulating	25.92	1.8%		0.5ft.	> 6.5ft.	Poorly drained	IIIw	50	650		35	40	
AIU	Alligator silty clay, gently undulating	15.18	1.1%		0.8ft.	> 6.5ft.	Poorly drained	IIIw		600	130	35		45
DuB	Dundee silt loam, gently undulating	10.87	0.8%		2.5ft.	> 6.5ft.	Somewhat poorly drained	IIw	80	750		35		
DbB	Dubbs fine sandy loam, 0 to 3 percent slopes	6.40	0.4%		> 6.5ft.	> 6.5ft.	Well drained	IIe	85	800		35	45	
EcA	Earle clay, 0 to 1 percent slopes	6.30	0.4%		0.5ft.	> 6.5ft.	Poorly drained	IIIw	55	700		35	45	



DuA	Dundee silt loam, 0 to 1 percent slopes	0.35	0.0%		2.5ft.	> 6.5ft.	Somewhat poorly drained	Ilw	85	750		40	45	
DbC	Dubbs fine sandy loam, undulating	0.20	0.0%		> 6.5ft.	> 6.5ft.	Well drained	Ille	80	750		30	40	
W	Water	0.09	0.0%		> 6.5ft.	> 6.5ft.								
Weighted Average									22.6	624.1	87.4	35.3	16.1	26.9

*c: Using Capabilities Class Dominant Condition Aggregation Method

Soils data provided by USDA and NRCS.

Soils Map

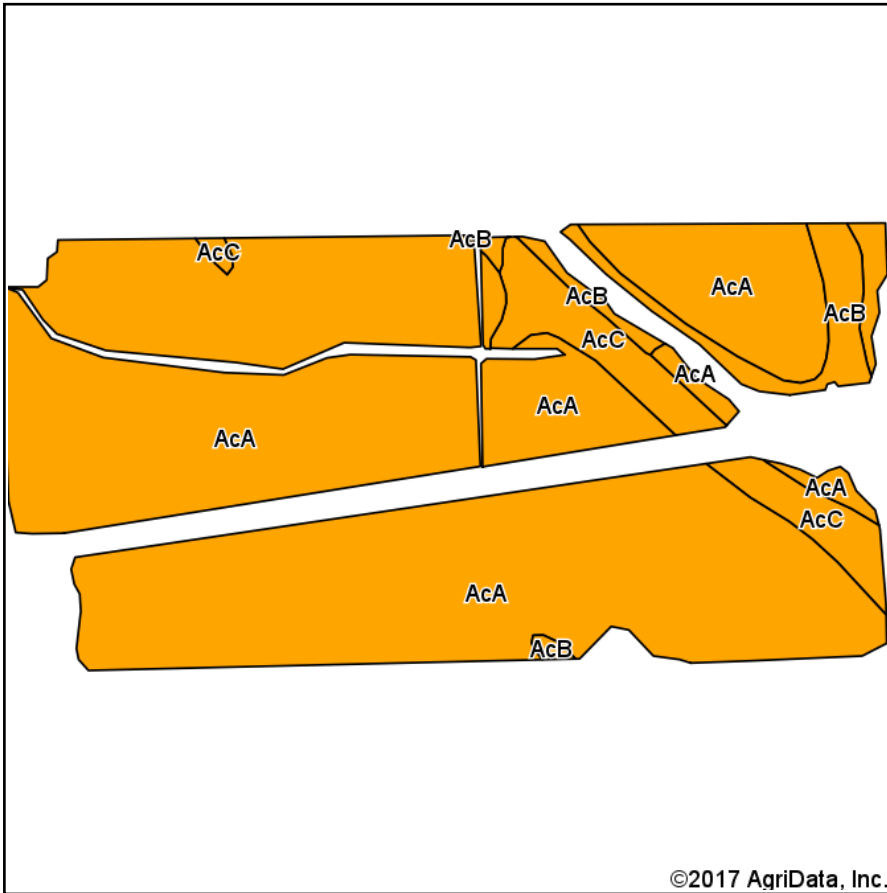

Soils data provided by USDA and NRCS.

©2017 AgriData, Inc.

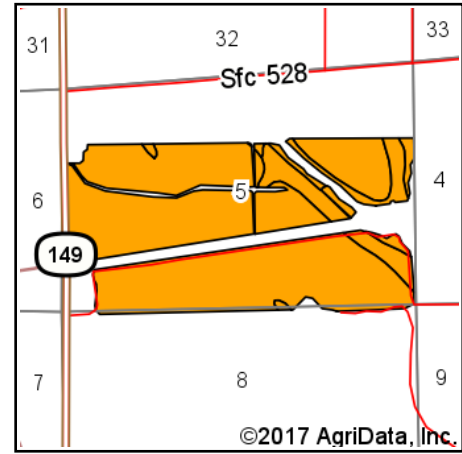

State: **Arkansas**
 County: **St Francis**
 Location: **5-5N-6E**
 Township: **Heth**
 Acres: **255.67**
 Date: **6/2/2017**



Maps Provided By:



© AgriData, Inc. 2017

www.AgriDataInc.com



Area Symbol: AR123, Soil Area Version: 14

Code	Soil Description	Acres	Percent of field	Non-Irr Class Legend	Water Table	Restrictive Layer	Soil Drainage	Non-Irr Class *c	Cotton lint	Rice Irrigated	Soybeans	Wheat Irrigated
AcA	Alligator and Sharkey clays, 0 to 1 percent slopes	226.89	88.7%		0.5ft.	> 6.5ft.	Poorly drained	IIIw	600	130	35	45
AcC	Alligator and Sharkey clays, undulating	17.68	6.9%		0.5ft.	> 6.5ft.	Poorly drained	IIIe	550		30	40
AcB	Alligator and Sharkey clays, gently undulating	11.10	4.3%		0.5ft.	> 6.5ft.	Poorly drained	IIIw	600	130	35	45
Weighted Average									596.5	121	34.7	44.7

*c: Using Capabilities Class Dominant Condition Aggregation Method

Soils data provided by USDA and NRCS.

Soils Map

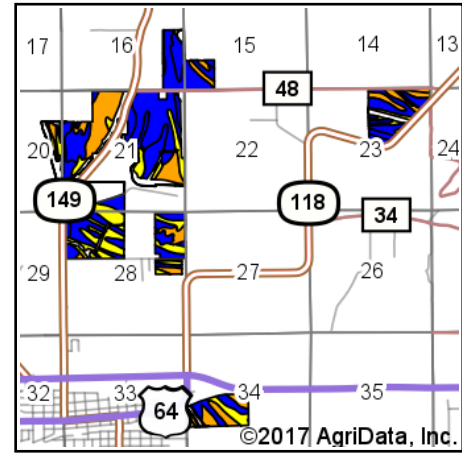
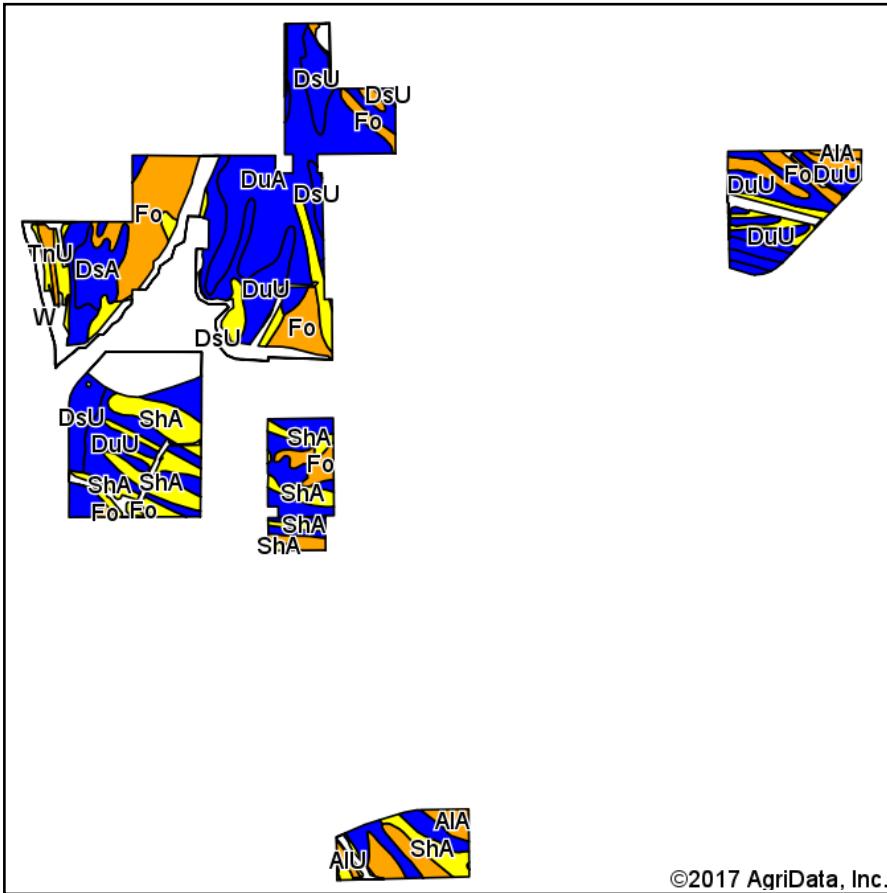

State: **Arkansas**
 County: **Crittenden**
 Location: **27-8N-6E**
 Township: **Tyronza**
 Acres: **816**
 Date: **4/11/2017**



Area Symbol: AR035, Soil Area Version: 15

Code	Soil Description	Acres	Percent of field	Non-Irr Class Legend	Water Table	Soil Drainage	Non-Irr Class *c	Corn	Cotton lint	Oats	Rice Irrigated	Soybeans	Wheat	Wheat Irrigated
DuU	Dundee silt loam, gently undulating	191.31	23.4%		2.5ft.	Somewhat poorly drained	IIw	85	750			40	45	
ShA	Sharkey silty clay, 0 to 1 percent slopes, protected	161.63	19.8%		0ft.	Poorly drained	IVw		650		130	40	45	
DuA	Dundee silt loam, 0 to 1 percent slopes	157.93	19.4%		2ft.	Somewhat poorly drained	IIw	85	750			40	45	
Fo	Forestdale silty clay loam	130.07	15.9%		1ft.	Poorly drained	IIIw	50	600		130	35	40	
DsU	Dubbs silt loam, 0 to 3 percent slopes	101.82	12.5%		> 6.5ft.	Well drained	Ile	85	850			35	50	
DsA	Dubbs silt loam, 0 to 1 percent slopes	26.81	3.3%		> 6.5ft.	Well drained	Ile	90	850			39	50	
AIA	Alligator silty clay, 0 to 1 percent slopes	26.65	3.3%		0.8ft.	Poorly drained	IIIw		600		130	35		45
AIU	Alligator silty clay, gently undulating	13.58	1.7%		0.8ft.	Poorly drained	IIIw		600		130	35		45
TnU	Tunica clay, gently undulating	5.86	0.7%		1ft.	Poorly drained	IIIw		625	55		35	40	
W	Water	0.34	0.0%		> 6.5ft.									
Weighted Average								57.9	713.4	0.4	52.9	38.2	42.7	2.2

*c: Using Capabilities Class Dominant Condition Aggregation Method

Soils data provided by USDA and NRCS.