

# Soils Map

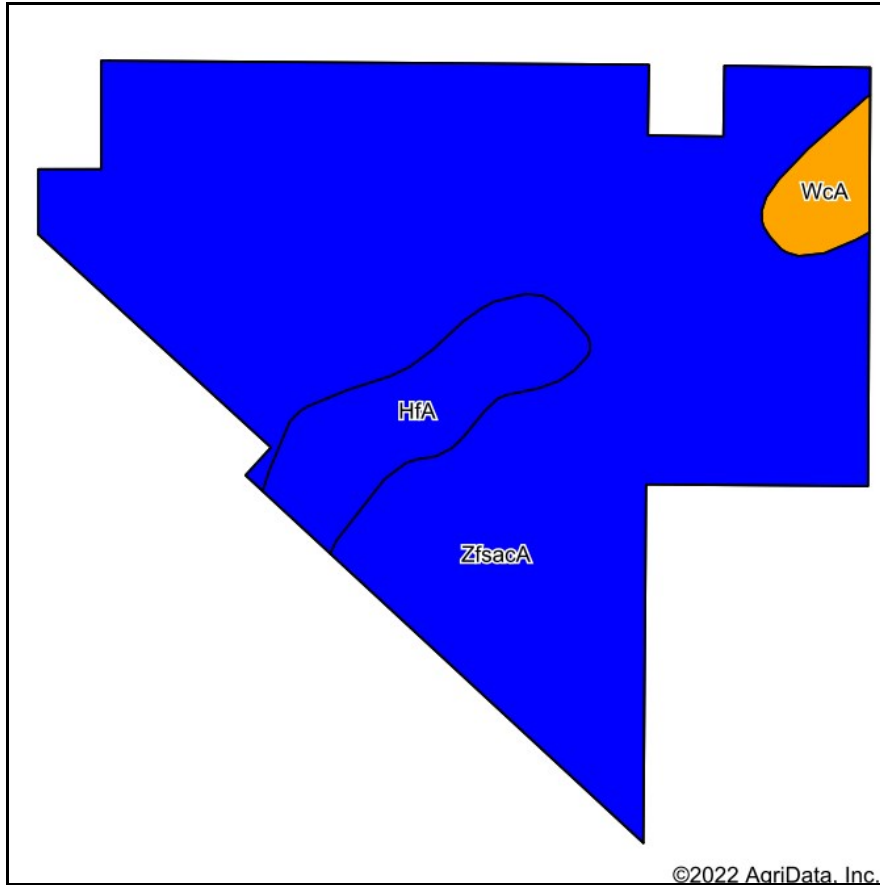

Soils data provided by USDA and NRCS.

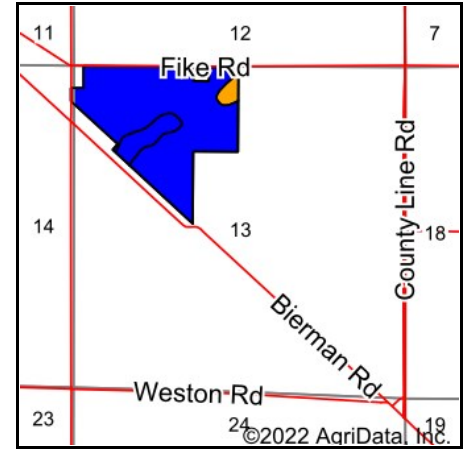

State: **Michigan**  
 County: **Lenawee**  
 Location: **13-8S-5E**  
 Township: **Riga**  
 Acres: **87.18**  
 Date: **8/22/2022**



Maps Provided By:



Area Symbol: MI091, Soil Area Version: 17

Code	Soil Description	Acres	Percent of field	Non-Irr Class Legend	Non-Irr Class *c	Corn Bu	Oats Bu	Orchardgrass AUM	Orchardgrass hay Tons	Orchardgrass alfalfa hay Tons	Soybeans Bu	Sugar beets Tons	Tomatoes Tons	Winter wheat Bu	*n So
ZfsacA	Ziegenfuss clay loam, 0 to 1 percent slopes	77.04	88.4%		IIw										
HfA	Hoytville and Wauseon loams, 0 to 3 percent slopes	7.57	8.7%		IIw	130		7.4		5.4	46	24	29	52	
WcA	Wauseon loam, 0 to 3 percent slopes	2.57	2.9%		IIIw	100	70		4		40	19.5	25	40	
<b>Weighted Average</b>					<b>2.03</b>	<b>14.2</b>	<b>2.1</b>	<b>0.6</b>	<b>0.1</b>	<b>0.5</b>	<b>5.2</b>	<b>2.7</b>	<b>3.3</b>	<b>5.7</b>	

\*n: The aggregation method is "Weighted Average using all components"

\*c: Using Capabilities Class Dominant Condition Aggregation Method