

# Soils Map

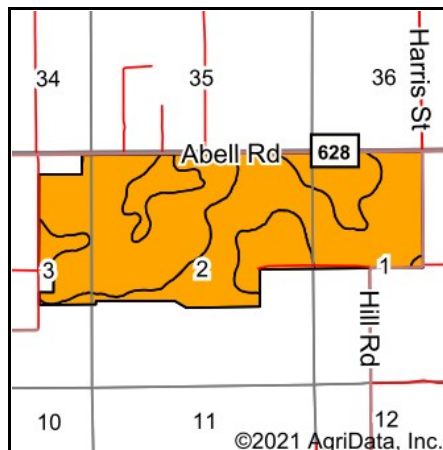

State: **Louisiana**  
 County: **Jeff n Davis**  
 Location: **2-10S-5W**  
 Township: **District 13**  
 Acres: **702.08**  
 Date: **4/9/2021**

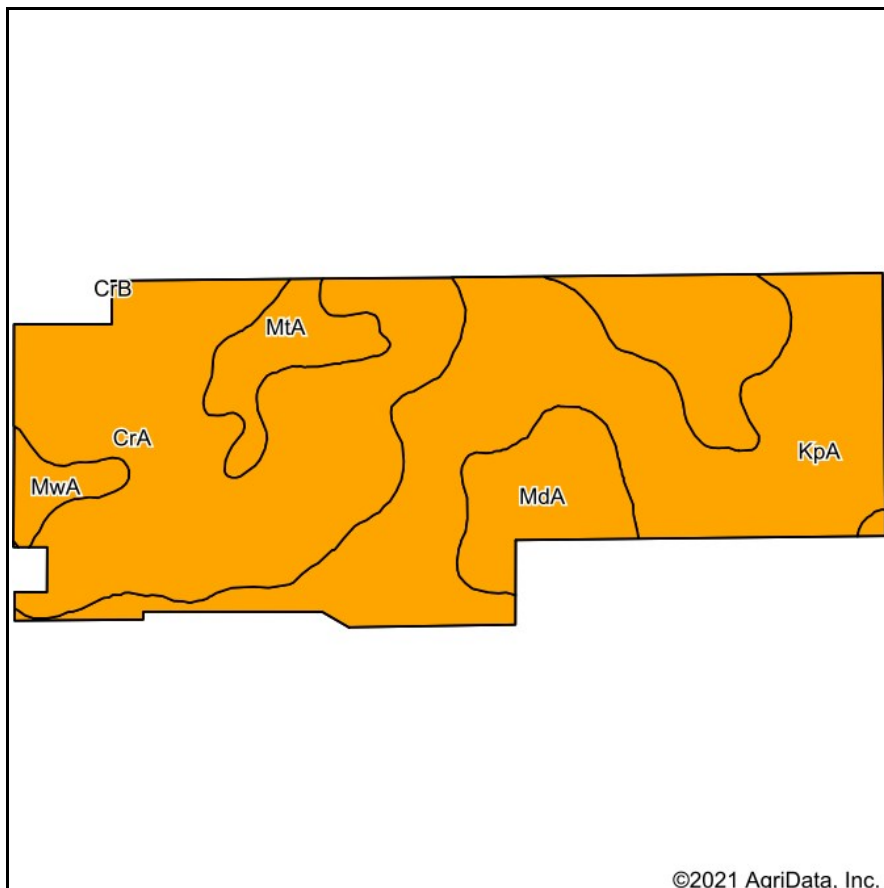

Maps Provided By:

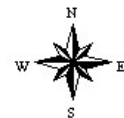

Soils data provided by USDA and NRCS.

©2021 AgriData, Inc.

© AgriData, Inc. 2021

www.AgrIDataInc.com

Area Symbol: LA053, Soil Area Version: 15

Code	Soil Description	Acres	Percent of field	Non-Irr Class Legend	Soil Drainage	Non-Irr Class *c	Corn	Cotton lint	Rice Irrigated	Soybeans
CrA	Crowley-Vidrine complex, 0 to 1 percent slopes	319.65	45.5%		Somewhat poorly drained	IIIw	49	428	119	27
KpA	Kaplan silt loam, 0 to 1 percent slopes	273.03	38.9%		Somewhat poorly drained	IIIw	4	23	112	30
MdA	Midland silty clay loam, 0 to 1 percent slopes, rarely flooded	56.45	8.0%		Poorly drained	IIIw	70	435	111	28
MtA	Mowata silt loam, 0 to 1 percent slopes, rarely flooded	36.42	5.2%		Poorly drained	IIIw	4	453	115	29
MwA	Mowata-Vidrine complex, 0 to 1 percent slopes, rarely flooded	16.45	2.3%		Poorly drained	IIIw	3	452	114	27
CrB	Crowley-Vidrine complex, 1 to 3 percent slopes	0.08	0.0%		Somewhat poorly drained	IIIw	47	428	119	27
<b>Weighted Average</b>							<b>29.8</b>	<b>272.9</b>	<b>115.3</b>	<b>28.4</b>

\*c: Using Capabilities Class Dominant Condition Aggregation Method