

Soils Map

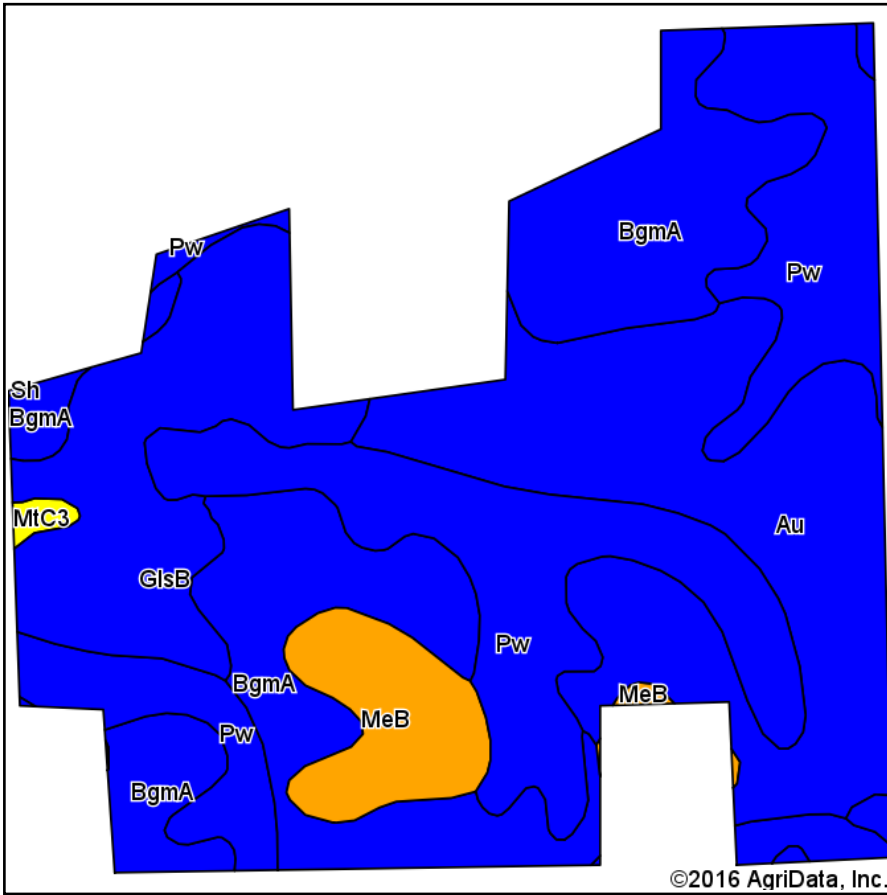

Soils data provided by USDA and NRCS.

©2016 AgriData, Inc.

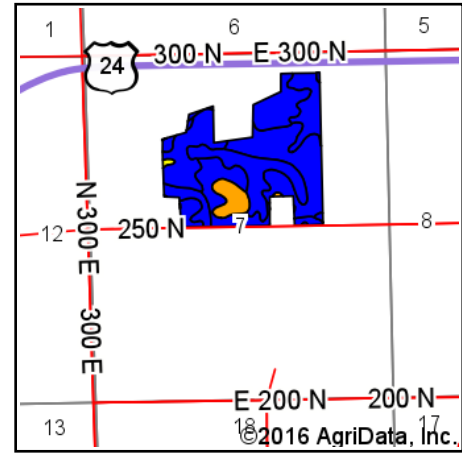

State: **Indiana**
 County: **Miami**
 Location: **7-27N-5E**
 Township: **Erie**
 Acres: **91.7**
 Date: **9/8/2016**



Area Symbol: IN103, Soil Area Version: 19

Code	Soil Description	Acres	Percent of field	Non-Irr Class Legend	Water Table	Soil Drainage	Non-Irr Class *c	Corn	Soybeans	Winter wheat
Pw	Pewamo silty clay loam, 0 to 1 percent slopes	26.72	29.1%		0.5ft.	Very poorly drained	IIw	157	47	64
BgmA	Blount silt loam, ground moraine, 0 to 2 percent slopes	24.10	26.3%		0.7ft.	Somewhat poorly drained	IIw	141	45	63
Au	Aubbeenaubee sandy loam, 0 to 2 percent slopes	22.80	24.9%		1.2ft.	Somewhat poorly drained	IIw	135	44	61
GlsB	Glynwood silt loam, ground moraine, 2 to 6 percent slopes	12.36	13.5%		1.5ft.	Moderately well drained	IIe	132	46	59
MeB	Metea loamy fine sand, 2 to 6 percent slopes	5.35	5.8%		> 6.5ft.	Well drained	IIIe	110	39	55
MtC3	Morley silty clay loam, 6 to 12 percent slopes, severely eroded	0.37	0.4%		2.5ft.	Moderately well drained	IVe	105	37	47
Weighted Average								141	45.1	61.7

Area Symbol: IN103, Soil Area Version: 19

*c: Using Capabilities Class Dominant Condition Aggregation Method

Soils data provided by USDA and NRCS.

Soils Map

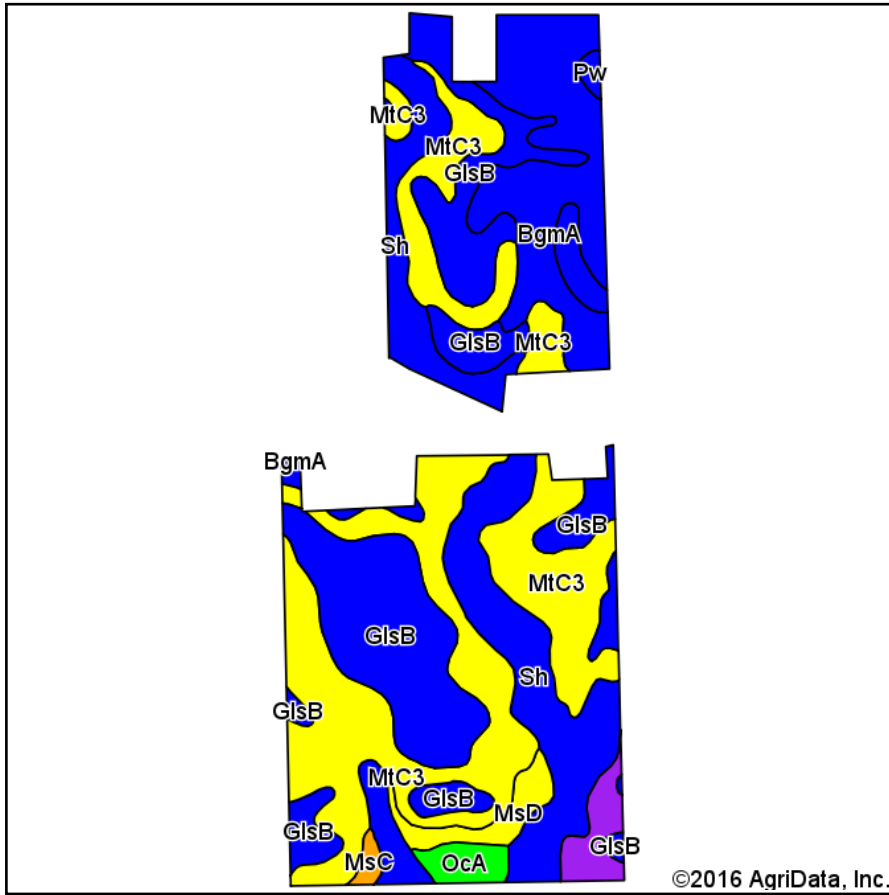

Soils data provided by USDA and NRCS.

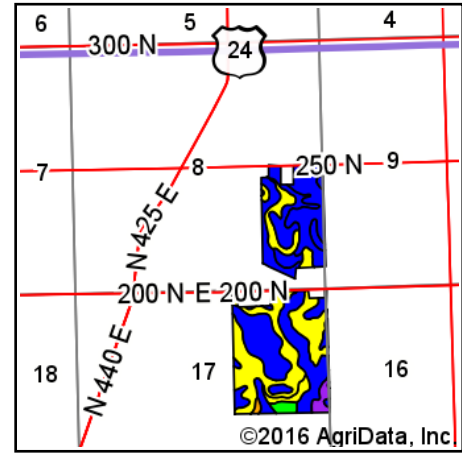

State: **Indiana**
 County: **Miami**
 Location: **8-27N-5E**
 Township: **Erie**
 Acres: **179.52**
 Date: **9/8/2016**



Area Symbol: IN103, Soil Area Version: 19

Code	Soil Description	Acres	Percent of field	Non-Irr Class Legend	Water Table	Soil Drainage	Non-Irr Class *c	Corn	Soybeans	Winter wheat
MtC3	Morley silty clay loam, 6 to 12 percent slopes, severely eroded	59.81	33.3%		2.5ft.	Moderately well drained	IVe	105	37	47
GlsB	Glywood silt loam, ground moraine, 2 to 6 percent slopes	49.58	27.6%		1.5ft.	Moderately well drained	Ile	132	46	59
Sh	Shoals silt loam, 0 to 2 percent slopes, occasionally flooded	34.27	19.1%		1ft.	Somewhat poorly drained	IIw	131	38	
BgmA	Blount silt loam, ground moraine, 0 to 2 percent slopes	23.75	13.2%		0.7ft.	Somewhat poorly drained	IIw	141	45	63
MsD	Morley silt loam, 12 to 18 percent slopes	4.00	2.2%		2.5ft.	Moderately well drained	IVe	105	37	47
HeG	Hennepin silt loam, 25 to 50 percent slopes	3.83	2.1%		> 6.5ft.	Well drained	VIIe	85	30	43
Oca	Ockley silt loam, 0 to 2 percent slopes	2.76	1.5%		> 6.5ft.	Well drained	Ie	134	47	67
MsC	Morley silt loam, 6 to 12 percent slopes	0.86	0.5%		2.7ft.	Moderately well drained	IIIe	120	42	54
Pw	Pewamo silty clay loam, 0 to 1 percent slopes	0.66	0.4%		0.5ft.	Very poorly drained	IIw	157	47	64
Weighted Average								122.5	40.8	43.8

Area Symbol: IN103, Soil Area Version: 19

*c: Using Capabilities Class Dominant Condition Aggregation Method

Soils data provided by USDA and NRCS.