

Soils Map

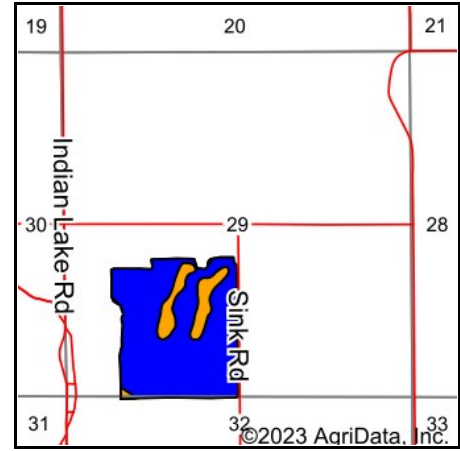

State: **Michigan**
 County: **Cass**
 Location: **29-5S-16W**
 Township: **Silver Creek**
 Acres: **84.47**
 Date: **4/4/2023**

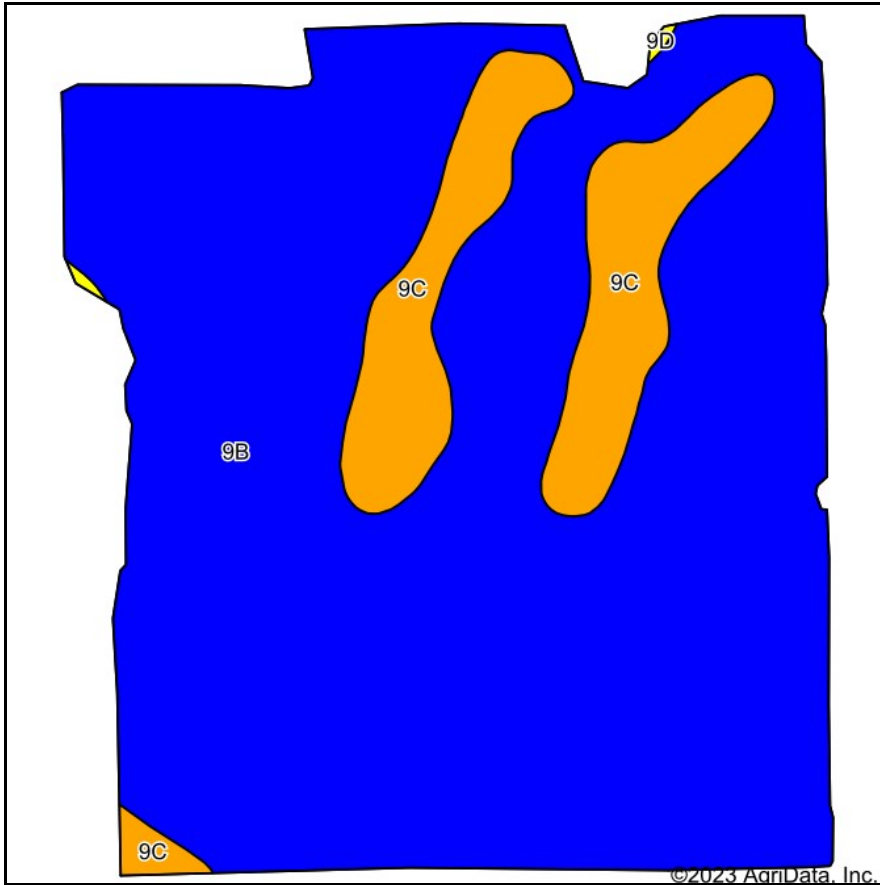

Maps Provided By:



Soils data provided by USDA and NRCS.

©2023 AgriData, Inc.

© AgriData, Inc. 2023

www.AgriDataInc.com

Archived Soils Ending 1/21/2012

Code	Soil Description	Acres	Percent of field	Non-Irr Class Legend	Restrictive Layer	Soil Drainage	Non-Irr Class *c	Irr Class *c	Com Bu	Com Irrigated Bu	Soybeans Bu	Soybeans Irrigated Bu	Winter wheat Bu
9B	Kalamazoo loam, 2 to 6 percent slopes	73.80	87.4%		> 6.5ft.	Well drained	Ile	Ile	100	175	30	55	40
9C	Kalamazoo loam, 6 to 12 percent slopes	10.55	12.5%		> 6.5ft.	Well drained	Ile		85		27		38
9D	Kalamazoo loam, 12 to 18 percent slopes	0.12	0.1%		> 6.5ft.	Well drained	Ive		65		24		36
Weighted Average							2.13	*-	98.1	152.9	29.6	48.1	39.7

*c: Using Capabilities Class Dominant Condition Aggregation Method

*- Irr Class weighted average cannot be calculated on the current soils data due to missing data.